

FEATURES & SPECIFICATIONS

INTENDED USE — ES8P provides a high-performance T8 (HPT8) energy-saving alternative to 3-lamp, 18-cell parabolic fixtures. Used in place of parabolics, ES8P can provide 44% energy savings while meeting IESNA recommended illuminance levels.

Designed and configured specifically for K-12 educational facilities. ES8P Class Pack (CPES8P) is designed to deliver recommended classroom lighting levels for instructional and AV activities).

ATTRIBUTES — Designed and optimized for use with CEE (Consortium for Energy Efficiency) qualified, high-lumen T8 lamps and energy-efficient electronic ballasts.

Highly reflective surfaces combine with efficient design to produce up to 86% photometric efficiency and a Luminaire Efficacy Rating (LER) of up to 86 using listed lamps and ballast.

CONSTRUCTION — Robust design, precision-tooling and automated assembly combine to create the industry's strongest louver. Rotary sockets provide for simple lamp insertion and positive engagement into lamp contacts. Mechanical light seal requires no foam gasketing. Integral T-bar clips secure fixture to T-bar system. Housing formed of cold-rolled steel.

Class Pack is packaged specifically for most K-12 facilities. Luminaires are packaged in packs of nine, or 12 fixtures, to reduce material handling and increase the efficiency of installation at the job site. See packaging/wiring table on the following page for details.

Finish: Five-stage iron-phosphate pre-treatment ensures superior paint adhesion and rust resistance. Housing painted after fabrication with environmentally friendly, high gloss, 93% reflectivity polyester powder-coat.

Louver painted after fabrication with low gloss, high reflectivity polyester powder coat.

OPTICS — Mechanical shielding is provided with angled length blades, and linear faceted cross baffles. Contoured housing efficiently directs light downward. Lamp cut-out maximizes shielding even in shallow plenum applications and softens light distribution to deliver a balanced amount of light to both vertical and horizontal surfaces.

ELECTRICAL — Standard ballast is electronic, thermally protected, resetting, Class P, HPF, non-PCB, UL Listed, CSA certified ballast, universal voltage and sound rated A. Luminaire is suitable for damp locations. AWM, TFN or THHN wire used throughout, rated for required temperatures. Ballast disconnect provided standard where required to comply with US and Canadian electrical codes.

When emergency battery packs are specified, battery pack is installed into a single satellite unit per Class Pack.

LISTINGS — Standard: UL; Canada — CSA or cUL.

WARRANTY — Light fixture is guaranteed for one year against mechanical defects in manufacture.

Lamp and ballast system warranty administered by lamp and ballast manufacturers.

US PATENTS: 6,210,025; 6,231,213, additional patents pending.

Note: Specifications subject to change without notice.

Catalog Number
Notes
Type

Class Pack - Premium High-Performance T8 Lighting

CPES8P 2'x4'

2 LAMPS
T8

CLASS PACK

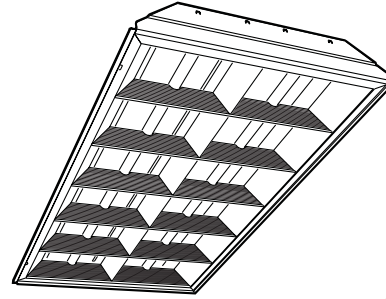

Specifications

Length: 48 (121.8)

Width: 24 (60.9)

Depth: 3-11/16 (9.4)

Weight: 26 lbs (11.7kg)

All dimensions are shown in inches (centimeters) unless otherwise specified.

ORDERING INFORMATION

Lead times will vary depending on options selected. Consult with your sales representative.

Example: CPES8P 2 32 GTHP G841HT8 CP9 PWS1846

CPES8P	2	32			GTHP							
Series	Number of lamps	Wattage	Voltage		Ballast	Lamp		Packaging ¹		Options		
CPES8P	2	32	(blank)	MVOLT (120V-277V)	GTHP	Instant start, step dimming, high efficiency, 1.18 ballast factor (high)	G841HT8	3100 lumen, high CRI, 4100K	CP1	Single, stand-alone unit in an individual carton	GLR	Internal fast-blow fuse ⁴
			120	120V			G835HT8	3100 lumen, high CRI, 3500K	CP9	Nine-pack ²	GMF	Internal slow-blow fuse ⁴
			277	277V			G841E28	28W ES, 2750 lumen, high CRI, 4100K	CP12	12-pack ²	PWS1846	6' prewire, 3/8" diameter, 18-gauge, two circuits
							G835E28	28W ES, 2750 lumen, high CRI, 3500K	LSTS	Single satellite unit, used in CP9 or CP12 ³	EL14	Emergency battery pack (nominal 1400 lumens)
							LPGM741	2800 lumen, 4100K	LSTM3	Single master unit, used in CP9 or CP12 ³	CSA	CSA Certified
							LPGM735	2800 lumen, 3500K				

Accessories: Sensor Switch® control options. Shipped separately.	
WV-PDT	Occupancy sensor.
WV-PDT-P	Occupancy sensor with photocell
CM-PC	Switching photocell
PP-20	Power pack
SP-20	Slave pack

Notes

- 1 Refer to packaging/wiring table on the following page for further detail.
- 2 Multi-pack "CP" packaging is palletized and stretch-wrapped without individual cartons.
- 3 Single satellite and master units are packaged in individual cartons.
- 4 Must specify voltage.

CPES8P 2'x4' Class Pack Premium High-Performance T8 Lighting

DIMENSIONS

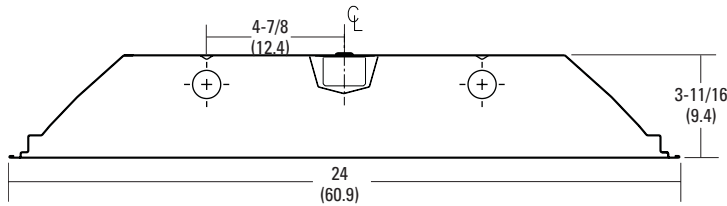

PACKAGING/WIRING

Packaging / Wiring					
Packaging	# Master Fixtures	# Satellite Fixtures	# Stand-alone Fixtures	Instant Start Input watts per Fixture (120/277)	Program Start Input watts per Fixture (120/277)
CP9	3	6	-	75/73	73/72
CP12	4	8	-	75/73	73/72
LSTS	-	1	-	75/73	73/72
LSTM3	1	-	-	75/73	73/72
CP1	-	-	1	75/74	75/74

PHOTOMETRICS

CPES8P 232, 3100 lumens per lamp, test no. LTL 16106

