

## FEATURES & SPECIFICATIONS

**INTENDED USE** — Specification static T8 luminaries designed and configured specifically for K-12 educational facilities. Class Pack is designed to deliver recommended classroom lighting levels for instructional and AV activities. **Certain airborne contaminants can diminish integrity of acrylic.** [Click here for Acrylic Environmental Compatibility table for suitable uses.](#)

**CONSTRUCTION** — Smooth hemmed sides and smooth, inward formed end flanges for easy handling. Lighter weight fixture allows easy installation.

Standard steel door frame has superior structural integrity with premium extruded appearance and precision flush mitered corners. Steel door allows easy lens replacement without frame disassembly (for lenses up to .156" thick). Powder-painted, steel latches provide easy, secure door closure. Superior mechanical light seal requires no foam gasketing. Integral T-bar clips secure fixture to T-bar system. Housing formed from cold-rolled steel. Acrylic shielding material 100% UV stabilized. No asbestos is used in this product.

Class Pack is packaged specifically for most K-12 facilities. Luminaires are packaged in packs of nine or 12 fixtures, to reduce material handling and increase the efficiency of installation at the job site. See packaging/wiring table on the following page for details.

Finish: Five-stage iron-phosphate pre-treatment ensures superior paint adhesion and rust resistance. Housing painted after fabrication with environmentally friendly, high gloss, 93% reflectivity polyester powder-coat.

**OPTICS** — A12 lens (.125" thick) is standard. A19 lens also available.

**ELECTRICAL** — Standard ballast is electronic, thermally protected, resetting, Class P, HPF, non-PCB, UL Listed, CSA certified ballast, universal voltage and sound rated A. Luminaire is suitable for damp locations. AWM, TFN or THHN wire used throughout, rated for required temperatures. Ballast disconnect provided standard where required to comply with US and Canadian electrical codes.

When emergency battery packs are specified, battery pack is installed into a single satellite unit per Class Pack.

**LISTINGS** — Standard: UL, Canada — CSA or cUL.

**WARRANTY** — Guaranteed for one year against mechanical defects in manufacture. Lamp and ballast system warranty administered by lamp and ballast manufacturers.

Note: Specifications subject to change without notice.

Catalog Number
Notes
Type

### Class Pack - Specification Troffer

# CPSP8 2'x4'

2 LAMPS  
T8



**CLASS PACK**



#### Specifications

Length: 48 (121.8)

Width: 24 (60.9)

Depth: 3-11/16 (9.4)

Weight: 22 lbs (9.9 kg)

All dimensions are shown in inches (centimeters) unless otherwise specified.

### ORDERING INFORMATION

Lead times will vary depending on options selected. Consult with your sales representative.

**Example:** CPSP8 2 32 GTHP G841HT8 CP9 PWS1846

CPSP8	2	32				GTHP
Series	Number of lamps	Wattage	Door frame	Lens	Voltage	Ballast
CPSP8	2	32	(blank) Flush steel, white RW Regressed aluminum, white	(blank) #12 pattern acrylic, .125" thick A19 #19 pattern acrylic, .156" thick	(blank) MVOLT (120V-277V) 120 120V 277 277V	GTHP Instant start, step dimming, high efficiency, 1.18 ballast factor (high)
Lamp	Packaging <sup>1</sup>		Options			
G841HT8 3100 lumen, high CRI, 4100K	CP1 Single, stand-alone unit in an individual carton		GLR Internal fast-blow fuse <sup>4</sup>			
G835HT8 3100 lumen, high CRI, 3500K	CP9 Nine-pack <sup>2</sup>		GMF Internal slow-blow fuse <sup>4</sup>			
G841E28 28W ES, 2750 lumen, high CRI, 4100K	CP12 12-pack <sup>2</sup>		PWS1846 6' prewire, 3/8" diameter, 18-gauge, two circuits			
G835E28 28W ES, 2750 lumen, high CRI, 3500K	LSTS Single satellite unit, used in CP9 or CP12 <sup>3</sup>		EL14 Emergency battery pack (nominal 1400 lumens)			
LPGM841 2800 lumen, 4100K	LSTM3 Single master unit, used in CP9 or CP12 <sup>3</sup>		CSA CSA Certified			
LPGM835 2800 lumen, 3500K						

Accessories: Sensor Switch® control options. Shipped separately.	
WV-PDT	Occupancy sensor.
WV-PDT-P	Occupancy sensor with photocell
CM-PC	Switching photocell
PP-20	Power pack
SP-20	Slave pack

#### Notes

- 1 Refer to packaging/wiring table on the following page for further detail.
- 2 Multi-pack "CP" packaging is palletized and stretch-wrapped without individual cartons.
- 3 Single satellite and master units are packaged in individual cartons.
- 4 Must specify voltage.

# CPSP8 2'x4' Static T8 Troffer

## DIMENSIONS

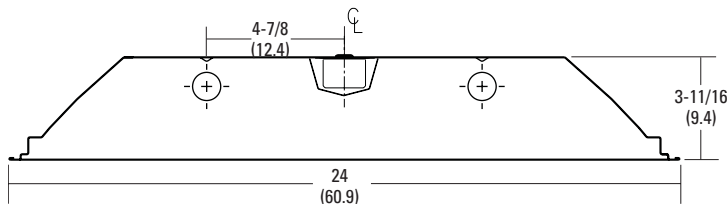

## PACKAGING/WIRING

Packaging / Wiring					
Packaging	# Master Fixtures	# Satellite Fixtures	# Stand-alone Fixtures	Instant Start Input watts per Fixture (120/277)	Program Start Input watts per Fixture (120/277)
CP9	3	6	-	75/73	73/72
CP12	4	8	-	75/73	73/72
LSTS	-	1	-	75/73	73/72
LSTM3	1	-	-	75/73	73/72
CP1	-	-	1	75/74	75/74

## PHOTOMETRICS

Calculated using the zonal cavity method in accordance with IESNA LM41 procedure. Floor reflectances are 20%. Lamp configurations shown are typical. Full photometric data on these and other configurations available upon request. (Class Pack uses SP8 photometry.)

TEST NO: LTL7525

LUMINAIRE CATALOG NO.: CPSP8 2 32 A12 GEB10IS  
LUMENS PER LAMP: 2850

TEST NO: LTL7434

LUMINAIRE CATALOG NO.: CPSP8 2 32 A19 ADDE  
LUMENS PER LAMP: 2850

RCR	pf pc pw	Coefficients of Utilization									RCR	pf pc pw	Coefficients of Utilization								
		80%			70%			50%					80%			70%			50%		
		50%	30%	10%	50%	30%	10%	50%	30%	10%			50%	30%	10%	50%	30%	10%	50%	30%	10%
0	102	102	102	99	99	99	95	95	95	0	101	101	101	98	98	98	94	94	94		
1	90	87	84	88	85	83	85	82	80	1	90	87	84	88	85	83	85	82	80		
2	80	74	70	78	73	69	75	71	68	2	80	76	71	79	74	71	76	72	69		
3	71	64	59	70	64	59	67	62	58	3	72	66	61	71	65	61	68	64	60		
4	63	56	51	62	56	51	60	55	50	4	65	58	53	64	58	53	62	57	52		
5	57	50	44	56	49	44	54	48	44	5	59	52	47	58	51	47	56	51	46		
6	52	44	39	51	44	39	49	43	39	6	53	47	42	53	46	41	51	45	41		
7	47	40	35	46	40	35	45	39	34	7	49	42	37	48	42	37	47	41	37		
8	43	36	31	42	36	31	41	35	31	8	45	38	34	44	38	33	43	37	33		
9	39	33	28	39	33	28	38	32	28	9	41	35	30	41	35	30	40	34	30		
10	36	30	26	36	30	26	35	29	25	10	38	32	28	38	32	28	37	31	28		

Zonal Lumen Summary			
Zone	Lumens	% Lamp	% Fixture
0° - 30°	1541.4	27.0	31.6
0° - 40°	2570.8	45.1	52.7
0° - 60°	4192.1	73.5	86.0
0° - 90°	4875.5	85.5	100.0
90° - 180°	0.0	0.0	0.0
0° - 180°	4875.5	85.5	100.0

Zonal Lumen Summary			
Zone	Lumens	% Lamp	% Fixture
0° - 30°	1710.3	30.0	35.5
0° - 40°	2858.7	50.2	59.3
0° - 60°	4332.1	76.0	89.9
0° - 90°	4819.0	84.5	100.0
90° - 180°	0.0	0.0	0.0
0° - 180°	4819.0	84.5	100.0



CPSP8-2X4