

FEATURES & SPECIFICATIONS

INTENDED USE

Ideal for parking areas, street lighting, walkways and car lots.

CONSTRUCTION

Rugged, die-cast, soft corner aluminum housing with 0.12" nominal wall thickness. Die-cast door frame has impact-resistant, tempered, flat glass lens that is fully gasketed with one-piece tubular silicone.

FINISH

Finish is dark bronze (DDB) polyester powder.

OPTICAL SYSTEM

Anodized, aluminum hydroformed reflectors: IES full cutoff distributions: R3 (asymmetric) or R4 (forward throw). Optional houseside shield (HS) available.

ELECTRICAL SYSTEM

Ballast: Super CWA pulse start ballasts, 88% efficient and EISA legislation compliant, are required for 250-400W (must order SCWA option) for shipments in the U.S.

Socket: Porcelain, horizontally oriented mogul base socket with copper alloy, nickel-plated screw shell and center contact. UL listed 1500W, 600V.

Lamp included.

LISTING

UL Listed (standard). UL listed for 25°C ambient and wet locations. IP65 rated. NOTE: Specifications subject to change without notice.

Catalog Number	
Notes	Type

CONTOUR
FAMILY

Night-time Friendly / Full Cutoff Lighting

KAD/POLE COMBO

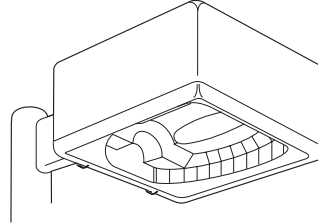

Standard Dimensions

EPA: 1.2 ft.²
Weight: 41 lbs (18.6 kg)
Length: 17-1/2 (44.5)
Width: 17-1/2 (44.5)
Depth: 7-1/8 (18.1)

METAL HALIDE

250W, 400W
16' to 25' Mounting

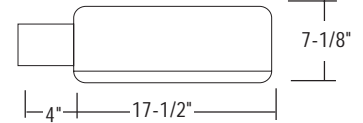

All dimensions are inches (centimeters) unless otherwise specified.

FEATURES & SPECIFICATIONS

CONSTRUCTION

Weldable-grade, hot-rolled, commercial-quality carbon steel tubing with a minimum yield of 55,000 psi (11-gauge). Uniform wall thickness of .125". Shafts are one-piece with a longitudinal electric resistance weld. Uniformly square in cross-section with flat sides, small corner radii and excellent torsion. Available shaft width is 4".

Anchor base is fabricated from hot-rolled carbon steel plate that meets or exceeds a minimum yield strength of 36,000 psi. The anchor base is provided with slotted holes.

A handhole having nominal dimensions of 3" x 5" for all shafts. Included is a cover with attachment screw.

Weatherproof, high-strength plastic top cap provided.

Automotive-grade ABS plastic full base cover is finished to match pole.

FINISH

Dark bronze (DDB) polyester powder.

GROUNDING

A nut holder located immediately inside the handhole rim is provided (ground bolt and nut by others).

ANCHOR BOLTS

Top portion of anchor bolt is galvanized per ASTM A-153. Made of steel rod (3/4" x 18" x 3") having a minimum yield strength of 55,000 psi. Includes 4 anchor bolts, 8 hex nuts with washers, and template.

NOTE: Specifications subject to change without notice.

IMPORTANT:

These specifications are intended for general purposes only. Lithonia reserves the right to change material or design, without prior notice, in a continuing effort to upgrade its products.

Installation requires grout to be packed under base to ensure full contact with foundation.

Anchor Base Poles

SSS

SQUARE STRAIGHT STEEL

16' to 25' Mounting

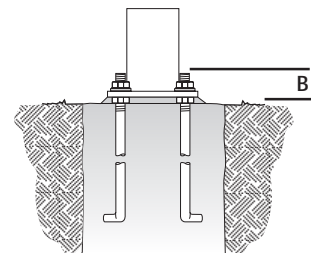
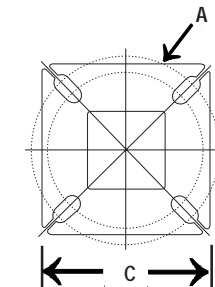

Shaft Base Size	Bolt Circle A	Bolt Projection B	Base Square C	Anchor Bolts (w/ template in carton)	Template Number
4"C	8-1/2"	2-3/4" - 4"	8"	ABSSS-4C	PJ50004

HANDHOLE ORIENTATION

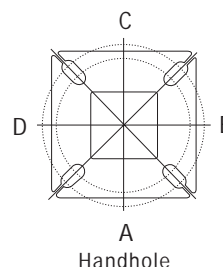

BASE DETAIL

