

FEATURES

OPTICAL SYSTEM

- Center Beam optical system centers the lamp relative to the true aperture, optimizing lamp efficiency.
- Tool-less 0° - 40° vertical and 360° horizontal lamp adjustments made with the trim assembly removed for simple focusing. Lockable adjustment mechanisms maintain focus during relamping and are visible from below the ceiling with trim assembly removed.
- Self-flanged, semi-specular or matte-diffuse anodized cone designed to minimize backflash. Contour cut reduces visibility of inner housing.
- Interchangeable upper reflectors provide narrow, medium and wide distributions. These preset distribution patterns allow designers to achieve various design objectives.
- 1/8" thick softening lens eliminates beam striations and ensures maximum efficiency. Provides required protective shielding.
- Optical system retained by self-aligning torsion support springs.
- Internal housing components painted black.

MECHANICAL SYSTEM

- Black painted housing features tool-less top access accommodates a maximum 1-1/2" ceiling thickness.
- Tool-less re-lamp capability from above or below ceiling.
- 16-gauge galvanized steel mounting bars with continuous 4" vertical adjustment are shipped pre-installed. Post installation adjustment possible without the use of tools from above or below ceiling.
- Galvanized steel junction box with hinged access covers and spring latch. Three combination 1/2"-3/4" and two 1/2" knockouts for straight-through conduit runs. Capacity: 8 (4 in, 4 out) No. 12 AWG conductors rated for 90°C.
- Secondary housing adjustment system for precise, final ceiling to flange alignment.

ELECTRICAL SYSTEM

- Tool-less access door provides access to junction box and ballast through the aperture.
- G12 (T6), G8.5 (T4) or PGJ5 (T4T) base ceramic socket.
- Pre-wired, electronic, 120 or 277V ballast module is standard. Assembly can be attached before or after mounting of mounting/plaster frame.
- Thermally activated insulation detector.
- 3000°K lamp ships standard.

LISTING

- Features are UL Listed for thru-branch wiring, Non-IC recessed mounting and damp locations. Listed and labeled to comply with Canadian Standards.

Type

Catalog number

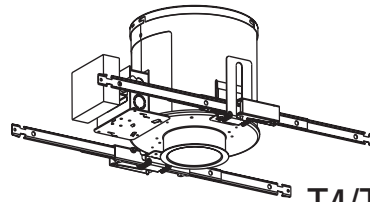

HID Downlights 4" DTH

T4/T6 Adjustable Accent Ceramic Metal Halide Lamp

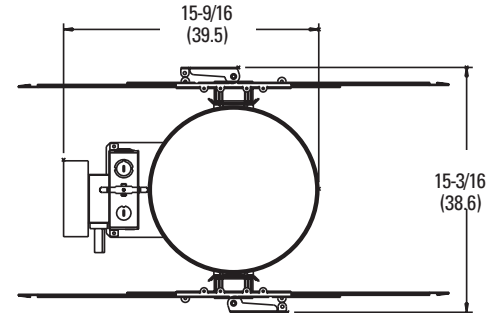

Aperture: 4-3/8 (11.1)
Ceiling Opening: 5-1/16 (12.9)
Overlap Trim: 5-7/16 (3.8)

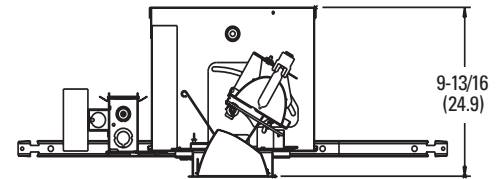

All dimensions are inches (centimeters).

ORDERING INFORMATION

Example: **DTH T4T 20MHC 4ACT30 N LD 120**

Choose the boldface catalog nomenclature that best suits your needs and write it on the appropriate line. Order accessories as separate catalog numbers (shipped separately).

DTH

Series	Lamp Wattage	Aperture/Trim Color	Type	Finish	Voltage	Ballast	Options
DTH	20MHC 39MHC 70MHC	4AC Clear 4BC ⁴ Black 4PC Pewter 4UBC Umber 4WTC Wheat	T00 Cut for angles 0°-15° T20 Cut for angles 15°-25° T30 Cut for angles 25°-40°	(blank) Semi-specular LD Matte-diffuse	120 277 347 ⁵	(blank) Electronic ballast EMB Electro-magnetic ballast	QRS ⁶ Quartz restrike system (uses 100W max. DC base quartz lamp by others) QRSTD ⁶ Quartz restrike system with time delay EC Emergency circuit (DC socket with leads for connection to external emergency power source; 100W max. lamp) SF Single fuse TRW White painted flange TRBL Black painted flange L/LP Less lamp LRC ⁷ Provides compatibility with Lithonia Reloc [®] System. Access above ceiling required CP Chicago Plenum

NOTES

- 1 Philips Mini MasterColor[®] available in 20W & 120V only. Consult factory for availability on 39W.
- 2 Available with electronic ballast only.
- 3 Available in 39W and 70W only.
- 4 Not available with finishes.
- 5 Available with 70W electro-magnetic ballast only.
- 6 Not available with electronic ballast.
- 7 For compatible Reloc system, refer to Technical Bulletins tab.

Distribution

- N Narrow
- M Medium
- W Wide

4" DTH Adjustable Accent

Distribution curve Distribution data Output data Coefficient of utilization Illuminance Data at 30" Above Floor for a Single Luminaire

DTH T4 39M 4ACT00 N, CMH39/TC/U/830/G8.5 lamp, 3400 rated lumens, 0.5 s/mh, Test No. LTL15047

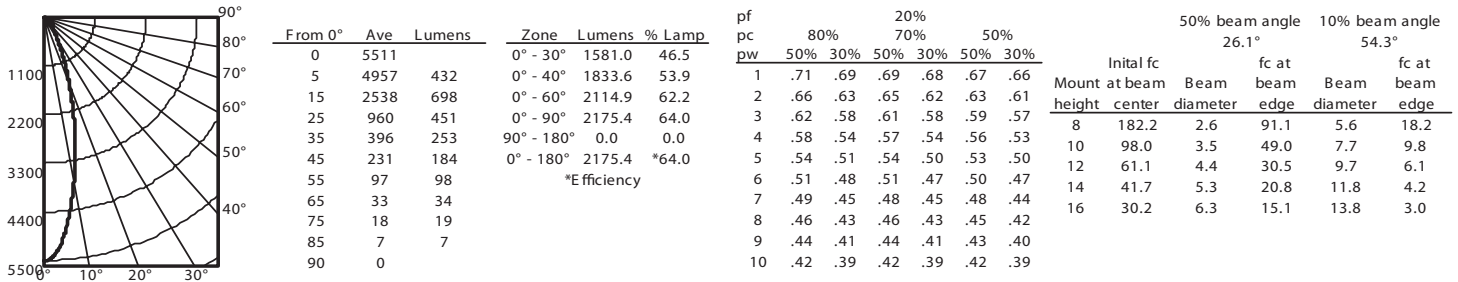

DTH T4 39M 4ACT00 M, CMH39/TC/U/830/G8.5 lamp, 3400 rated lumens, 0.8 s/mh, Test No. LTL15364

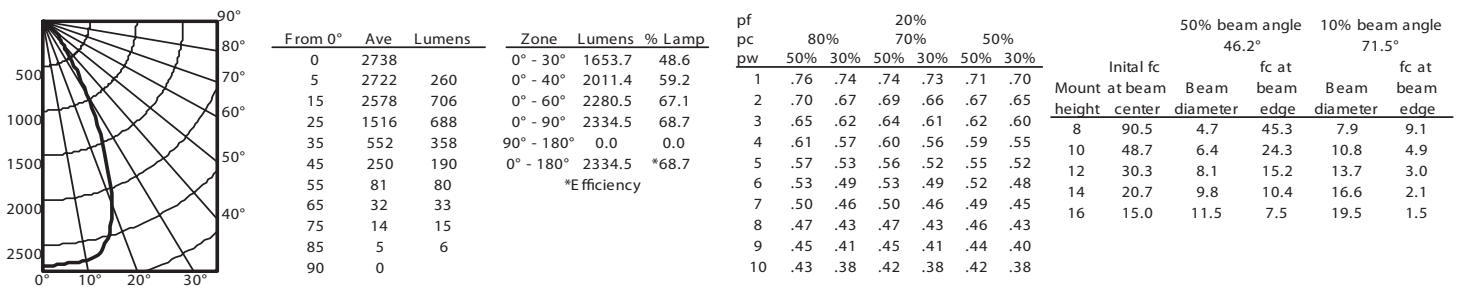

DTH T4 39M 4ACT00 W, CMH39/TC/U/830/G8.5 lamp, 3400 rated lumens, 0.9 s/mh, Test No. LTL15363

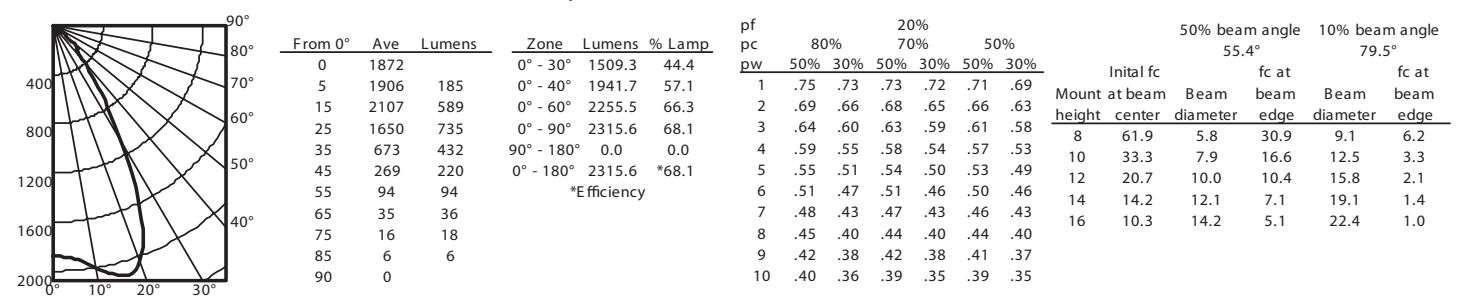

DTH T4T 20M 4ACT00 M, CDM-Tm 20W/830 lamp, 1500 rated lumens, 0.7 s/mh, Test No. LTL15419

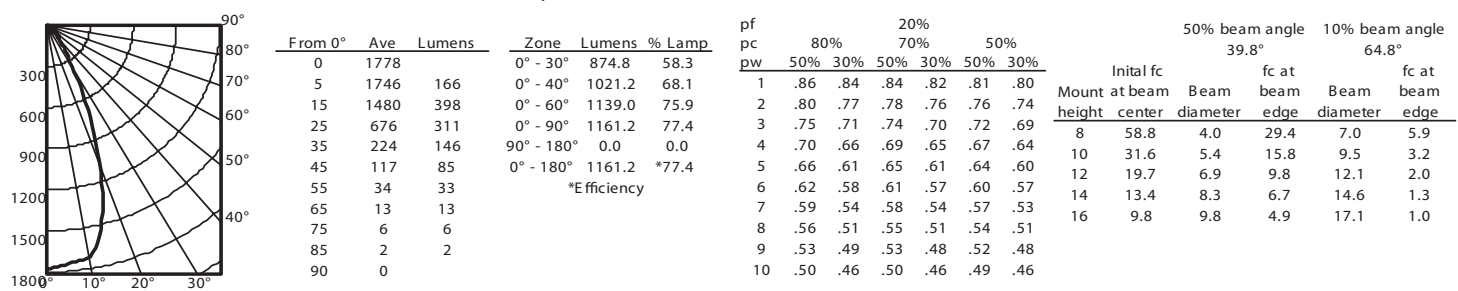

NOTES:

- For electrical characteristics consult Technical Bulletins tab.
- Tested to current IES and NEMA standards under stabilized laboratory conditions. Various operating factors can cause differences between laboratory data and actual field measurements. Dimensions and specifications are based on the most current available data and are subject to change without notice.

AHID-140

©2006 Gotham, Rev. 10/06
AHID-140.p65

gotham
An AcuityBrands Company

GOTHAM ARCHITECTURAL DOWNLIGHTING
1400 Lester Road Conyers Georgia 30012
P 800 315 4982 F 770 860 3129
www.gothamlighting.com