

FEATURES

OPTICAL SYSTEM

- Reflector - Self-flanged, specular or semi-diffuse reflector. Bounding Ray™ Optical Principle design provides lamp before lamp image and smooth transition from top of reflector to bottom.
- Patent-pending integrated snoot and optical system minimizes lamp striations normally associated with PAR lamps and creates visually pleasing scallops on vertical surfaces.

MECHANICAL SYSTEM

- 16-gauge galvanized steel mounting/plaster frame. Adjustable yoke and tempered steel flat spring utilized to retain optical system. Accommodates up to 1-5/8" thick ceiling with no modifications.
- 16-gauge galvanized steel mounting bars provide continuous vertical and horizontal adjustment and are held in place with tool-less, cam-action, locking brackets. Post installation adjustment possible from above or below ceiling. Shipped pre-installed.
- 16-gauge galvanized steel junction box with hinged access covers. Two combination 1/2"-3/4" and four 1/2" knockouts for straight-through conduit runs. Capacity: 8 (4 in, 4 out) No. 12 AWG conductors rated for 90°C.

ELECTRICAL SYSTEM

- Die-cast aluminum lampholder housing.
- Medium base porcelain socket with nickel-plated screw shell.
- Pre-wired, encased-and-potted, 120/277V or 120/347V ballast tray module. Module can be attached before or after installation of mounting/plaster frame.
- Thermally-activated insulation detector.

LISTING

- Fixtures are UL Listed for thru-branch wiring, non-IC recessed mounting and damp locations. Listed and labeled to comply with Canadian Standards.

Type Catalog number

.....

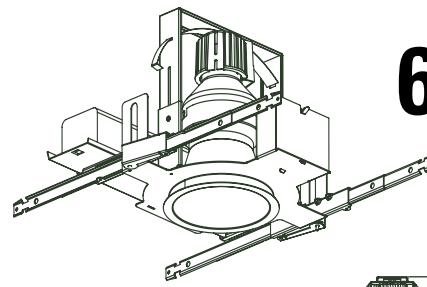

HID Downlights
6" APRH
 Open Reflector
 PAR38

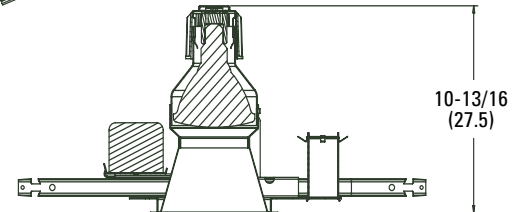

Aperture: 6-1/4 (15.9)
 Ceiling opening: 6-7/8 (17.5)
 Overlap trim: 7-1/2 (19.1)

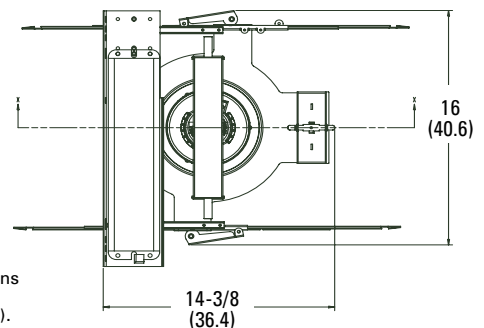

All dimensions are inches (centimeters).

ORDERING INFORMATION

Example: **APRH P3870MHC 6AR 120**

Choose the boldface catalog nomenclature that best suits your needs and write it on the appropriate line. Order accessories as separate catalog numbers (shipped separately).

APRH

Series	Lamp designation	Aperture/Trim color	Finish	Voltage	Ballast	Options		
APRH	<i>Metal Halide</i>	6AR Clear	(blank) Specular low iridescent	120	(blank) Electro-magnetic ballast	TRW White painted flange. LRC³ Provides compatibility with Lithonia Reloc® System. Lithonia Reloc System can be installed less this option with connectors provided by others. Access above ceiling required. SF Single Fuse. CP Chicago Plenum. LPFL Flood lamp (shipped separately). LPSP Spot lamp (shipped separately). LPWFL Wide Flood lamp (shipped separately). Available with P38 only. QRS⁴ Quartz Restrike System. QRSTD⁵ Quartz Restrike System with Time Delay. EC Emergency Circuit. GSKT Foam gasketing.		
	P3870M 70W PAR38	6BR¹ Black					LD Semi-diffuse low iridescent	277
	P38100M 100W PAR38	6PR Pewter						
	P38150M 150W PAR38	6WTR Wheat	6UBR Umber	347				
	<i>Ceramic Metal Halide</i>	6UBR Umber			HEB² Electronic ballast			
	P3870MHC 70W PAR38							
P38100MHC 100W PAR38								
P38150MHC 150W PAR38								

NOTES

- 1 Not available with LD finish.
- 2 Available in 120V or 277V only.
- 3 For compatible Reloc systems, refer to Technical Bulletins tab.
- 4 Not available with HEB, QRSTD or EC.
- 5 Not available with HEB, QRS or EC.

Accessories

SC6FL Sloped Ceiling adaptor. Degree of slope must be specified (10D, 15D, 20D, 25D, 30D). EX: SC6FL 10D.

6" APRH Open Reflector

Distribution curve Distribution data Output data Coefficient of utilization Single luminaire data 30" above floor

APRH 6AR, 100W MCP100PAR38/U/830/SP lamp, 0.3 spacing criteria, 6500 rated lumens, test no. It12862

Distribution curve	Distribution data		Output data		Coefficient of utilization						Single luminaire data 30" above floor										
	cp	Lumens	Zone	Lumens % Lamp	pf	20%		50%		Initial FC		50% beam - 17.3'		10% beam - 36.2'							
					pc	80%	70%	50%	pw	50%	30%	50%	30%	50%	30%	Mounting Height	Center Beam Diameter	FC Diameter	FC		
	0°	42333	0° - 30°	5773	88.8	0	109	109	106	106	102	102	0	0	0	8	1399.4	1.7	699.9	3.6	139.9
	5°	33016	0° - 40°	5896	90.7	1	104	102	102	100	98	97	1	1	1	10	752.6	2.3	376.4	4.9	75.2
	15°	8430	0° - 60°	5931	91.2	2	99	97	98	95	95	93	2	2	2	12	469.1	2.9	234.6	6.2	46.9
	25°	1506	0° - 90°	5938	91.4	3	95	92	94	91	92	90	3	3	3	14	320.1	3.5	160.1	7.5	32.0
	35°	161	90° - 180°	0	0.0	4	92	89	91	88	89	87	4	4	4	16	232.3	4.1	116.2	8.8	23.2
	45°	35	0° - 180°	5938	*91.4	5	89	86	88	85	87	84	5	5	5						
	55°	6				6	87	83	86	83	85	82	6	6	6						
	65°	3				7	84	81	84	80	83	80	7	7	7						
	75°	2				8	82	79	82	78	81	78	8	8	8						
	85°	2				9	80	77	80	76	79	76	9	9	9						
	90°	0				10	78	75	78	75	77	74	10	10	10						

APRH 6AR, 100W MP100PAR38/U/FL35/ECO lamp, 0.5 spacing criteria, 5800 rated lumens, test no. It12899

Distribution curve	Distribution data		Output data		Coefficient of utilization						Single luminaire data 30" above floor										
	cp	Lumens	Zone	Lumens % Lamp	pf	20%		50%		Initial FC		50% beam - 32.2'		10% beam - 51.2'							
					pc	80%	70%	50%	pw	50%	30%	50%	30%	50%	30%	Mounting Height	Center Beam Diameter	FC Diameter	FC		
	0°	12966	0° - 30°	4141	71.4	0	89	89	87	87	83	83	0	0	0	8	428.6	3.2	214.2	5.3	42.8
	5°	11708	0° - 40°	4294	74.0	1	84	82	82	81	79	78	1	1	1	10	230.5	4.3	115.2	7.2	23.0
	15°	8048	0° - 60°	4319	74.5	2	80	77	78	76	76	74	2	2	2	12	143.7	5.5	71.8	9.1	14.4
	25°	1983	0° - 90°	4322	74.5	3	76	73	75	72	73	71	3	3	3	14	98.0	6.6	49.0	11.0	9.8
	35°	190	90° - 180°	0	0.0	4	73	69	72	69	70	68	4	4	4	16	71.1	7.8	35.6	12.9	7.1
	45°	25	0° - 180°	4322	*74.5	5	70	66	69	66	68	65	5	5	5						
	55°	1				6	67	64	66	63	65	63	6	6	6						
	65°	2				7	64	61	64	61	63	60	7	7	7						
	75°	2				8	62	59	62	58	61	58	8	8	8						
	85°	1				9	60	57	60	56	59	56	9	9	9						
	90°	0				10	58	55	58	54	57	54	10	10	10						

NOTES

- 1 For electrical characteristics refer to the Technical Bulletins tab.
- 2 Tested to current IES and NEMA standards under stabilized laboratory conditions. Various operating factors can cause differences between laboratory data and actual field measurements. Dimensions and specifications are based on the most current available data and are subject to change without notice.

DHID-665.5

©2004 Gotham 12/04
DHID-665.5.p65



GOTHAM ARCHITECTURAL DOWNLIGHTING
A DIVISION OF ACUITY LIGHTING GROUP, INC.
1400 Lester Road Conyers Georgia 30012
P 800 315 4982 F 770 860 3129
www.gothamlighting.com