

FEATURES

OPTICAL SYSTEM

- Reflector - Self-flanged, specular or semi-diffuse reflector. Bounding Ray™ Optical Principle design provides lamp before lamp image and smooth transition from top of reflector to bottom.
- Patent-pending integrated snoot and optical system minimizes lamp striations normally associated with PAR lamps and creates visually pleasing scallops on vertical surfaces.

MECHANICAL SYSTEM

- 16-gauge galvanized steel mounting/plaster frame. Adjustable yoke and tempered steel flat spring utilized to retain optical system. Accommodates up to 1-5/8" thick ceiling with no modifications.
- 16-gauge galvanized steel mounting bars provide continuous vertical and horizontal adjustment and are held in place with tool-less, cam-action, locking brackets. Post installation adjustment possible from above or below ceiling. Shipped pre-installed.
- 16-gauge galvanized steel junction box with hinged access covers. Two combination 1/2"-3/4" and four 1/2" knockouts for straight-through conduit runs. Capacity: 8 (4 in, 4 out) No. 12 AWG conductors rated for 90°C.

ELECTRICAL SYSTEM

- Die-cast aluminum lampholder housing.
- Medium base porcelain socket with nickel-plated screw shell.
- Pre-wired, encased-and-potted, 120/277V or 120/347V ballast tray module. Module can be attached before or after installation of mounting/plaster frame.
- Thermally-activated insulation detector.

LISTING

- Fixtures are UL Listed for thru-branch wiring, non-IC recessed mounting and damp locations. Listed and labeled to comply with Canadian Standards.

Type Catalog number

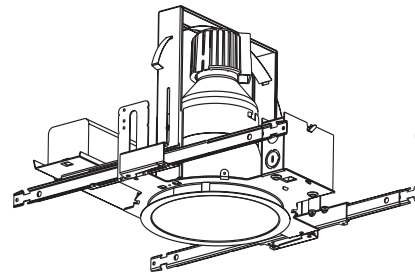

HID Downlights
8" APRH
 Open Reflector
 PAR38

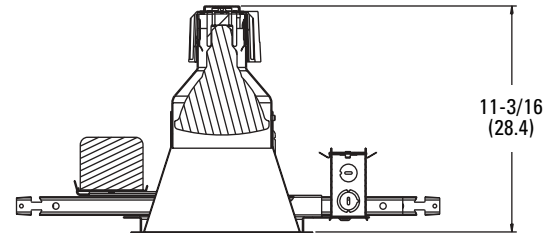

Aperture: 7-7/8 (20.0)
 Ceiling opening: 8-1/2 (21.6)
 Overlap trim: 9-1/4 (23.5)

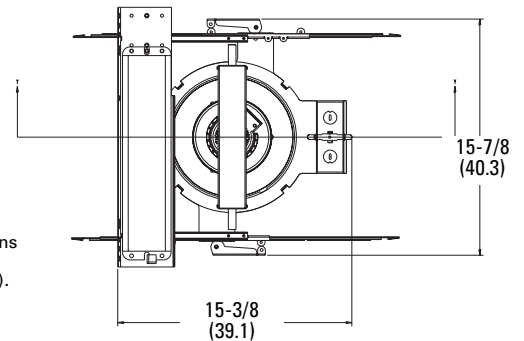

All dimensions are inches (centimeters).

ORDERING INFORMATION

Example: **APRH P3870M 8AR 120**

Choose the boldface catalog nomenclature that best suits your needs and write it on the appropriate line. Order accessories as separate catalog numbers (shipped separately).

APRH

Series	Lamp designation	Aperture/Trim color	Finish	Voltage	Ballast	Options
APRH	<i>Metal Halide</i>	8AR Clear	(blank) Specular low iridescent	120	(blank) Electro-magnetic ballast	TRW White painted flange.
	P3870M 70W PAR38	8BR¹ Black	LD Semi-diffuse low iridescent	277	HEB² Electronic ballast	LRC³ Provides compatibility with Lithonia Reloc® System. Lithonia Reloc System can be installed less this option with connectors provided by others. Access above ceiling required.
	P38100M 100W PAR38	8PR Pewter		347		SF Single Fuse.
	P38150M 150W PAR38	8WTR Wheat				CP Chicago Plenum.
	<i>Ceramic Metal Halide</i>	8UBR Umber				LPFL Flood lamp (shipped separately).
	P3870MHC 70W PAR38					LPSP Spot lamp (shipped separately).
	P38100MHC 100W PAR38					LPWFL Wide Flood lamp (shipped separately).
	P38150MHC 150W PAR38					QRS⁴ Quartz Restrike System.
						QRSTD⁵ Quartz Restrike System with Time Delay.
						EC Emergency Circuit.
					GSKT Foam gasketing.	

NOTES

- 1 Not available with LD finish.
- 2 Available in 120V or 277V only.
- 3 For compatible Reloc systems, refer to Technical Bulletins tab.
- 4 Not available with HEB, QRSTD or EC.
- 5 Not available with HEB, QRS or EC.

Accessories

SC8 Sloped Ceiling adaptor. Degree of slope must be specified (10D, 15D, 20D, 25D, 30D). EX: SC8 10D.

8" APRH Open Reflector

Distribution curve Distribution data Output data Coefficient of utilization Single luminaire data 30" above floor

APRH 8AR, 100W MCP100PAR38/U/830/SP lamp, 0.3 spacing criteria, 6500 rated lumens, test no. Itl12840

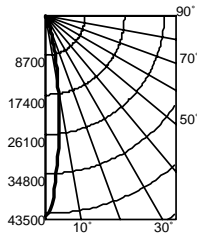

cp	Lumens	Zone	Lumens % Lamp
0°	43914	0° - 30°	5239 80.6
5°	31077	0° - 40°	5377 82.7
15°	7210	0° - 60°	5405 83.2
25°	1444	0° - 90°	5411 83.2
35°	171	90° - 180°	0 0.0
45°	25	0° - 180°	5411 *83.2
55°	1	*Total Efficiency	
65°	0		
75°	3		
85°	4		
90°	0		

pf	20%						Initial FC	50% beam - 15.1'	10% beam - 34.3'	
	pc	80%		70%		50%				
		50%	30%	50%	30%	50%				30%
0	99	99	97	97	92	92	Mounting	Center		
1	94	93	93	91	89	88	Height	Beam		
2	90	88	89	87	86	85	Diameter	FC		
3	87	84	86	83	84	82	Diameter	FC		
4	84	81	83	80	81	79	8	1451.7		
5	81	78	81	78	79	77	10	780.7		
6	79	76	78	75	77	75	12	486.6		
7	77	74	76	73	75	73	14	332.1		
8	75	72	74	71	74	71	16	241.0		
9	73	70	73	70	72	69				
10	71	68	71	68	70	68				

APRH 8AR, 100W MP100PAR38/U/FL35/ECO lamp, 0.5 spacing criteria, 5800 rated lumens, test no. Itl12900

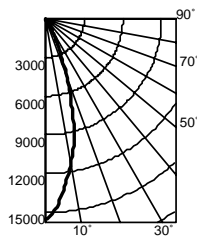

cp	Lumens	Zone	Lumens % Lamp
0°	15454	0° - 30°	4557 78.6
5°	13862	0° - 40°	4752 81.9
15°	8436	0° - 60°	4783 82.5
25°	2202	0° - 90°	4786 82.5
35°	251	90° - 180°	0 0.0
45°	28	0° - 180°	4786 *82.5
55°	4	*Total Efficiency	
65°	1		
75°	1		
85°	1		
90°	0		

pf	20%						Initial FC	50% beam - 29.7'	10% beam - 50.6'	
	pc	80%		70%		50%				
		50%	30%	50%	30%	50%				30%
0	98	98	96	96	92	92	Mounting	Center		
1	93	91	91	90	88	87	Height	Beam		
2	88	86	87	84	84	82	Diameter	FC		
3	84	81	83	80	81	79	Diameter	FC		
4	80	77	80	76	78	75	8	510.9		
5	77	74	76	73	75	72	10	274.7		
6	74	70	74	70	72	69	12	171.2		
7	71	68	71	67	70	67	14	116.9		
8	69	65	68	65	68	64	16	84.8		
9	66	63	66	63	65	62				
10	64	61	64	60	63	60				

NOTES

- 1 For electrical characteristics refer to the Technical Bulletins tab.
- 2 Tested to current IES and NEMA standards under stabilized laboratory conditions. Various operating factors can cause differences between laboratory data and actual field measurements. Dimensions and specifications are based on the most current available data and are subject to change without notice.

DHID-690

©2004 Gotham 12/04
DHID-690.p65

gotham
An Acuity Brands Company

GOTHAM ARCHITECTURAL DOWNLIGHTING
A DIVISION OF ACUITY LIGHTING GROUP, INC.
1400 Lester Road Conyers Georgia 30012
P 800 315 4982 F 770 860 3129
www.gothamlighting.com