

# FEATURES

## OPTICAL SYSTEM

- Self-flanged, matte-diffuse or specular reflector. Patented Bounding Ray™ Optical Principle design (U.S. Patent No. 5,800,050) provides lamp before lamp image and smooth transition from top of reflector to bottom.
- Patent-pending integrated snoot and optical system minimizes lamp striations normally associated with PAR lamps and creates visually pleasing scallops on vertical surfaces.
- Lampholder optimally positions either a PAR36 or AR111. Safety glass is included for AR111.

## MECHANICAL SYSTEM

- 16-gauge galvanized steel mounting/plaster frame. Adjustable yoke and tempered steel flat spring utilized to retain optical system. Accommodates up to 1-5/8" thick ceiling with no modifications.
- 16-gauge galvanized steel mounting bars provide continuous vertical and horizontal adjustment and are held in place with tool-less, cam-action, locking brackets. Post installation adjustment possible from above or below the ceiling. Shipped pre-installed.
- 16-gauge galvanized steel junction box with hinged access covers. Two combination 1/2-3/4" and two 1/2" knockouts for straight-through conduit runs. Capacity: 8 (4 in, 4 out) No. 12 AWG conductors, rated for 90°C.

## ELECTRICAL SYSTEM

- Die-cast aluminum lampholder housing.
- Fused, 12-volt transformer is mounted to junction box cover.
- Thermally-activated insulation detector.

## LISTING

- Fixtures are UL Listed for thru-branch wiring, non-IC recessed mounting and damp locations. Listed and labeled to comply with Canadian Standards.

Type Catalog number

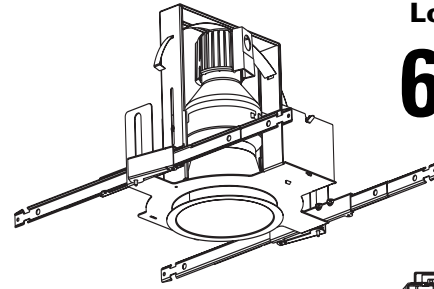

Low Voltage Downlights

# 6" APRLV

Open Reflector  
PAR36 or AR111

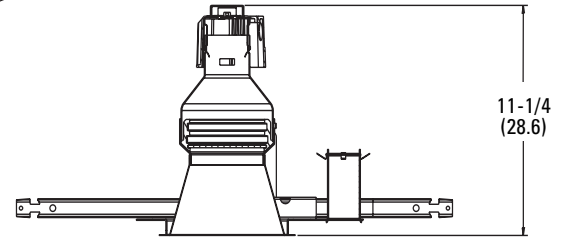

Aperture: 4-5/16 (10.9)  
Ceiling opening: 5-1/16 (12.9)  
Overlap trim: 5-7/16 (13.8)

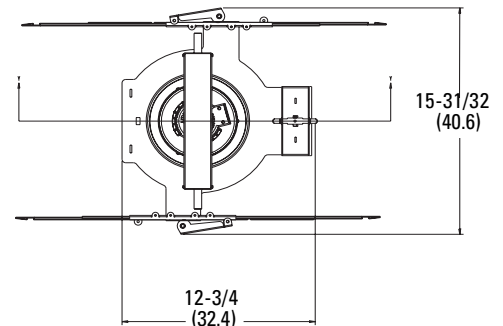

All dimensions are inches (centimeters).

# ORDERING INFORMATION

Example: **APRLV AR111 6AR 120**

Choose the boldface catalog nomenclature that best suits your needs and write it on the appropriate line. Order accessories as separate catalog numbers (shipped separately).

## APRLV

Series	Lamp designation	Aperture/Trim color	Finish	Voltage	Ballast	Options
APRLV	<b>AR111</b> (100W max.)	<b>6AR</b> Clear	(blank) Semi-Specular	<b>120</b>	(blank) Electro-magnetic transformer	<b>TRW</b> White painted flange
		<b>PAR36</b> (75W max.)	<b>6BR</b> <sup>1</sup> Black	<b>277</b>		<b>LRC</b> <sup>3</sup> Provides compatibility with Lithonia Reloc® System. Lithonia Reloc system can be installed less this option with connectors provided by others. Access above ceiling required
		<b>6PR</b> Pewter	<b>LD</b> Matte-diffuse	<b>347</b>	<b>LVET</b> <sup>2</sup> Low Voltage electronic transformer	<b>CP</b> Chicago Plenum
		<b>6WTR</b> Wheat				<b>GSKT</b> Foam gasketing
		<b>6UBR</b> Umber				
		<b>6GR</b> Gold				
	<b>6CR</b> Champagne gold					

## NOTES

- 1 Not available with LD finish.
- 2 100W available in 120V only (50W Min). 75W and lower available in 120V or 277V only.
- 3 For compatible Reloc systems, refer to Technical Bulletins tab.

## Accessories

SCA6FL Sloped Ceiling adapter. Degree of slope must be specified (10D, 15D, 20D, 25D, 30D). EX: SCA6FL 10D.

# 6" APRLV Open Reflector

## LAMP PERFORMANCE DATA

The lighting performance data charts shown provide lighting levels (footcandles), beam pattern (in feet), rated lamp life (hours).

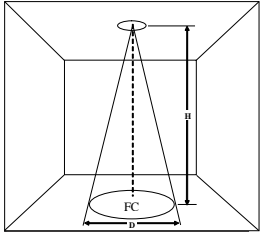

	Rated Life	Beam Spread	H	FC	D		Rated Life	Beam Spread	H	FC	D
36PAR38/CAP/VNSP5 CBCP = 17,000	4000	5	8	266	0.7	75AR111/FL25 CBCP = 5,300	3000	25	4	331	1.8
			10	170	0.9				6	147	2.7
			12	118	1.0				8	83	3.5
			14	87	1.2				10	53	4.4
			16	66	1.4				12	37	5.3
			18	52	1.6			14	27	6.2	
36PAR36/CAP/NSP13 CBCP = 3,500	4000	13	4	219	0.9	75AR111/WFL45 CBCP = 1,700	3000	45	4	106	3.3
			6	97	1.4				6	47	5.0
			8	55	1.8				8	27	6.6
			10	35	2.3				10	17	8.3
			12	24	2.7						
			14	18	3.2						
36PAR36/CAP/WFL32 CBCP = 1,000	4000	32	4	63	2.3	100AR111/SP8 CBCP = 48,000	3000	8	14	245	2.0
			6	28	3.4				16	188	2.2
			8	16	4.6				18	148	2.5
									20	120	2.8
									22	99	3.1
								24	83	3.4	
50PAR36/CAP/NSP6 CBCP = 25,000	4000	6	10	250	1.0	100AR111/FL25 CBCP = 8,500	3000	25	6	236	2.7
			12	174	1.3				8	133	3.5
			14	128	1.5				10	85	4.4
			16	98	1.7				12	59	5.3
			18	77	1.9				14	43	6.2
			20	63	2.1			16	33	7.1	
50AR111/SSP4 CBCP = 50,000	3000	4	14	255	1.0	100AR111/WFL45 CBCP = 2,800	3000	45	4	175	3.3
			16	195	1.1				6	78	5.0
			18	154	1.3				8	44	6.6
			20	125	1.4				10	28	8.3
			22	103	1.5				12	19	9.9
			24	87	1.7						
75AR111/SP8 CBCP = 30,000	3000	8	12	208	1.7						
			14	153	2.0						
			16	117	2.2						
			18	93	2.5						
			20	75	2.8						
			22	62	3.1						

### NOTES

- 1 For electrical characteristics refer to the Technical Bulletins tab.
- 2 Tested to current IES and NEMA standards under stabilized laboratory conditions. Various operating factors can cause differences between laboratory data and actual field measurements. Dimensions and specifications are based on the most current available data and are subject to change without notice.

### DLV-150

©2004 Gotham 12/04  
DLV-150.p65

**gotham**  
An Acuity Brands Company

GOTHAM ARCHITECTURAL DOWNLIGHTING  
A DIVISION OF ACUITY LIGHTING GROUP, INC.  
1400 Lester Road Conyers Georgia 30012  
P 800 315 4982 F 770 860 3129  
www.gothamlighting.com