

FEATURES

OPTICAL SYSTEM

- Self-flanged, semi-specular or matte-diffuse reflector. Patented Vertisys® - Bounding Ray™ Optical Principle design (US Patent #5,800,050) provides lamp before lamp image. Lamp image that reflects smoothly from the top of the reflector to the aperture, providing optimal fixture performance and efficiency.

MECHANICAL SYSTEM

- 16-gauge galvanized steel mounting/plaster frame with friction support clips to retain optical system. Maximum 7/8" ceiling thickness.
- 16-gauge galvanized steel mounting bars with continuous 4" vertical adjustment are shipped pre-installed. Post installation adjustment possible without the use of tools from above or below ceiling.
- Galvanized steel junction box with bottom-hinged access covers and spring latch. Two combination 1/2"-3/4" and three 1/2" knockouts for straight-through conduit runs. Capacity: 8 (4 in, 4 out) No. 12 AWG conductors, rated for 90°C.

ELECTRICAL SYSTEM

- Rugged aluminum lampholder housing.
- Vertically-mounted, positive-latch, thermoplastic socket.
- Class P, thermally protected, high power factor electronic ballast mounted to the junction box.
- Simply5™ technology available. **SIMPLY5™** LIGHTING INTELLIGENCE

LISTING

- Fixtures are UL Listed for thru-branch wiring, Non-IC recessed mounting and damp locations. Listed and labeled to comply with Canadian standards.

Type Catalog number

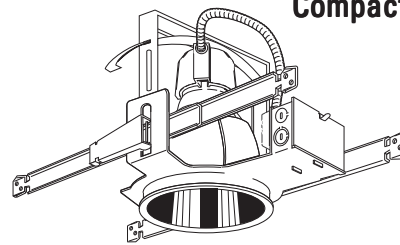

Compact Fluorescent Downlights

5" AFV

Lensed
Vertical Tri-Tube Lamp

Aperture: 5 (12.7)
Ceiling opening: 5-1/2 (14.0)
Overlap/trim: 6-1/4 (15.9)
Lens recess: 2 (5.1)

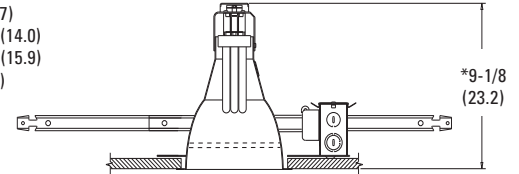

*9-1/8
(23.2)

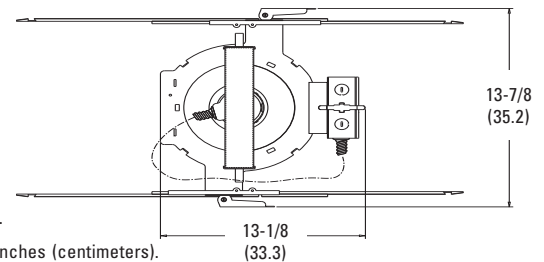

13-7/8
(35.2)

*Maximum height depends on lamp wattage/type, dimensions range from 8-9/16" to 9-1/8".

All dimensions are inches (centimeters).

ORDERING INFORMATION

Example: **AFV26TRT5MB CGL MVOLT WLP**

Choose the boldface catalog nomenclature that best suits your needs and write it on the appropriate line. Order accessories as separate catalog numbers (shipped separately).

AFV		Finish		Lens type		Voltage		Ballast ³		Options	
Series	Wattage/Lamp	Aperture/Trim color									
AFV	18TRT	5AR Clear	(blank)	Semi-specular	(blank)	No lens	MVOLT²	(blank)	Electronic ballast	ELR⁶ Emergency battery pack with remote test switch	
	26TRT	5PR Pewter	LD Matte-diffuse	CGL Clear glass lens	120	ECOS EcoSystem electronic dimming ballast. Minimum dimming level 5%.	277	ELRHL⁶ High lumen output emergency battery pack with remote test switch			
	32TRT	5UBR Umber		PCL Clear polycarbonate lens	347	ADEZ⁴ Advance Mark 10 [®] electronic ballast. Minimum dimming level 5%.	TRW White painted flange (standard on MB and WB)				
		5WTR Wheat				S5⁵ SIMPLY5™ system ballast	GMF⁷ Single, slow-blow fuse				
		5MB¹ Black baffle					GLR⁷ Single, fast-blow fuse				
		5WB¹ White baffle					TRB Black painted flange				

NOTES

- 1 Not available with finishes.
- 2 Multi-volt electronic ballast capable of operating on any line voltage from 120V through 277V, 50 or 60Hz.
- 3 For additional ballast types, refer to Technical Bulletins tab.
- 4 Available in 18W, 26W, 32W or 42W; 120V or 277V only.
- 5 SIMPLY5 includes 9' S5 MLC Reloc wiring system (shipped separately). Available in 26W or 32W; 120V or 277V only. See simply5.net for more information.
- 6 For dimensional changes, refer to Technical Bulletins tab.
- 7 Not available with MVOLT.
- 8 For compatible Reloc systems, refer to Technical Bulletins tab.
- 9 Not available with ELR or ELRHL options.
- 10 Meets codes that require in-fixture disconnect.
- 11 One 5A relay with one 0-10 VDC dimming output, shipped installed. Requires additional nLight bus power supply.

Accessories

Order as separate catalog numbers.

- SCA5** Sloped ceiling adapter. Degree of slope must be specified (10D, 15D, 20D, 25D, 30D). Ex: SCA510D
- CTA5** Ceiling thickness adapter. (Extends mounting frame to accommodate ceiling thickness up to 2".)

5" AFV Lensed

Distribution curve	Distribution data	Output data	Coefficient of utilization	ILLUMINANCE DATA at 30' Above Floor for a Single Luminaire																																																																																					
AFV 26TRT 5AR CGL, (1) PL-T 26W/30/4P lamp, 1800 rated lumens, 1.2 s/mh, Test no. LTL7715																																																																																									
	From 0°	cp. Lumens	Zone Lumens %lamp	<table border="1"> <thead> <tr> <th rowspan="2">pf</th> <th rowspan="2">pc</th> <th rowspan="2">pw</th> <th colspan="2">80%</th> <th colspan="2">20%</th> <th colspan="2">50%</th> </tr> <tr> <th>50%</th> <th>30%</th> <th>50%</th> <th>30%</th> <th>50%</th> <th>30%</th> </tr> </thead> <tbody> <tr><td>1</td><td>45</td><td>44</td><td>44</td><td>42</td><td>41</td><td>41</td></tr> <tr><td>2</td><td>42</td><td>40</td><td>41</td><td>39</td><td>39</td><td>38</td></tr> <tr><td>3</td><td>39</td><td>37</td><td>39</td><td>35</td><td>36</td><td>35</td></tr> <tr><td>4</td><td>36</td><td>34</td><td>37</td><td>33</td><td>34</td><td>32</td></tr> <tr><td>5</td><td>33</td><td>31</td><td>35</td><td>30</td><td>32</td><td>30</td></tr> <tr><td>6</td><td>31</td><td>28</td><td>33</td><td>28</td><td>30</td><td>28</td></tr> <tr><td>7</td><td>29</td><td>26</td><td>31</td><td>26</td><td>28</td><td>26</td></tr> <tr><td>8</td><td>27</td><td>24</td><td>30</td><td>24</td><td>26</td><td>24</td></tr> <tr><td>9</td><td>25</td><td>23</td><td>28</td><td>22</td><td>24</td><td>22</td></tr> <tr><td>10</td><td>24</td><td>21</td><td>27</td><td>21</td><td>23</td><td>21</td></tr> </tbody> </table>	pf	pc	pw	80%		20%		50%		50%	30%	50%	30%	50%	30%	1	45	44	44	42	41	41	2	42	40	41	39	39	38	3	39	37	39	35	36	35	4	36	34	37	33	34	32	5	33	31	35	30	32	30	6	31	28	33	28	30	28	7	29	26	31	26	28	26	8	27	24	30	24	26	24	9	25	23	28	22	24	22	10	24	21	27	21	23	21
	pf	pc	pw	80%				20%		50%																																																																															
				50%	30%	50%	30%	50%	30%																																																																																
	1	45	44	44	42	41	41																																																																																		
	2	42	40	41	39	39	38																																																																																		
	3	39	37	39	35	36	35																																																																																		
	4	36	34	37	33	34	32																																																																																		
	5	33	31	35	30	32	30																																																																																		
	6	31	28	33	28	30	28																																																																																		
	7	29	26	31	26	28	26																																																																																		
	8	27	24	30	24	26	24																																																																																		
9	25	23	28	22	24	22																																																																																			
10	24	21	27	21	23	21																																																																																			
0°	547	0	0°-30° 457 25.4	Mount height	Initial fc at beam center	50% beam angle 61.6°	10% beam angle 86.4°																																																																																		
5°	584	56	0°-40° 686 38.1	8'	18.1	6.5'	9.0	10.3'	1.8																																																																																
15°	586	166	0°-60° 746 41.5	10'	9.7	8.9'	4.9	14.1'	1.0																																																																																
25°	507	235	0°-90° 747 41.5	12'	6.1	11.3'	3.0	17.9'	0.6																																																																																
35°	366	230	90°-180° 0 0.0	14'	4.1	13.7'	2.1	21.6'	0.4																																																																																
45°	74	58	0°-180° 747 41.5*	16'	3.0	16.1'	1.5	25.4'	0.3																																																																																
55°	3	2	*Efficiency																																																																																						
65°	1	1																																																																																							
75°	0	0																																																																																							
85°	0	0																																																																																							
90°	0	0																																																																																							

Distribution curve	Distribution data	Output data	Coefficient of utilization	ILLUMINANCE DATA at 30' Above Floor for a Single Luminaire																																																																																					
AFV 32TRT 5AR CGL, (1) PL-T 32W/30/4P lamp, 2400 rated lumens, 1.2 s/mh, Test no. LTL7716																																																																																									
	From 0°	cp. Lumens	Zone Lumens %lamp	<table border="1"> <thead> <tr> <th rowspan="2">pf</th> <th rowspan="2">pc</th> <th rowspan="2">pw</th> <th colspan="2">80%</th> <th colspan="2">20%</th> <th colspan="2">50%</th> </tr> <tr> <th>50%</th> <th>30%</th> <th>50%</th> <th>30%</th> <th>50%</th> <th>30%</th> </tr> </thead> <tbody> <tr><td>1</td><td>44</td><td>43</td><td>43</td><td>41</td><td>40</td><td>40</td></tr> <tr><td>2</td><td>41</td><td>39</td><td>41</td><td>38</td><td>38</td><td>37</td></tr> <tr><td>3</td><td>38</td><td>36</td><td>38</td><td>35</td><td>35</td><td>34</td></tr> <tr><td>4</td><td>35</td><td>33</td><td>36</td><td>32</td><td>33</td><td>31</td></tr> <tr><td>5</td><td>33</td><td>30</td><td>34</td><td>29</td><td>31</td><td>29</td></tr> <tr><td>6</td><td>30</td><td>28</td><td>32</td><td>27</td><td>29</td><td>27</td></tr> <tr><td>7</td><td>28</td><td>25</td><td>31</td><td>25</td><td>27</td><td>25</td></tr> <tr><td>8</td><td>26</td><td>24</td><td>29</td><td>23</td><td>25</td><td>23</td></tr> <tr><td>9</td><td>25</td><td>22</td><td>27</td><td>22</td><td>24</td><td>21</td></tr> <tr><td>10</td><td>23</td><td>20</td><td>26</td><td>20</td><td>22</td><td>20</td></tr> </tbody> </table>	pf	pc	pw	80%		20%		50%		50%	30%	50%	30%	50%	30%	1	44	43	43	41	40	40	2	41	39	41	38	38	37	3	38	36	38	35	35	34	4	35	33	36	32	33	31	5	33	30	34	29	31	29	6	30	28	32	27	29	27	7	28	25	31	25	27	25	8	26	24	29	23	25	23	9	25	22	27	22	24	21	10	23	20	26	20	22	20
	pf	pc	pw	80%				20%		50%																																																																															
				50%	30%	50%	30%	50%	30%																																																																																
	1	44	43	43	41	40	40																																																																																		
	2	41	39	41	38	38	37																																																																																		
	3	38	36	38	35	35	34																																																																																		
	4	35	33	36	32	33	31																																																																																		
	5	33	30	34	29	31	29																																																																																		
	6	30	28	32	27	29	27																																																																																		
	7	28	25	31	25	27	25																																																																																		
	8	26	24	29	23	25	23																																																																																		
9	25	22	27	22	24	21																																																																																			
10	23	20	26	20	22	20																																																																																			
0°	685	0	0°-30° 580 24.2	Mount height	Initial fc at beam center	50% beam angle 61.8°	10% beam angle 87.6°																																																																																		
5°	750	72	0°-40° 871 36.3	8'	22.6	6.6'	11.3	10.6'	2.2																																																																																
15°	748	212	0°-60° 973 40.5	10'	12.2	9.0'	6.1	14.4'	1.2																																																																																
25°	641	297	0°-90° 981 40.9	12'	7.6	11.4'	3.8	18.2'	0.7																																																																																
35°	464	291	90°-180° 0 0.0	14'	5.2	13.8'	2.6	22.1'	0.5																																																																																
45°	128	99	0°-180° 981 *40.9	16'	3.8	16.1'	1.9	25.9'	0.4																																																																																
55°	3	2	*Efficiency																																																																																						
65°	3	2																																																																																							
75°	4	4																																																																																							
85°	2	3																																																																																							
90°	0	0																																																																																							

Distribution curve	Distribution data	Output data	Coefficient of utilization	ILLUMINANCE DATA at 30' Above Floor for a Single Luminaire																																																																																					
AFV 26TRT 5MB CGL, (1) PL-T 26W/30/4P lamp, 1800 rated lumens, 1.1 s/mh, Test no. LTL7717																																																																																									
	From 0°	cp. Lumens	Zone Lumens %lamp	<table border="1"> <thead> <tr> <th rowspan="2">pf</th> <th rowspan="2">pc</th> <th rowspan="2">pw</th> <th colspan="2">80%</th> <th colspan="2">20%</th> <th colspan="2">50%</th> </tr> <tr> <th>50%</th> <th>30%</th> <th>50%</th> <th>30%</th> <th>50%</th> <th>30%</th> </tr> </thead> <tbody> <tr><td>1</td><td>34</td><td>33</td><td>32</td><td>31</td><td>31</td><td>30</td></tr> <tr><td>2</td><td>31</td><td>30</td><td>31</td><td>29</td><td>29</td><td>28</td></tr> <tr><td>3</td><td>29</td><td>27</td><td>29</td><td>26</td><td>27</td><td>26</td></tr> <tr><td>4</td><td>27</td><td>25</td><td>28</td><td>24</td><td>25</td><td>24</td></tr> <tr><td>5</td><td>25</td><td>23</td><td>26</td><td>22</td><td>24</td><td>22</td></tr> <tr><td>6</td><td>23</td><td>21</td><td>25</td><td>21</td><td>22</td><td>21</td></tr> <tr><td>7</td><td>22</td><td>20</td><td>23</td><td>19</td><td>21</td><td>19</td></tr> <tr><td>8</td><td>20</td><td>18</td><td>22</td><td>18</td><td>19</td><td>18</td></tr> <tr><td>9</td><td>19</td><td>17</td><td>21</td><td>17</td><td>18</td><td>17</td></tr> <tr><td>10</td><td>18</td><td>16</td><td>20</td><td>16</td><td>17</td><td>16</td></tr> </tbody> </table>	pf	pc	pw	80%		20%		50%		50%	30%	50%	30%	50%	30%	1	34	33	32	31	31	30	2	31	30	31	29	29	28	3	29	27	29	26	27	26	4	27	25	28	24	25	24	5	25	23	26	22	24	22	6	23	21	25	21	22	21	7	22	20	23	19	21	19	8	20	18	22	18	19	18	9	19	17	21	17	18	17	10	18	16	20	16	17	16
	pf	pc	pw	80%				20%		50%																																																																															
				50%	30%	50%	30%	50%	30%																																																																																
	1	34	33	32	31	31	30																																																																																		
	2	31	30	31	29	29	28																																																																																		
	3	29	27	29	26	27	26																																																																																		
	4	27	25	28	24	25	24																																																																																		
	5	25	23	26	22	24	22																																																																																		
	6	23	21	25	21	22	21																																																																																		
	7	22	20	23	19	21	19																																																																																		
	8	20	18	22	18	19	18																																																																																		
9	19	17	21	17	18	17																																																																																			
10	18	16	20	16	17	16																																																																																			
0°	454	0	0°-30° 350 19.4	Mount height	Initial fc at beam center	50% beam angle 57.9°	10% beam angle 84.7°																																																																																		
5°	475	45	0°-40° 506 28.1	8'	15.0	6.1'	7.5	10.0'	1.5																																																																																
15°	454	129	0°-60° 556 30.9	10'	8.1	8.3'	4.0	13.7'	0.8																																																																																
25°	380	176	0°-90° 556 30.9	12'	5.0	10.5'	2.5	17.3'	0.5																																																																																
35°	248	156	90°-180° 0 0.0	14'	3.4	12.7'	1.7	21.0'	0.3																																																																																
45°	64	50	0°-180° 556 *30.9	16'	2.5	14.9'	1.2	24.6'	0.2																																																																																
55°	1	0	*Efficiency																																																																																						
65°	0	0																																																																																							
75°	0	0																																																																																							
85°	0	0																																																																																							
90°	0	0																																																																																							

Distribution curve	Distribution data	Output data	Coefficient of utilization	ILLUMINANCE DATA at 30' Above Floor for a Single Luminaire																																																																																					
AFV 32TRT 5MB CGL, (1) PL-T 32W/30/4P lamp, 2400 rated lumens, 1.1 s/mh, Test no. LTL7718																																																																																									
	From 0°	cp. Lumens	Zone Lumens %lamp	<table border="1"> <thead> <tr> <th rowspan="2">pf</th> <th rowspan="2">pc</th> <th rowspan="2">pw</th> <th colspan="2">80%</th> <th colspan="2">20%</th> <th colspan="2">50%</th> </tr> <tr> <th>50%</th> <th>30%</th> <th>50%</th> <th>30%</th> <th>50%</th> <th>30%</th> </tr> </thead> <tbody> <tr><td>1</td><td>31</td><td>30</td><td>30</td><td>29</td><td>28</td><td>28</td></tr> <tr><td>2</td><td>29</td><td>28</td><td>28</td><td>26</td><td>26</td><td>26</td></tr> <tr><td>3</td><td>27</td><td>25</td><td>27</td><td>24</td><td>25</td><td>24</td></tr> <tr><td>4</td><td>25</td><td>23</td><td>25</td><td>22</td><td>23</td><td>22</td></tr> <tr><td>5</td><td>23</td><td>21</td><td>24</td><td>21</td><td>22</td><td>20</td></tr> <tr><td>6</td><td>21</td><td>20</td><td>23</td><td>19</td><td>20</td><td>19</td></tr> <tr><td>7</td><td>20</td><td>18</td><td>22</td><td>18</td><td>19</td><td>18</td></tr> <tr><td>8</td><td>19</td><td>17</td><td>20</td><td>17</td><td>18</td><td>16</td></tr> <tr><td>9</td><td>17</td><td>16</td><td>19</td><td>15</td><td>17</td><td>15</td></tr> <tr><td>10</td><td>16</td><td>15</td><td>18</td><td>14</td><td>16</td><td>14</td></tr> </tbody> </table>	pf	pc	pw	80%		20%		50%		50%	30%	50%	30%	50%	30%	1	31	30	30	29	28	28	2	29	28	28	26	26	26	3	27	25	27	24	25	24	4	25	23	25	22	23	22	5	23	21	24	21	22	20	6	21	20	23	19	20	19	7	20	18	22	18	19	18	8	19	17	20	17	18	16	9	17	16	19	15	17	15	10	16	15	18	14	16	14
	pf	pc	pw	80%				20%		50%																																																																															
				50%	30%	50%	30%	50%	30%																																																																																
	1	31	30	30	29	28	28																																																																																		
	2	29	28	28	26	26	26																																																																																		
	3	27	25	27	24	25	24																																																																																		
	4	25	23	25	22	23	22																																																																																		
	5	23	21	24	21	22	20																																																																																		
	6	21	20	23	19	20	19																																																																																		
	7	20	18	22	18	19	18																																																																																		
	8	19	17	20	17	18	16																																																																																		
9	17	16	19	15	17	15																																																																																			
10	16	15	18	14	16	14																																																																																			
0°	557	0	0°-30° 432 18.0	Mount height	Initial fc at beam center	50% beam angle 57.2°	10% beam angle 84.8°																																																																																		
5°	593	57	0°-40° 620 25.8	8'	18.4	6.0'	9.2	10.0'	1.8																																																																																
15°	567	161	0°-60° 685 28.6	10'	9.9	8.2'	4.9	13.7'	1.0																																																																																
25°	463	214	0°-90° 685 28.6	12'	6.2	10.4'	3.1	17.4'	0.6																																																																																
35°	299	188	90°-180° 0 0.0	14'	4.2	12.5'	2.1	21.0'	0.4																																																																																
45°	84	65	0°-180° 685 28.6*	16'	3.1	14.7'	1.5	24.7'	0.3																																																																																
55°	1	1	*Efficiency																																																																																						
65°	0	0																																																																																							
75°	0	0																																																																																							
85°	0	0																																																																																							
90°	0	0																																																																																							

ENERGY

LER.DOH	Annual Energy Cost	Lamps	Lamp Lumens	Ballast Factor	Input Watts
27	\$8.75	(1) 26TRT	1800	.98	27

Calculated in accordance with NEMA standard LE-5.

NOTES:

- For electrical characteristics consult technical data tab.
- Tested to current IES and NEMA standards under stabilized laboratory conditions. Various operating factors can cause differences between laboratory data and actual field measurements. Dimensions and specifications are based on the most current available data and are subject to change without notice.

DCF-350

©2003-2012 Acuity Brands Lighting, Inc.,
All Rights Reserved. Rev. 03/15/12
Specifications subject to change without notice.



GOTHAM ARCHITECTURAL DOWNLIGHTING
1400 Lester Road Conyers Georgia 30012
P 800 315 4982 F 770 860 3129
www.gothamlighting.com