

FEATURES

OPTICAL SYSTEM

- Self-flanged, semi-specular or matte-diffuse reflector. Patented Vertisys® - Bounding Ray™ Optical Principle design (US Patent #5,800,050) provides lamp before lamp image. Lamp image that reflects smoothly from the top of the reflector to the aperture, providing optimal fixture performance and efficiency.

MECHANICAL SYSTEM

- 16-gauge galvanized steel mounting/plaster frame with friction support clips to retain optical system. Maximum 7/8" ceiling thickness.
- 16-gauge galvanized steel mounting bars with continuous 4" vertical adjustment are shipped pre-installed. Post installation adjustment possible without the use of tools from above or below ceiling.
- Galvanized steel junction box with bottom-hinged access covers and spring latch. Two combination 1/2"-3/4" and three 1/2" knockouts for straight-through conduit runs. Capacity: 8 (4 in, 4 out) No. 12 AWG conductors, rated for 90°C.

ELECTRICAL SYSTEM

- Rugged aluminum lampholder housing.
- Vertically-mounted, positive-latch, thermoplastic socket.
- Class P, thermally protected, high power factor electronic ballast mounted to the junction box.
- Simply5™ technology available. **SIMPLY5™** LIGHTING INTELLIGENCE

LISTING

- Fixtures are UL Listed for thru-branch wiring, Non-IC recessed mounting and damp locations. Listed and labeled to comply with Canadian Standards.

Type

Catalog number

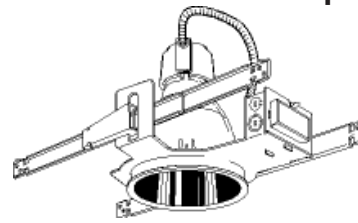

Compact Fluorescent Downlights

8" AFV

Open Reflector
Vertical Double Twin-Tube or
Triple-Tube Lamp

Aperture: 7-7/8 (20.1)
Ceiling opening: 8-7/8 (21.5)
Overlap trim: 9-1/4 (23.5)

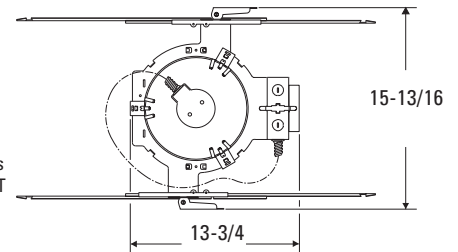
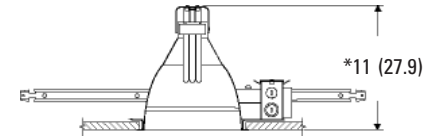

*Maximum height depends on lamp wattage/type, dimensions range from 11" for 18DTT, 26DTT and 42TRT; 10-1/8" for 13DTT, 18TRT, 26TRT and 32TRT.

All dimensions are inches (centimeters)

ORDERING INFORMATION

Choose the boldface catalog nomenclature that best suits your needs and write it on the appropriate line. Order accessories as separate catalog numbers (shipped separately).

Example: **AFV 32TRT 8AR MVOLT WLP**

AFV											
Series	Wattage/Lamp	Aperture/Trim color		Finish	Voltage	Ballast ³		Options			
AFV				(blank)	MVOLT²	(blank)	Electronic ballast	EL⁶	Emergency battery pack with integral test switch		
	13DTT	8AR	Clear	Semi-specular	120	ECOS⁴	EcoSystem electronic dimming ballast. Minimum dimming level 5%.	ELHL⁶	High lumen output emergency battery pack with integral test switch		
	18DTT	8PR	Pewter	LD Matte-diffuse	277	ADEZ^{4,7}	Advance Mark 10 [®] electronic ballast. Minimum dimming level 5%	ELR⁶	Emergency battery pack with remote test switch		
	26DTT	8UBR	Umber		347	S5⁵	SIMPLY5™ system ballast	ELRHL⁶	High lumen output emergency battery pack with remote test switch		
	18TRT	8WTR	Wheat					ELRB94	B94 remote emergency battery pack		
	26TRT	8WR¹	White painted					GMF⁷	Single, slow-blow fuse		
	32TRT	8MB¹	Black baffle					GLR⁷	Single, fast-blow fuse		
	42TRT	8WB¹	White baffle					TRW	White painted flange (standard on MB and WB)		

NOTES:

- 1 Not available with finishes.
- 2 Multi-volt electronic ballast capable of operating on any line voltage from 120V through 277V, 50 or 60Hz.
- 3 For additional ballast types, refer to Technical Bulletins tab.
- 4 Available in 18W, 26W, 32W or 42W.
- 5 SIMPLY5 includes 9' S5 MLC Reloc wiring system (shipped separately). Available in 26W, 32W or 42W; 120V or 277V only. See simply5.net for more information.
- 6 For dimensional changes, refer to Technical Bulletins tab.
- 7 Not available with MVOLT.
- 8 For compatible Reloc systems, refer to Technical Bulletins tab.
- 9 Not available with EL, ELHL, ELR or ELRHL options.
- 10 Meets codes that require in-fixture disconnect.
- 11 One 5A relay with one 0-10 VDC dimming output, shipped installed. Requires additional nLight bus power supply.

Accessories

- Order as separate catalog numbers.
- SCA8** Sloped ceiling adapter. Degree of slope must be specified (10D, 15D, 20D, 25D, 30D). Ex: SCA8 10D
 - CTA860** Ceiling thickness adapter. (Extends mounting frame to accommodate ceiling thickness up to 2")

8" AFV Open Reflector

Distribution curve	Distribution data	Output data	Coefficient of utilization	Illuminance Data at 30' Above Floor for a Single Luminaire																
AFV 26TRT 8AR, (1) PL-T 26W/30/4P lamp, 1800 rated lumens, 1.3 s/mh, test no. 2194021601																				
	From 0°	cp.	Lumens	Zone	Lumens	%lamp	pf	80%		20%		Mount height	Initial fc at beam center	50% beam angle 64.0°		10% beam angle 93.8°				
	0°			0°-30°			pc	50%	30%	50%	30%			50%	30%	Beam diameter	fc at beam edge	Beam diameter	fc at beam edge	
	180	0°	830		0°-30°	682	37.9	1	83	81	82	80	78	77	8'	27.5	6.9'	13.7	11.8'	2.7
	360	5°	870	84	0°-40°	1071	59.5	2	78	75	76	74	74	72	10'	14.8	9.4'	7.4	16.0'	1.5
	540	15°	876	247	0°-60°	1349	75.0	3	72	68	71	68	69	66	12'	9.2	11.9'	4.6	20.3'	0.9
	720	25°	762	353	0°-90°	1349	75.0	4	67	63	66	63	65	62	14'	6.3	14.4'	3.1	24.6'	0.6
	900	35°	630	390	90°-180°	0	0.0	5	63	58	62	58	60	57	16'	4.6	16.9'	2.3	28.9'	0.5
		45°	354	255	0°-180°	1349	75.0*	6	58	54	58	53	56	53						
		55°	5	24	*Efficiency			7	54	49	53	49	52	48						
		65°	0	1				8	50	45	49	45	48	44						
		75°	0	1				9	46	41	45	43	45	40						
	85°	0	1				10	42	37	42	37	41	37							
	90°	0																		

AFV 32TRT 8AR, (1) PL-T 32W/30/4P lamp, 2400 rated lumens, 1.1 s/mh, test no. 2194021402																				
	From 0°	cp.	Lumens	Zone	Lumens	%lamp	pf	80%		20%		Mount height	Initial fc at beam center	50% beam angle 55.3°		10% beam angle 87.6°				
	0°			0°-30°			pc	50%	30%	50%	30%			50%	30%	Beam diameter	fc at beam edge	Beam diameter	fc at beam edge	
	300	0°	1344		0°-30°	998	41.6	1	78	77	77	75	74	73	8'	44.5	5.8'	22.2	10.5'	4.4
	600	5°	1440	137	0°-40°	1457	60.7	2	73	71	72	70	70	68	10'	23.9	7.9'	12.0	14.4'	2.4
	900	15°	1360	382	0°-60°	1682	70.1	3	69	66	68	65	66	64	12'	14.9	9.9'	7.4	18.2'	1.5
	1200	25°	1036	481	0°-90°	1683	70.1	4	65	61	64	61	63	60	14'	10.2	12.0'	5.1	22.1'	1.0
	1500	35°	737	460	90°-180°	0	0.0	5	61	57	60	56	59	56	16'	7.4	14.1'	3.7	25.9'	0.7
		45°	280	219	0°-180°	1683	70.1*	6	57	53	57	53	55	52						
		55°	4	7	*Efficiency			7	53	49	53	49	52	49						
		65°	1	1				8	50	46	49	46	49	45						
		75°	0	1				9	47	43	46	42	46	42						
	85°	0	1				10	43	39	43	39	43	39							
	90°	0																		

AFV 42TRT 8AR, (1) PL-T 42W/30/4P lamp, 3200 rated lumens, 1.0 s/mh, test no. 2195121902																				
	From 0°	cp.	Lumens	Zone	Lumens	%lamp	pf	80%		20%		Mount height	Initial fc at beam center	50% beam angle 53.7°		10% beam angle 85.6°				
	0°			0°-30°			pc	50%	30%	50%	30%			50%	30%	Beam diameter	fc at beam edge	Beam diameter	fc at beam edge	
	400	0°	1568		0°-30°	1097	34.3	1	63	61	61	60	59	58	8'	51.8	5.6'	25.9	10.2'	5.2
	800	5°	1705	162	0°-40°	1602	50.1	2	58	55	57	55	55	53	10'	27.9	7.6'	13.9	13.9'	2.8
	1200	15°	1467	407	0°-60°	1808	56.5	3	54	51	53	50	51	49	12'	17.4	9.6'	8.7	17.6'	1.7
	1600	25°	1145	527	0°-90°	1817	56.8	4	50	46	49	46	48	45	14'	11.9	11.7'	5.9	21.3'	1.2
	2000	35°	821	505	90°-180°	0	0.0	5	46	43	46	42	45	42	16'	8.6	13.7'	4.3	25.0'	0.9
		45°	244	198	0°-180°	1817	56.8*	6	43	40	43	39	42	39						
		55°	10	8	*Efficiency			7	40	37	40	36	39	36						
		65°	4	4				8	38	34	37	34	37	34						
		75°	2	3				9	35	32	35	32	34	31						
	85°	2	2				10	33	30	33	30	32	29							
	90°	0																		

AFV 32TRT 8MB, (1) PL-T 32W/30/4P lamp, 2400 rated lumens, 1.0 s/mh, test no. 2196071102																				
	From 0°	cp.	Lumens	Zone	Lumens	%lamp	pf	80%		20%		Mount height	Initial fc at beam center	50% beam angle 50.8°		10% beam angle 84.2°				
	0°			0°-30°			pc	50%	30%	50%	30%			50%	30%	Beam diameter	fc at beam edge	Beam diameter	fc at beam edge	
	300	0°	1182		0°-30°	819	34.1	1	60	59	59	58	57	56	8'	39.1	5.2'	19.5	9.9'	3.9
	600	5°	1279	120	0°-40°	1147	47.8	2	57	55	56	54	54	53	10'	21.0	7.1'	10.5	13.6'	2.1
	900	15°	1157	322	0°-60°	1291	53.8	3	53	51	53	50	51	49	12'	13.1	9.0'	6.6	17.2'	1.3
	1200	25°	812	378	0°-90°	1291	53.8	4	50	48	50	47	49	47	14'	8.9	10.9'	4.5	20.8'	0.9
	1500	35°	525	329	90°-180°	0	0.0	5	47	44	47	44	46	44	16'	6.5	12.8'	3.2	24.4'	0.6
		45°	176	141	0°-180°	1291	53.8*	6	45	42	44	42	44	41						
		55°	2	4	*Efficiency			7	42	39	42	39	41	38						
		65°	0	1				8	39	37	39	36	39	36						
		75°	0	1				9	37	34	37	34	36	34						
	85°	0	1				10	35	32	35	32	34	31							
	90°	0																		

ENERGY (Calculated in accordance with NEMA standard LE-5A)					
LER,DOH	Annual* Energy Cost	Lamps	Lamp Lumens	Ballast Factor	Input Watts
40	\$5.99	(1) 26W DTT	1800	1.00	28
48	\$4.98	(1) 26W DTT	1800	1.00	28
46	\$5.24	(2) 32W TRT	2400	0.98	36
40	\$6.07	(2) 42W TRT	3200	1.00	46

*Comparative yearly lighting energy cost per 1000 lumens

NOTES:

- For electrical characteristics consult Technical Bulletins tab.
- Tested to current IES and NEMA standards under stabilized laboratory conditions. Various operating factors can cause differences between laboratory data and actual field measurements. Dimensions and specifications are based on the most current available data and are subject to change without notice.

DCF-400

©2007, 2011 Acuity Brands Lighting.
All Rights Reserved

gotham
An Acuity Brands Company

GOTHAM ARCHITECTURAL DOWNLIGHTING
1400 Lester Road Conyers Georgia 30012
P 800 315 4982 F 770 860 3129
www.gothamlighting.com