

# FEATURES

## OPTICAL SYSTEM

- Aluminum upper reflector coated with highly reflective white paint provides high efficiency and an evenly illuminated aperture appearance.
- Available with tempered prismatic lens (T73), flat Fresnel lens (FFL) or flat opal lens (FOL).
- Regressed white door (RW) or stepped black baffle (SB) are available with white painted flange provided.
- Door is retained by self-aligning, torsion support springs, preventing gaps between door and ceiling.

## MECHANICAL SYSTEM

- Pre-wired galvanized steel junction box mounted to reflector is provided with removable access cover. No. 12 AWG conductors rated for 90°C.
- Three (3) swinggate brackets allow for installation from below the ceiling. Suitable for ceiling thickness ranging from 1.59cm (5/8") to 2.54cm (1").

## ELECTRICAL SYSTEM

- Galvanized steel lampholder housing.
- Horizontally-mounted, four-pin, positive-latch, thermoplastic socket.
- Thermally protected, high power factor electronic ballast (50/60Hz) mounted to the junction box.
- Eurostyle terminal block included for power supply and ground connections required for CE.

## LISTING

- MVOLT, 120V and 277V fixtures are UL Listed, Non-IC recessed mounting and wet locations. 220V and 240V fixtures are CE certified and rated IP44.

Type

Catalog number



UL Listed

International

Compact Fluorescent Downlights

# LGFI

15.2cm (6")

Round Lens

DTT or TRT Wet Location  
Horizontal Lamp

CE Certified

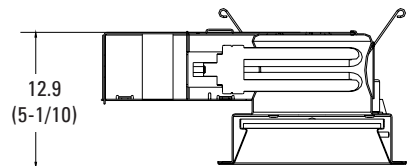
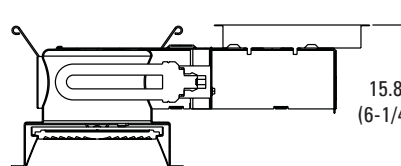
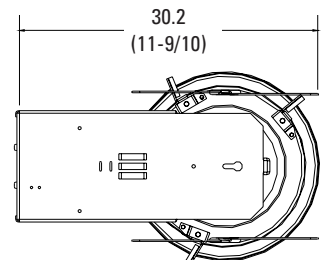
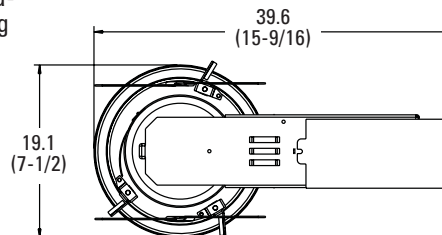

All dimensions are centimeters (inches)

Aperture: 15.9 (6-1/4)  
Ceiling Opening: 16.8 (6-5/8)  
Overlap Trim: 19.1 (7-1/2)

# ORDERING INFORMATION

Example: **LGFI 1/26TRT 6RW T73 220**

Choose the boldface catalog nomenclature that best suits your needs and write it on the appropriate line. Order accessories as separate catalog numbers (shipped separately).

## LGFI

Series	Wattage/ Lamp	Aperture/Trim	Lens	Ballast	Options
LGFI	1/13DTT 1/18DTT 1/26DTT 1/13TRT 1/18TRT 1/26TRT 1/32TRT 1/42TRT	6RW Regressed white door 6SB Stepped black baffle 6RA Regressed anodized	T73 Tempered prismatic lens FFL Flat Fresnel lens FOL Flat opal lens PPC Prismatic polycarbonate lens	(blank) Electronic ballast ADEZ <sup>4</sup> Advance Mark 10™ electronic dimming ballast. Minimum dimming level 5% ADZT <sup>4</sup> Advance Mark 7™ electronic 0-10V DC dimming ballast. Minimum dimming level 3% ECOS Lutron EcoSystem™ electronic dimming ballast. Minimum dimming level 5% VDB <sup>5</sup> Vossloh 0-10V dimming ballast	TRDA Tamper-Resistant Door Assembly With 3500°K lamp (shipped separately) GSKT Foam gasketing, ships uninstalled
				<b>Voltage</b>	
				MVOLT <sup>1,3</sup> 120 <sup>3</sup> 220 <sup>2</sup> 240 <sup>2</sup> 277 <sup>3</sup>	

## NOTES

- 1 Multi-volt electronic ballast capable of operating on any line voltage from 120 through 277V, 50 or 60Hz.
- 2 Available with CE listing only. 220-240V, 50/ 60 Hz.
- 3 Available with UL listing only. 120-277V, 50/60Hz.
- 4 Available with 120V or 277V only.
- 5 Available with 220V or 240V only.

# 15.2cm (6") LGFI Round Lens

Distribution curve    Distribution data    Output data    Coefficient of utilization    Illuminance Data at 30" Above Floor for a Single Luminaire

## LGFI 1/32TRT 6RW T73, 32TRT lamp, 1.1 s/mh, 2400 rated lumens, Test no. LTL14212

From 0°	Ave	Lumens	Zone	Lumens	% Lamp	pf	Coefficient of utilization						Illuminance Data at 30" Above Floor for a Single Luminaire							
							80%		20%		50%		50% beam angle		10% beam angle					
							50%	30%	50%	30%	50%	30%	57.9°	93.8°	57.9°	93.8°				
0	760		0° - 30°	562.1	23.4	pc														
5	758	72	0° - 40°	848.1	35.3	pw	.57	.55	.56	.54	.54	.52	Initial fc							
15	724	203	0° - 60°	1176.6	49.0		.52	.49	.51	.48	.49	.47	Mount at beam							
25	627	287	0° - 90°	1271.4	53.0		.47	.43	.46	.43	.44	.42	height	center	Beam diameter	fc at beam edge	Beam diameter	fc at beam edge		
35	460	286	90° - 180°	0.0	0.0		.42	.39	.42	.38	.40	.37	8	25.1	6.1	12.6	11.7	2.5		
45	270	209	0° - 180°	1271.4	*53.0		.39	.35	.38	.34	.37	.34	10	13.5	8.3	6.8	16.0	1.4		
55	130	119	*E efficiency				.35	.31	.35	.31	.34	.31	12	8.4	10.5	4.2	20.3	0.8		
65	62	62					.33	.29	.32	.28	.31	.28	14	5.7	12.7	2.9	24.6	0.6		
75	23	26					.30	.26	.30	.26	.29	.26	16	4.2	14.9	2.1	28.8	0.4		
85	6	6					.28	.24	.28	.24	.27	.24								
90	0						.26	.22	.26	.22	.25	.22								

## LGFI 1/32TRT 6RW FFL, 32TRT lamp, 1.1 s/mh, 2400 rated lumens, Test no. LTL14213

From 0°	Ave	Lumens	Zone	Lumens	% Lamp	pf	Coefficient of utilization						Illuminance Data at 30" Above Floor for a Single Luminaire							
							80%		20%		50%		50% beam angle		10% beam angle					
							50%	30%	50%	30%	50%	30%	55.8°	94.0°	55.8°	94.0°				
0	848		0° - 30°	608.8	25.4	pc														
5	855	81	0° - 40°	911.3	38.0	pw	.63	.61	.62	.60	.59	.58	Initial fc							
15	800	224	0° - 60°	1288.2	53.7		.57	.54	.56	.53	.54	.51	Mount at beam							
25	661	304	0° - 90°	1410.0	58.7		.51	.47	.50	.47	.49	.46	height	center	Beam diameter	fc at beam edge	Beam diameter	fc at beam edge		
35	487	303	90° - 180°	0.0	0.0		.47	.42	.46	.42	.44	.41	8	28.0	5.8	14.0	11.8	2.8		
45	296	229	0° - 180°	1410.0	*58.7		.42	.38	.42	.38	.41	.37	10	15.1	7.9	7.5	16.1	1.5		
55	163	148	*E efficiency				.39	.34	.38	.34	.37	.34	12	9.4	10.1	4.7	20.4	0.9		
65	82	82					.36	.31	.35	.31	.34	.31	14	6.4	12.2	3.2	24.7	0.6		
75	30	33					.33	.29	.33	.28	.32	.28	16	4.7	14.3	2.3	28.9	0.5		
85	7	8					.31	.26	.30	.26	.30	.26								
90	0						.29	.24	.28	.24	.28	.24								

NOTES:  
 1. For electrical characteristics consult Technical Bulletins tab.  
 2. Tested to current IES and NEMA standards under stabilized laboratory conditions. Various operating factors can cause differences between laboratory data and actual field measurements. Dimensions and specifications are based on the most current available data and are subject to change without notice.

DCF-490-I

©2010 Acuity Brands Lighting, Inc. All Rights Reserved.  
 Rev. 6/11



GOTHAM ARCHITECTURAL DOWNLIGHTING  
 1400 Lester Road Conyers Georgia 30012  
 P 800 315 4982 F 770 860 3129  
 www.gothamlighting.com