

FEATURES

OPTICAL SYSTEM

- Reflector – Self-flanged, semi-specular or matte-diffuse reflector. Patented Bounding Ray™ Optical Principle design (U.S. Patent No. 5,800,050) provides lamp before lamp image and smooth transition from top of reflector to bottom. Minimum flange matches reflector finish.
- Wallwash – Highly reflective outer kicker reflector provides smooth, uniform illumination floor to ceiling, edge to edge. Inner cone is contoured to eliminate room side flash. For optimal uniformity, the recommended luminaire spacing is 0.9m (3') from the wall and 0.9m (3') centers.

MECHANICAL SYSTEM

- Galvanized steel junction box is mounted to reflector with hinge mechanism. Knockouts provided for power supply feed. No. 12 AWG conductors, rated for 90°C.
- Three (3) swinggate brackets allow for installation from below the ceiling. Suitable for ceiling thickness ranging from 1.59cm (5/8") to 2.54cm (1").

ELECTRICAL SYSTEM

- Die-cast aluminum lampholder housing.
- Medium-base porcelain socket with nickel-plated screw shell.
- Prewired electronic ballast standard. Eurostyle terminal block included for power supply and ground connections required for CE.

LISTING

- 120V and 277V fixtures are UL Listed, Non-IC recessed mounting and damp locations. 220V and 240V fixtures are CE certified and rated IP20.

Type Catalog number

.....



International
HID Downlights/Wallwash
AH/AHWI
 15.2cm (6")
 Open/Wallwash Reflector
 Metal Halide Lamp

ULLISTED

CE CERTIFIED

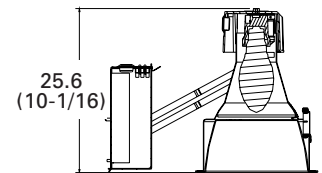
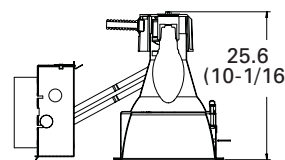
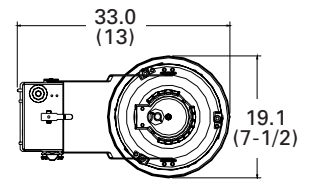
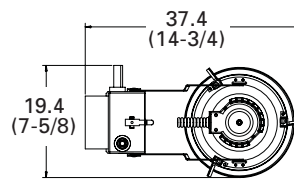

Aperture: 15.9 (6-1/4)
 Ceiling opening: 17.5 (6-7/8)
 Overlap trim: 19.1 (7-1/2)

All dimensions are centimeters (inches).

ORDERING INFORMATION

Example: **AHI 100M 6AR 220 TRW**

Choose the boldface catalog nomenclature that best suits your needs and write it on the appropriate line. Order accessories as separate catalog numbers (shipped separately).

Series	Wattage/Lamp ¹	Aperture/Trim color	Finish	Voltage	Lens type ^{4,5}	Options
AHI	Color-Corrected	6AR Clear	(blank) Semi-specular	120	(blank) No lens	TRW White painted flange.
AHWI	Metal Halide^{1,2}	6PR Pewter	LD Matte-diffuse	220	CGL Clear glass lens	SF Single fuse
	70MHC	6WTR Wheat		240	T73 Tempered prismatic lens	TRBL Black painted flange
	100MHC	6BC^{3,5} Black cone		277		GSKT Foam gasketing
						WLP With 3000°K lamp (shipped separately)

NOTES

- 1 Recommended for use with coated lamps.
- 2 Ceramic arc tube consistent-color lamp.
- 3 Not available with finishes.
- 4 Required for use with enclosed rated lamps.
- 5 AHI only.



GOTHAM ARCHITECTURAL DOWNLIGHTING
 1400 Lester Road Conyers Georgia 30012
 P 800 315 4982 F 770 860 3129
 www.gothamlighting.com

AHI/AHWI 6 OPEN

DHID-120-I

6" AHI/AHWI Open Reflector

Distribution curve

Distribution data

Output data

Coefficient of utilization

Illuminance Data at 30" Above Floor for a Single Luminaire

AHI 70MHC 6AR, (1) MPC70/C/U/MED lamp, 5800 rated lumens, 1.2 s/mh, Test no. LTL7956

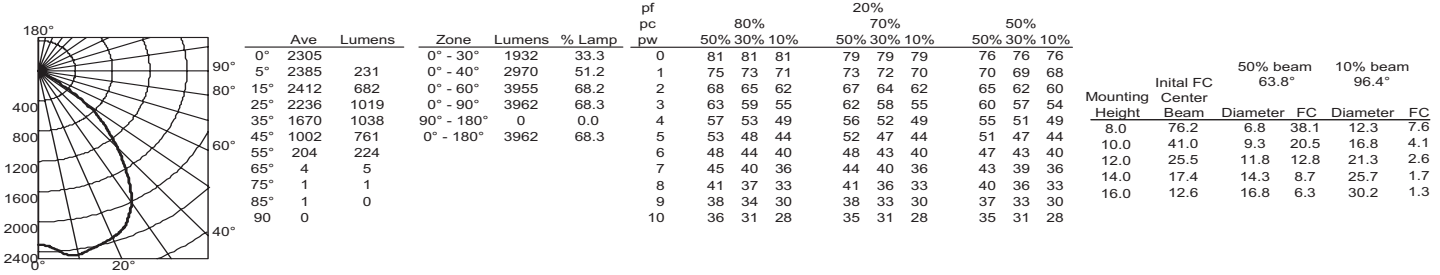

AHI 100MHC 6AR, (1) MPC100/C/U/MED lamp, 8700 rated lumens, 1.2 s/mh, Test no. LTL7955

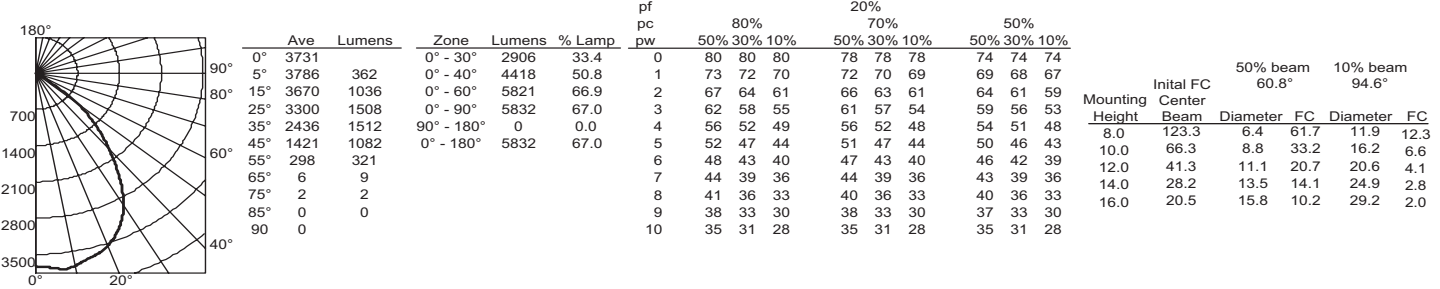

AHI 70MHC 6AR CGL, (1) MHC70/C/U/MED lamp, 5800 rated lumens, 1.2 s/mh, Test no. LTL8009

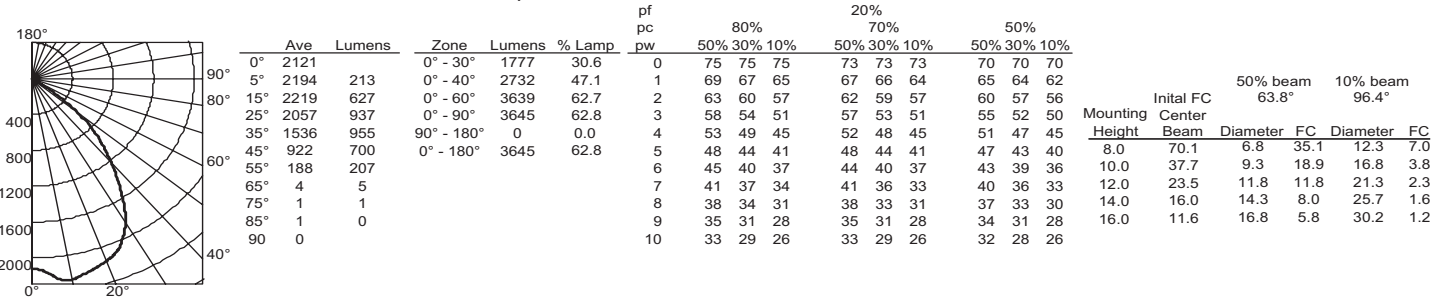

AHI 100MHC 6AR CGL, (1) MHC100/C/U/MED lamp, 8700 rated lumens, 1.2 s/mh, Test no. LTL8008

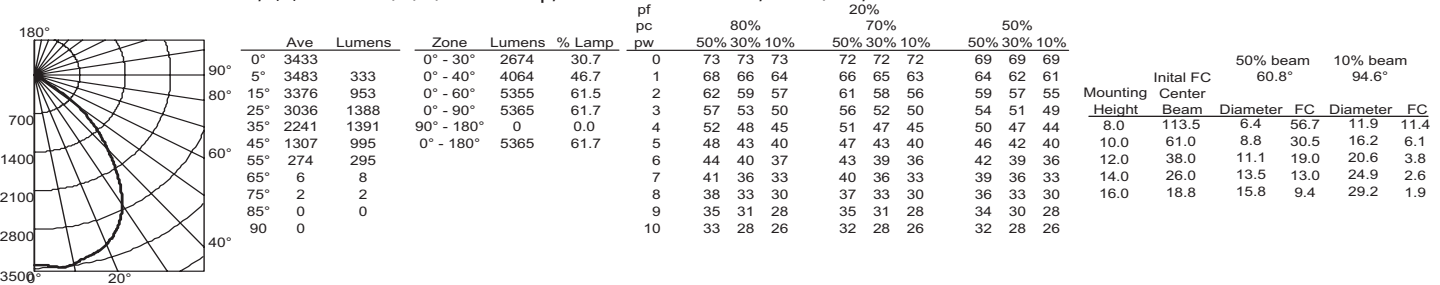

ENERGY (Calculated in accordance with NEMA standard LE-5A)

LER.DOL	Annual* Energy Cost	Lamps	Lamp Lumens	Ballast Factor	Input Watts
51	\$4.73	(1) 70MHC	5800	1.0	78
53	\$4.53	(1) 100MHC	8700	1.0	110

*Comparative yearly lighting energy cost per 1000 lumens

NOTES:

- For electrical characteristics consult Technical Bulletins tab.
- Tested to current IES and NEMA standards under stabilized laboratory conditions. Various operating factors can cause differences between laboratory data and actual field measurements. Dimensions and specifications are based on the most current available data and are subject to change without notice.

DHID-120-I

©2009 Acuity Brands Lighting, Inc. All Rights Reserved.
Rev. 5/10

gotham
An Acuity Brands Company

GOTHAM ARCHITECTURAL DOWNLIGHTING
1400 Lester Road Conyers Georgia 30012
P 800 315 4982 F 770 860 3129
www.gothamlighting.com