

FEATURES

OPTICAL SYSTEM

- Reflector – Self-flanged, semi-specular, matte-diffuse or specular reflector. Patented Bounding Ray™ Optical Principle design (U.S. Patent No. 5,800,050) provides lamp before lamp image and smooth transition from top of reflector to bottom. Minimum flange matches reflector finish.
- Wallwash – Highly reflective outer kicker reflector provides smooth, uniform illumination floor to ceiling, edge to edge. Inner cone is contoured to eliminate room side flash. For optimal uniformity, the recommended luminaire spacing is 0.9m (3') from the wall and 0.9m (3') centers.

MECHANICAL SYSTEM

- Galvanized steel junction box is mounted to reflector with hinge mechanism. Knockouts provided for power supply feed. No. 12 AWG conductors, rated for 90°C.
- Three (3) swinggate brackets allow for installation below the ceiling. Suitable for ceiling thickness ranging from 1.59cm (5/8") to 2.54cm (1").

ELECTRICAL SYSTEM

- Die-cast aluminum lampholder housing.
- Medium-base porcelain socket with nickel-plated screw shell.
- Eurostyle terminal block included for power supply and ground connections required for CE.

LISTING

- 120V fixtures are UL Listed, Non-IC recessed mounting and damp locations. 240V fixtures are CE certified and rated IP20.

Type Catalog number



International
Incandescent Downlight/Wallwash
AII/AWI
 20.3cm (8")
 Open/Wallwash Reflector

UL LISTED

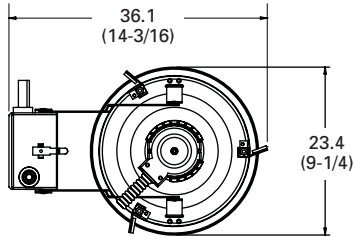

CE CERTIFIED

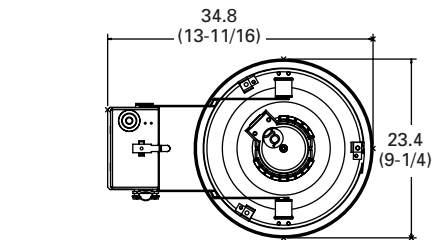

Aperture: 20.0 (7-7/8)
 Ceiling opening: 21.9 (8-5/8)
 Overlap trim: 23.5 (9-1/4)

All dimensions are centimeters (inches).

ORDERING INFORMATION

Example: **AII 8AR 120**

Choose the boldface catalog nomenclature that best suits your needs and write it on the appropriate line. Order accessories as separate catalog numbers (shipped separately).

Series ¹	Aperture/Trim color	Finish	Lens Type ⁴	Voltage	Options
AII	8AR Clear	(blank) Semi-specular	(blank) No lens	120 UL Listed	SF Single fuse
AWI	8PR Pewter	LD Matte-diffuse	CGL Clear glass lens	240 CE Certified	TRW³ White painted flange
	8WTR Wheat	LS Specular	T73 Tempered prismatic lens		TRBL Black painted flange
	8GR Gold				GSKT Foam gasketing
	8WC^{2,4} White painted				
	8BC^{2,4} Black cone				

NOTES

- 1 Maximum wattage: 200W
- 2 Not available with finishes.
- 3 Standard on 8WC.
- 4 All only.

8" AII/AWI Open Reflector

Distribution curve Distribution data Output data Coefficient of utilization Illuminance Data at 30" Above Floor for a Single Luminaire

AII 8AR (150 A21), (1) 150A lamp, 2780 rated lumens, 1.2 s/mh, Test no. LTL7618

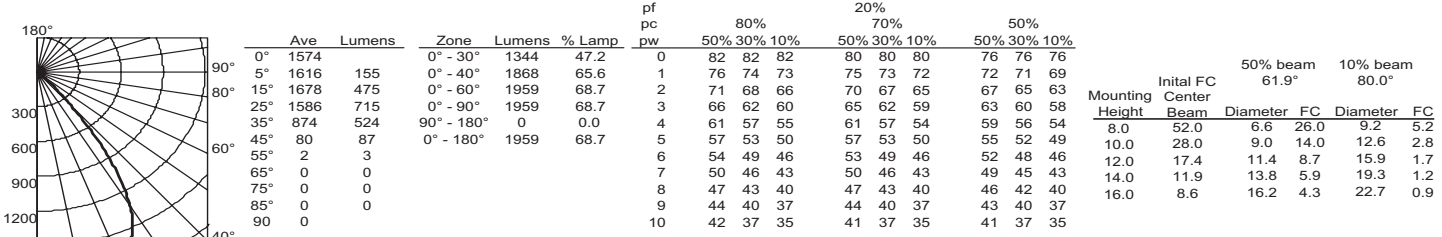

AII 8AR (200 A23), (1) 200A lamp, 3930 rated lumens, 1.1 s/mh, Test no. LTL8058

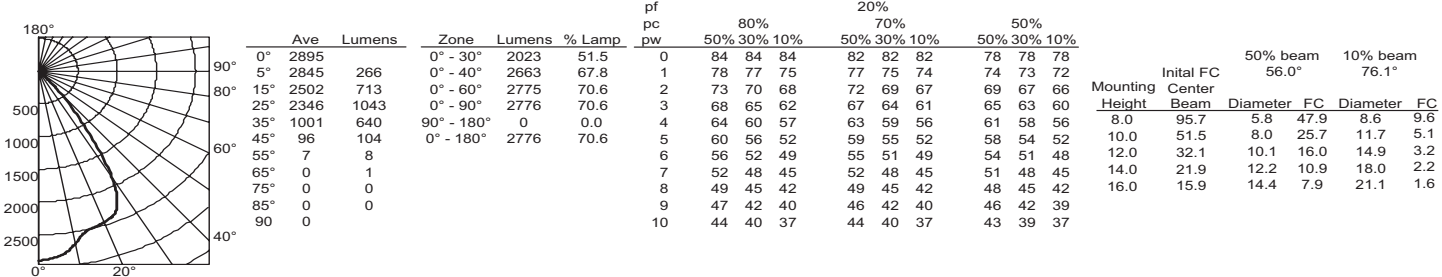

AII 8AR GL (150 A21), (1) 150A lamp, 2780 rated lumens, 1.2 s/mh, Test no. LTL7760

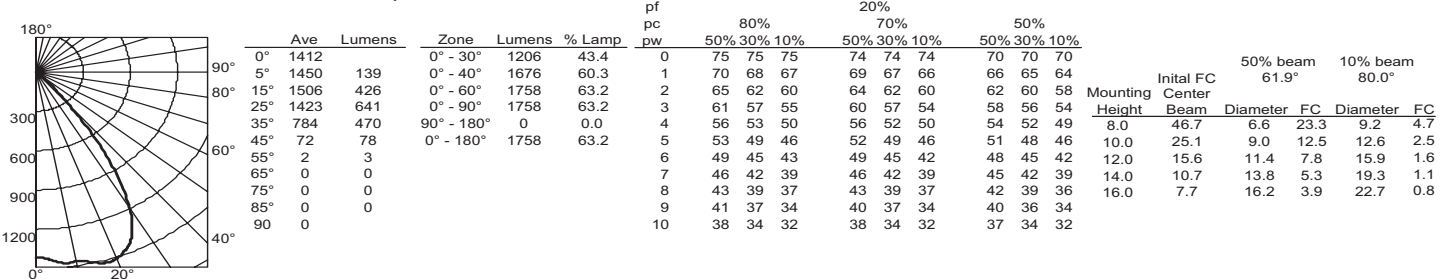

AII 8AR GL (200 A23), (1) 200A lamp, 3930 rated lumens, 1.1 s/mh, Test no. LTL8091

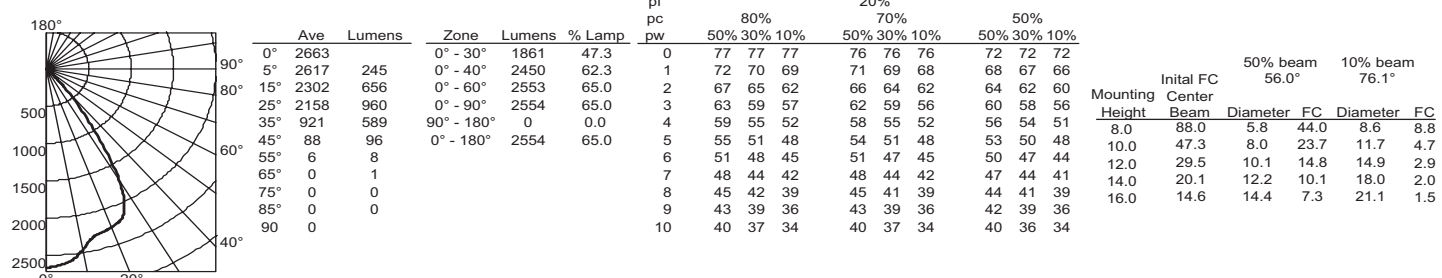

ENERGY (Calculated in accordance with NEMA standard LE-5A)					
LER.DOL	Annual* Energy Cost	Lamps	Lamp Lumens	Ballast Factor	Input Watts
12	\$20.67	(1) 100W A19	1710	N/A	100
13	\$18.58	(1) 150W A21	2850	N/A	150

*Comparative yearly lighting energy cost per 1000 lumens

NOTES:
 1. For electrical characteristics consult Technical Bulletins tab.
 2. Tested to current IES and NEMA standards under stabilized laboratory conditions. Various operating factors can cause differences between laboratory data and actual field measurements. Dimensions and specifications are based on the most current available data and are subject to change without notice.