

FEATURES

OPTICAL SYSTEM

- Aluminum upper reflector coated with highly reflective white paint provides high efficiency and an evenly illuminated aperture appearance.
- Available with tempered prismatic lens (T73), flat Fresnel lens (FFL) and flat opal lens (FOL).
- Regressed white door (RW) or stepped black baffle (SB) are provided with white painted flange provided.
- Door is retained by self-aligning, torsion support springs, preventing gaps between door and cylinder.

HOUSING

- Heavy gauge, aluminum housing with top deck for clean appearance. Provided with safety chain on ceiling and pendant units allowing hands-free wiring connections. Matte white textured polyester powder paint finish standard.

MOUNTING

- Ceiling mount provided with mounting pattern for direct installation to 4" octagonal or square junction box.
- Wall mount provided with mounting pattern for direct installation to 4" octagonal or square junction box.
- Pendant mount entry provided for 3/8" National Pipe Thread stem. Additional pendant options available (see accessories). Wires supplied by others.

ELECTRICAL SYSTEM

- Medium-base porcelain socket with nickel-plated screw shell.
- Removable, pre-wired, 120 or 277V, 50/60Hz electronic ballast module standard.

LISTING

- Fixtures are listed and labeled to comply with US and Canadian standards. Wall mount suitable for wet locations. Ceiling and pendant mount suitable for wet locations in covered ceiling installations only.

Type Catalog number

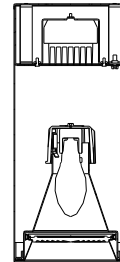
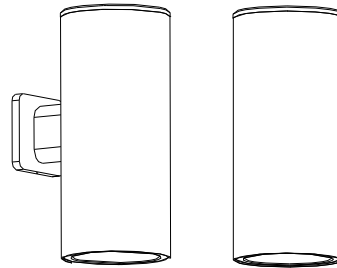

HID Surface Downlights 8" CHL

Enclosed Wet Location Cylinder
Metal Halide

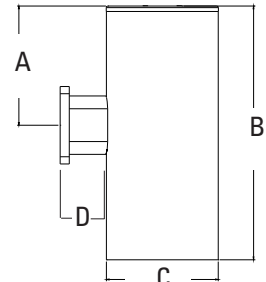

A: 8-5/32 (20.7)
B: 17-3/8 (44.1)
C: 7-5/8 (19.4)
D: 3-1/8 (7.9)

Wall Mount Bracket

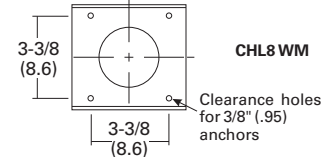

Aperture: 6-1/4 (15.9)
Housing Diameter: 7-5/8 (19.4)
Housing Height: 17-3/8 (44.1)

All dimensions are inches
(centimeters).

ORDERING INFORMATION

Example: **CHL870MHC6RW T73 MVOLT FCM DWHG**

Choose the boldface catalog nomenclature that best suits your needs and write it on the appropriate line.

CHL8		Aperture/Trim color		Voltage	Mounting	Options
Series	Wattage/lamp¹	6RW	Regressed white door	MVOLT²	FCM Ceiling mount	SF⁴ Single fuse
CHL8	Metal Halide			120	WM Wall mount	WLP Lamp (shipped separately)
	50M MED	6SB	Stepped black baffle	277	PM Pendant 3/8" thread mount	Housing Colors⁵
	70M MED			347³		DWHG Matte white (standard)
	Color-Corrected Metal Halide²			Lens Type		DDB Dark bronze
	50MHC MED			T73 Tempered prismatic lens		DBL Black
	70MHC MED			FFL Flat Fresnel lens		DWH Gloss white
				FOL Flat opal lens		DMB Medium bronze
						DNA Natural aluminum
						DSS Sandstone
						DGC Charcoal gray
						DTG Tennis green
						DBR Bright red
						DSB Steel blue

NOTES

- Recommended for use with coated lamps.
- Ceramic ARC tube consistent-color lamp. Phillips Mastercolor or GE Constant Color.
- Only available 70W.
- Must specify 120 or 277V.
- Additional architectural colors available; please see Architectural Colors brochure 794.3.
- Length of stem must be specified (from 6" to 240" in even increments). Ex. CYS06 DWHG. Ceiling attachment for interior use. Consult factory for exterior use. Wires supplied by others.

Pendant Accessories (Shipped Separately)

(Specify length and color)

- CYS⁶** 3/8" stem and canopy with 5° "hang straight" swivel
- CRS⁶** 3/8" stem and canopy with 45° swivel

8" CHL Enclosed Wet Location Cylinder

Distribution curve

Distribution data

Output data

Coefficient of utilization

Illuminance Data at 30" Above Floor for a Single Luminaire

CHL8 70M 6RW FFL, MP70/C/U/MED lamp, 1.2 s/mh, 5500 rated lumens, Test No. LTL14712

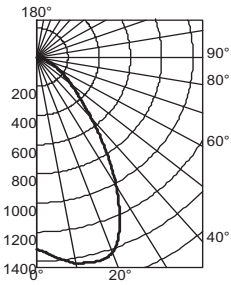

Ave Lumens	Zone Lumens	% Lamp	pf	80%			20%			50%		
				pc	pw	50%	30%	10%	50%	30%	10%	50%
0° 1320	0° - 30° 1111	20.2	0	49	49	49	48	48	48	46	46	46
5° 1377	0° - 40° 1586	28.8	1	44	43	42	43	42	41	42	41	40
15° 1452	0° - 60° 2080	37.8	2	40	38	36	39	37	36	38	36	35
25° 1255	0° - 90° 2255	41.0	3	36	34	32	36	33	31	35	33	31
35° 758	90° - 180° 0	0.0	4	33	30	28	33	30	28	32	29	28
45° 385	0° - 180° 2255	41.0	5	30	27	25	30	27	25	29	27	25
55° 211			6	28	25	23	28	25	23	27	24	23
65° 117			7	26	23	21	26	23	21	25	22	21
75° 44			8	24	21	19	24	21	19	23	21	19
85° 9			9	22	19	18	22	19	17	22	19	17
90° 0			10	21	18	16	21	18	16	20	18	16

Mounting Height	Initial Center Beam	50% beam		10% beam	
		Diameter	FC	Diameter	FC
8.0	43.6	6.3	21.8	11.1	4.4
10.0	23.5	8.6	11.7	15.1	2.3
12.0	14.6	11.0	7.3	19.2	1.5
14.0	10.0	13.3	5.0	23.2	1.0
16.0	7.2	15.6	3.6	27.3	0.7

CHL8 70M 6RW T73, MP70/C/U/MED lamp, 1.0 s/mh, 5500 rated lumens, Test No. LTL14711

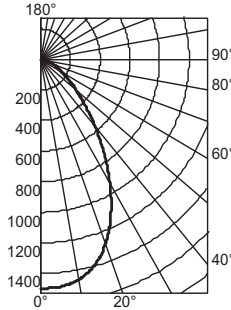

Ave Lumens	Zone Lumens	% Lamp	pf	80%			20%			50%		
				pc	pw	50%	30%	10%	50%	30%	10%	50%
0° 1499	0° - 30° 1041	18.9	0	48	48	48	47	47	47	45	45	45
5° 1494	0° - 40° 1504	27.3	1	44	42	41	43	42	40	41	40	39
15° 1395	0° - 60° 2037	37.0	2	39	37	35	39	37	35	37	36	34
25° 1118	0° - 90° 2226	40.5	3	36	33	31	35	33	31	34	32	30
35° 740	90° - 180° 0	0.0	4	32	30	27	32	29	27	31	29	27
45° 421	0° - 180° 2226	40.5	5	30	27	24	29	26	24	28	26	24
55° 226			6	27	24	22	27	24	22	26	24	22
65° 124			7	25	22	20	25	22	20	24	22	20
75° 47			8	23	20	18	23	20	18	23	20	18
85° 11			9	22	19	17	22	19	17	21	19	17
90° 0			10	20	17	16	20	17	16	20	17	16

Mounting Height	Initial Center Beam	50% beam		10% beam	
		Diameter	FC	Diameter	FC
8.0	49.6	5.5	24.8	11.0	5.0
10.0	26.6	7.6	13.3	15.0	2.7
12.0	16.6	9.6	8.3	19.0	1.7
14.0	11.3	11.6	5.7	23.0	1.1
16.0	8.2	13.6	4.1	26.9	0.8

CHL8 70M 6SB FFL, MP70/C/U/MED lamp, 1.1 s/mh, 5500 rated lumens, Test No. LTL14714

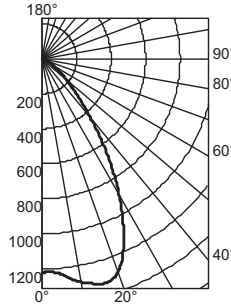

Ave Lumens	Zone Lumens	% Lamp	pf	80%			20%			50%		
				pc	pw	50%	30%	10%	50%	30%	10%	50%
0° 1222	0° - 30° 1001	18.2	0	39	39	39	38	38	38	36	36	36
5° 1233	0° - 40° 1405	25.5	1	36	35	34	35	34	33	34	33	32
15° 1331	0° - 60° 1738	31.6	2	33	31	30	32	31	30	31	30	29
25° 1118	0° - 90° 1796	32.7	3	30	28	27	29	28	26	29	27	26
35° 648	90° - 180° 0	0.0	4	28	25	24	27	25	24	26	25	23
45° 282	0° - 180° 1796	32.7	5	25	23	22	25	23	21	24	23	21
55° 119			6	24	21	20	23	21	20	23	21	19
65° 45			7	22	20	18	22	19	18	21	19	18
75° 12			8	20	18	17	20	18	17	20	18	16
85° 0			9	19	17	15	19	17	15	18	17	15
90° 0			10	18	16	14	18	16	14	17	15	14

Mounting Height	Initial Center Beam	50% beam		10% beam	
		Diameter	FC	Diameter	FC
8.0	40.4	6.2	20.2	10.5	4.0
10.0	21.7	8.4	10.9	14.3	2.2
12.0	13.5	10.7	6.8	18.1	1.4
14.0	9.2	12.9	4.6	21.9	0.9
16.0	6.7	15.2	3.4	25.7	0.7

CHL8 70M 6SB T73, MP70/C/U/MED lamp, 1.0 s/mh, 5500 rated lumens, Test No. LTL14713

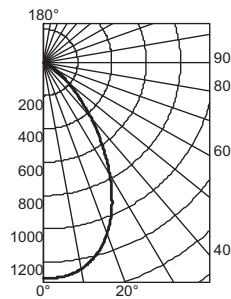

Ave Lumens	Zone Lumens	% Lamp	pf	80%			20%			50%		
				pc	pw	50%	30%	10%	50%	30%	10%	50%
0° 1294	0° - 30° 886	16.1	0	35	35	35	35	35	35	33	33	33
5° 1291	0° - 40° 1255	22.8	1	32	32	31	32	31	30	31	30	29
15° 1194	0° - 60° 1586	28.8	2	30	28	27	29	28	27	28	27	26
25° 947	0° - 90° 1632	29.7	3	27	25	24	27	25	24	26	25	24
35° 591	90° - 180° 0	0.0	4	25	23	22	25	23	22	24	22	21
45° 288	0° - 180° 1632	29.7	5	23	21	20	23	21	19	22	21	19
55° 113			6	21	19	18	21	19	18	21	19	18
65° 38			7	20	18	16	20	18	16	19	17	16
75° 4			8	18	16	15	18	16	15	18	16	15
85° 0			9	17	15	14	17	15	14	17	15	14
90° 0			10	16	14	13	16	14	13	16	14	13

Mounting Height	Initial Center Beam	50% beam		10% beam	
		Diameter	FC	Diameter	FC
8.0	42.8	5.5	21.4	10.3	4.3
10.0	23.0	7.4	11.5	14.1	2.3
12.0	14.3	9.4	7.2	17.9	1.4
14.0	9.8	11.4	4.9	21.6	1.0
16.0	7.1	13.4	3.5	25.4	0.7

NOTES:

- For electrical characteristics, refer to Technical Bulletins tab.
- Tested to current IES and NEMA standards under stabilized laboratory conditions. Various operating factors can cause differences between laboratory data and actual field measurements. Dimensions and specifications are based on the most current available data and are subject to change without notice.

SHID-200

©2008-2012 Acuity Brands Lighting, Inc.
All Rights Reserved. Rev 02/12

gotham
An Acuity Brands Company

GOTHAM ARCHITECTURAL DOWNLIGHTING
1400 Lester Road Conyers Georgia 30012
P 800 315 4982 F 770 860 3129
www.gothamlighting.com