

JUNO**TRAC-MASTER**

Avant Garde

CYLINDRA™ SERIES**T841, T844 and T846**

Project: _____

Fixture Type: _____

Location: _____

Contact/Phone: _____

PRODUCT DESCRIPTION

The contemporary styling of the Cylindra fixture enables it to subtly enhance practically any decor without diverting attention from the surrounding environment. Soft curved surfaces combine with clean, crisp edges to provide a uniquely attractive aesthetic. Cylindra's integral, bayonet-mounted accessory holder accommodates up to two accessories simultaneously.

**Low Voltage MR16**

Construction Die cast aluminum housing.

Lamp 12V, 50W maximum MR16 GU5.3/GX5.3 bi-pin.

Socket Ceramic bi-pin.

Accessory Holder Integral to fixture design • Die cast aluminum construction • Precision bayonet mounting • Accommodates up to two accessories simultaneously • Clear glass lens included with fixture.

Transformer Must be ordered separately • Compatible with T537 universal 12V electronic transformer for LED or halogen lamps ([T537 T537QJ](#)).

Aiming 360° horizontal rotation • 105° vertical aiming capability.

Government Procurement

BAA – Buy America(n) Act: Product qualifies as a domestic end product under the Buy American Act as implemented in the FAR and DFARS. Product also qualifies as manufactured in the United States under DOT Buy America regulations.

BABA – Build America Buy America: Product qualifies as produced in the United States under the definitions of the Build America, Buy America Act.

Please refer to www.acuitybrands.com/buy-american for additional information.

Labels UL • C-UL Listed • Union made • Assembled in U.S.A.

Specifications subject to change without notice.

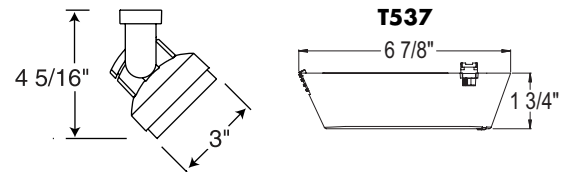

Catalog Number	Description	Finish	Lamp
T841 WH	Cylindra	White	50W MR16 max.
T841 BL	Cylindra	Black	50W MR16 max.

ACCESSORIES

Cat. No.	Description	Cat. No.	Description
HCLBL 200	Hexagonal Cell Louver - Black	DIFF 200	Diffusion Lens
SNOOTBL 200	Snoot - Black	SOLITE 200	Uniformity Lens (Solite)
CGF 200	Color Glass Filters	PRISM 200	Prismatic Spread Lens
DGF 200	Dichroic Glass Filters	LSPREAD 200	Linear Spread Lens
DCCF 200	Dichroic Color Correction Filters	T74BL 175	Barn Doors - Black
UVF 200	UV Filter	T58N¹	Monopoint Canopy

See specification sheet [D1.2.2](#) for details. Other accessories can be found on specification sheet [D1.2.0](#).

Notes:

1 Add finish code to complete catalog number (Example: T58N WH).

TRAC-MASTER®

Avant Garde

CYLINDRA™ SERIES

T841, T844 and T846

Line Voltage PAR20

Construction Die cast aluminum housing.

Lamp 120V, 50W maximum PAR20 medium base.

Socket Medium base porcelain with nickel plated copper screw shell.

Juno Universal Trac Adapter Universally compatible with both Trac-Master 1-circuit or 2-circuit trac, Trac-Lites trac, monopoints and special mountings • Also UL Recognized for use on ConTech® LT Series track • Copper alloy contacts provide precise spring action - no arcing and will not take a set • True, positive electrical ground • On/off switch included • Patented embossed polarity arrows on bottom of adapter • Spring-loaded positive latch with embossed polarity arrows secures trac light to trac • Two-position power contact provided for two-circuit application.

Alternate TEK Trac Adapter Compatible with Juno TEK trac system • System specific and assembled to trac fixture • Integrally polarized construction to prevent reverse installation – only allows insertion in proper orientation • Rotary circuit selector enables simple switching between circuits • Integral on/off switch enables individual fixtures to be switched for servicing.

Alternate GTYPE Trac Adapter Compatible with track systems based on GES type track, including Lithonia LT Commercial Track (not LTS type) • System specific and assembled to trac fixture • Consult factory for additional information.

Alternate HTYPE Trac Adapter Compatible with track systems which use a H-type track adapter, including Lithonia LTS Decorative Track (not LT type) • System specific and assembled to trac fixture • Two-position power contact provided for two-circuit application • Consult factory for additional information.

Alternate LTYPE Trac Adapter Compatible with track systems which use a L-type track adapter • System specific and assembled to trac fixture • Two-position power contact provided for two-circuit application • Consult factory for additional information.

Accessory Holder Integral to fixture design • Die cast aluminum construction • Precision bayonet mounting • Accommodates up to two accessories simultaneously.

Aiming 360° horizontal coverage • 105° vertical aiming capability.

Labels UL • C-UL Listed • Union made • Assembled in U.S.A.

Specifications subject to change without notice.

Catalog Number	Description	Finish	Lamp
T844 WH	Cylindra w/Universal Trac Adapter	White	50W PAR20 max.
T844 BL	Cylindra w/Universal Trac Adapter	Black	50W PAR20 max.
T844 SL	Cylindra w/Universal Trac Adapter	Silver	50W PAR20 max.
T844 TEK WH	Cylindra w/TEK Trac Adapter	White	50W PAR20 max.
T844 TEK BL	Cylindra w/TEK Trac Adapter	Black	50W PAR20 max.
T844 TEK SL	Cylindra w/TEK Trac Adapter	Silver	50W PAR20 max.
T844 GTYPE WH	Cylindra w/G-Type Trac Adapter	White	50W PAR20 max.
T844 GTYPE BL	Cylindra w/G-Type Trac Adapter	Black	50W PAR20 max.
T844 GTYPE SL	Cylindra w/G-Type Trac Adapter	Silver	50W PAR20 max.
T844 HTYPE WH	Cylindra w/H-Type Trac Adapter	White	50W PAR20 max.
T844 HTYPE BL	Cylindra w/H-Type Trac Adapter	Black	50W PAR20 max.
T844 HTYPE SL	Cylindra w/H-Type Trac Adapter	Silver	50W PAR20 max.
T844 LTYPE WH	Cylindra w/L-Type Trac Adapter	White	50W PAR20 max.
T844 LTYPE BL	Cylindra w/L-Type Trac Adapter	Black	50W PAR20 max.
T844 LTYPE SL	Cylindra w/L-Type Trac Adapter	Silver	50W PAR20 max.

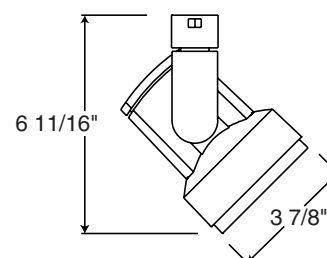

ACCESSORIES

Cat. No.	Description	Cat. No.	Description
HCLBL 275	Hexagonal Cell Louver - Black	DIFF 275	Diffusion Lens
CGF 275	Color Glass Filters	SOLITE 275	Uniformity Lens (Solite)
DGF 275	Dichroic Glass Filters	PRISM 275	Prismatic Spread Lens
DCCF 275	Dichroic Color Correction Filters	LSPREAD 275	Linear Spread Lens
UVF 275	UV Filter	T40N¹	Monopoint Canopy

See specification sheet [D1.2.2](#) for details. Other accessories can be found on specification sheet [D1.2.0](#).

Notes:

¹ Add finish code to complete catalog number (Example: T40N WH).

ConTech is a registered trademark of ConTech Lighting.

TRAC-MASTER®

Avant Garde

CYLINDRA™ SERIES

T841, T844 and T846

Line Voltage PAR38

Construction Die cast aluminum housing.

Lamp 120V, 150W maximum PAR38 medium base.

Socket Medium base porcelain with nickel plated copper screw shell.

Juno Universal Trac Adapter Universally compatible with both Trac-Master 1-circuit or 2-circuit trac, Trac-Lites trac, monopoints and special mountings • Also UL Recognized for use on ConTech® LT Series track • Copper alloy contacts provide precise spring action - no arcing and will not take a set • True, positive electrical ground • On/off switch included • Patented embossed polarity arrows on bottom of adapter • Spring-loaded positive latch with embossed polarity arrows secures trac light to trac • Two-position power contact provided two-circuit application.

Alternate TEK Trac Adapter Compatible with Juno TEK trac system • System specific and assembled to trac fixture • Integrally polarized construction to prevent reverse installation – only allows insertion in proper orientation • Rotary circuit selector enables simple switching between circuits • Integral on/off switch enables individual fixtures to be switched for servicing.

Alternate GTYPE Trac Adapter Compatible with track systems based on GES type track, including Lithonia LT Commercial Track (not LTS type) • System specific and assembled to trac fixture • Consult factory for additional information.

Alternate HTYPE Trac Adapter Compatible with track systems which use a H-type track adapter, including Lithonia LTS Decorative Track (not LT type) • System specific and assembled to trac fixture • Two-position power contact provided for two-circuit application • Consult factory for additional information.

Alternate LTYPE Trac Adapter Compatible with track systems which use a L-type track adapter • System specific and assembled to trac fixture • Two-position power contact provided for two-circuit application • Consult factory for additional information.

Accessory Holder Integral to fixture design • Die cast aluminum construction • Precision bayonet mounting • Accommodates up to two accessories simultaneously.

Aiming 360° horizontal coverage • 105° vertical aiming capability.

Labels UL • C-UL Listed • Union made • Assembled in U.S.A.

Specifications subject to change without notice.

Catalog Number	Description	Finish	Lamp
T846 WH	Cylindra w/Universal Trac Adapter	White	150W PAR38 max.
T846 BL	Cylindra w/Universal Trac Adapter	Black	150W PAR38 max.
T846 SL	Cylindra w/Universal Trac Adapter	Silver	150W PAR38 max.
T846 TEK WH	Cylindra w/TEK Trac Adapter	White	150W PAR38 max.
T846 TEK BL	Cylindra w/TEK Trac Adapter	Black	150W PAR38 max.
T846 TEK SL	Cylindra w/TEK Trac Adapter	Silver	150W PAR38 max.
T846 GTYPE WH	Cylindra w/G-Type Trac Adapter	White	150W PAR38 max.
T846 GTYPE BL	Cylindra w/G-Type Trac Adapter	Black	150W PAR38 max.
T846 GTYPE SL	Cylindra w/G-Type Trac Adapter	Silver	150W PAR38 max.
T846 HTYPE WH	Cylindra w/H-Type Trac Adapter	White	150W PAR38 max.
T846 HTYPE BL	Cylindra w/H-Type Trac Adapter	Black	150W PAR38 max.
T846 HTYPE SL	Cylindra w/H-Type Trac Adapter	Silver	150W PAR38 max.
T846 LTYPE WH	Cylindra w/L-Type Trac Adapter	White	150W PAR38 max.
T846 LTYPE BL	Cylindra w/L-Type Trac Adapter	Black	150W PAR38 max.
T846 LTYPE SL	Cylindra w/L-Type Trac Adapter	Silver	150W PAR38 max.

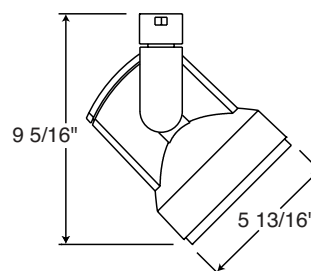

ACCESSORIES

Cat. No.	Description	Cat. No.	Description
HCLBL 469	Hexagonal Cell Louver - Black	UVF 469	UV Filter
CCLBL 469	Cube Cell Louver - Black	DIFF 469	Diffusion Lens
SNOOTBL 469	Snoot - Black	SOLITE 469	Uniformity Lens (Solite)
CGF 469	Color Glass Filters	PRISM 469	Prismatic Spread Lens
DGF 469	Dichroic Glass Filters	LSPREAD 469	Linear Spread Lens
DCCF 469	Dichroic Color Correction Filters	T40N¹	Monopoint Canopy

See specification sheet [D1.2.2](#) for details. Other accessories can be found on specification sheet [D1.2.0](#).

Notes:

1 Add finish code to complete catalog number (Example: T40N WH).

ConTech is a registered trademark of ConTech Lighting.



One Lithonia Way • Conyers, GA 30012 • Phone 1-800-705-SERV (7378) • Visit us at www.acuitybrands.com
Printed in U.S.A. ©2017-2024 Acuity Brands Lighting, Inc. Rev. 08/8/24