

Avant Garde

T890, T892, T893 and T898

Project: _____

Fixture Type: _____

Location: _____

Contact/Phone: _____

PRODUCT DESCRIPTION

Cubix is a study of the visual relationship between two different geometric forms: the ring and the cube. In this design, the stem becomes a central element, forming a pleasing visual extension of the cube form. Concealed wiring and sleek trac adapter offer an ultra-clean appearance. The integral bayonet mount accessory holder in the MR16 version, and the optional bayonet mount accessory holder in the PAR30 version, accept up to two accessories simultaneously.

Cubix uses high-quality, die-cast aluminum construction and is available in attractive white, black and silver finishes.

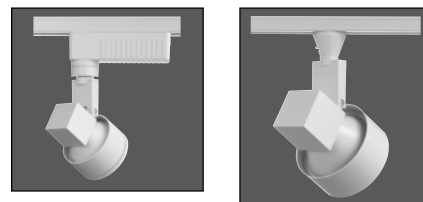

Low Voltage MR16

Construction Die cast aluminum housing.

Lamp 12V, 50W maximum MR16 GU5.3/GX5.3 bi-pin.

Socket Ceramic bi-pin.

Accessory Holder Integral to fixture design • Die cast aluminum construction • Precision bayonet mounting • Accommodates up to two accessories simultaneously • Clear glass lens included with fixture.

Transformer Must be ordered separately • Compatible with T537 or T538 12V electronic transformer for halogen lamps (D1.2.1) • Compatible with T537 LED universal 12V electronic transformer for LED or halogen lamps (D1.2.5) • Compatible with T539 12V electronic transformer for halogen lamps (D1.2.0) • Compatible with T543 12V magnetic transformer for LED or halogen lamps (D1.2.0).

Aiming 360° horizontal rotation • 90° vertical aiming capability.

Labels UL and C-UL Listed.

Specifications subject to change without notice.

Catalog Number	Finish	Lamp
T890 WH	White	50W MR16 max.
T890 BL	Black	50W MR16 max.
T890 SL	Silver	50W MR16 max.

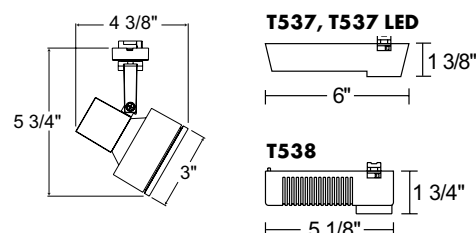

ACCESSORIES

Cat. No.	Description	Cat. No.	Description
HCLBL 200	Hexagonal Cell Louver - Black	UVF 200	UV Filter
SNOOTBL 200	Snoot - Black	DIFF 200	Diffusion Lens
EYEBROWBL 200	Eye-brow - Black	SOLITE 200	Uniformity Lens (Solite)
CGF 200	Color Glass Filters	PRISM 200	Prismatic Spread Lens
DGF 200	Dichroic Glass Filters	LSPREAD 200	Linear Spread Lens
DCCF 200	Dichroic Color Correction Filters	T58N ¹	Monopoint Canopy

See specification sheet D1.2.2 for details. Other accessories can be found on specification sheet D1.2.0.

Notes:

1 Add finish code to complete catalog number (Example: T58N WH).

Line Voltage PAR20

Construction Die cast aluminum housing.

Lamp 120V, 50W maximum PAR20 medium base.

Socket Medium base porcelain with nickel plated copper screw shell.

Adapter Unique, attractive conical-elliptical shaped trac adapter • Copper alloy contacts provide precise spring action – no arcing and will not take a set • True, positive electrical ground • Spring-loaded positive latch with embossed polarity arrow secures trac light to trac • Two-position power contact provided for two-circuit application • Polarity indicator embossed on copper contact.

Aiming 360° horizontal rotation • 90° vertical aiming capability.

Labels UL and C-UL Listed.

Specifications subject to change without notice.

Catalog Number	Finish	Lamp
T892 WH	White	50W PAR20 max.
T892 BL	Black	50W PAR20 max.
T892 SL	Silver	50W PAR20 max.

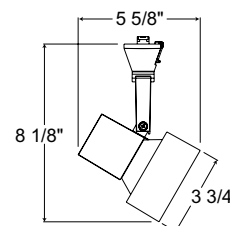

ACCESSORIES

Cat. No.	Description
T40N ¹	Monopoint Canopy

Other accessories can be found on specification sheet D1.2.0.

Notes:

1 Add finish code to complete catalog number (Example: T40N WH).

TRAC-MASTER®

Avant Garde

CUBIX® SERIES**T890, T892, T893 and T898****Line Voltage PAR30****Construction** Die cast aluminum housing.**Lamp** 120V, 75W maximum PAR30 medium base.**Socket** Medium base porcelain with nickel plated copper screw shell.**Adapter** Unique, attractive conical-elliptical shaped trac adapter • Copper alloy contacts provide precise spring action – no arcing and will not take a set • True, positive electrical ground • Spring-loaded positive latch with embossed polarity arrow secures trac light to trac • Two-position power contact provided for two-circuit application • Polarity indicator embossed on copper contact.**Accessory Holder** Must be ordered separately • Die cast aluminum construction • Precision bayonet mounting • Accommodates up to two accessories simultaneously.**Aiming** 360° horizontal rotation • 90° vertical aiming capability.**Labels** UL and C-UL Listed.

Specifications subject to change without notice.

Catalog Number	Finish	Lamp
T893 WH	White	75W PAR30 max.
T893 BL	Black	75W PAR30 max.
T893 SL	Silver	75W PAR30 max.

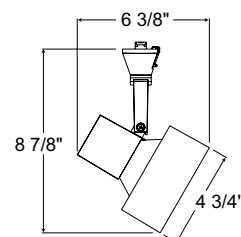
**ACCESSORIES**

Cat. No.	Description	Cat. No.	Description
T893MCBL	3-3/4" Dia. Accessory Holder - Black	DCCF 375¹	Dichroic Color Correction Filters
T893MCSL	3-3/4" Dia. Accessory Holder - Silver	UVF 375¹	UV Filter
T893MCWH	3-3/4" Dia. Accessory Holder - White	DIFF 375¹	Diffusion Lens
HCLBL 375¹	Hexagonal Cell Louver - Black	SOLITE 375¹	Uniformity Lens (Solite)
CCLBL 375¹	Cube Cell Louver - Black	PRISM 375¹	Prismatic Spread Lens
SNOOTBL 375¹	Snoot - Black	LSPREAD 375¹	Linear Spread Lens
CGF 375¹	Color Glass Filters	T40N²	Monopoint Canopy
DGF 375¹	Dichroic Glass Filters		

See specification sheet [D1.2.2](#) for details. Other accessories can be found on specification sheet [D1.2.0](#).

Notes:

- 1 Use of light control accessories requires accessory holder (order separately).
- 2 Add finish code to complete catalog number (Example: T40N WH).

Line Voltage PAR38**Construction** Die cast aluminum housing.**Lamp** 120V, 150W maximum PAR38 medium base.**Socket** Medium base porcelain with nickel plated copper screw shell.**Adapter** Unique, attractive conical-elliptical shaped trac adapter • Copper alloy contacts provide precise spring action – no arcing and will not take a set • True, positive electrical ground • Spring-loaded positive latch with embossed polarity arrow secures trac light to trac • Two-position power contact provided for two-circuit application • Polarity indicator embossed on copper contact.**Aiming** 360° horizontal rotation • 90° vertical aiming capability.**Labels** UL and C-UL Listed.

Specifications subject to change without notice.

Catalog Number	Finish	Lamp
T898WH	White	150W PAR38 max.
T898BL	Black	150W PAR38 max.
T898SL	Silver	150W PAR38 max.

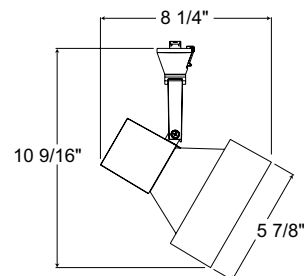
**ACCESSORIES**

Cat. No.	Description
T40N¹	Monopoint Canopy

Other accessories can be found on specification sheet [D1.2.0](#).

Notes:

- 1 Add finish code to complete catalog number (Example: T40N WH).