

**JUNO**<sup>®</sup>**TRAC-MASTER**<sup>®</sup>

Avant Garde

**CYLINDRA™ 18W/19W LED****T254L**

Project: \_\_\_\_\_

Fixture Type: \_\_\_\_\_

Location: \_\_\_\_\_

Contact/Phone: \_\_\_\_\_

**PRODUCT DESCRIPTION**

The Cylindra™ 18W/19W LED approximates the light output and distribution of 75W PAR30 halogen lamps, utilizing approximately 1/4 of the energy and having a rated life of 50,000 hours. Available in 2700K, 3000K, 3500K and 4000K color temperatures with a minimum 80 CRI. Optional high CRI versions are available with a minimum 90 CRI and R9 greater than 50. There are also Enhanced Spectrum versions to bring out color depth in retail goods, artwork, etc. The contemporary styling of the Cylindra LED enables it to subtly enhance practically any decor without diverting attention from the surrounding environment. Soft curved surfaces combine with clean, crisp edges to provide a uniquely attractive aesthetic. Cylindra's integral, bayonet-mounted accessory holder accommodates up to two accessories if desired.

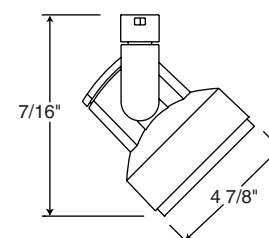
**DIMENSIONS****PRODUCT SPECIFICATIONS**

**Construction** Die cast aluminum housing provides outstanding thermal management of LED, yielding 70% average lumen maintenance at 50,000 hours of operation • Fashionable, elegant design complements any decor • Available in white, black and silver painted finishes.

**LED** High performance LED array provides outstanding reliability, performance and color quality/consistency • 2700K, 3000K, 3500K or 4000K white phosphor high performance LEDs • Chromaticity range within a 3-step MacAdam Ellipse • Exceptional 80 CRI minimum on a standard product • Optional high CRI versions offer 90 CRI minimum with a R9 value greater than 50 • Optional 2700K, 3000K and 3500K Enhanced Spectrum versions, which operate at 19W, offer color quality scale (CQS) scores of 90+ to make colors pop.

**Driver** Concealed in rear housing to minimize overall fixture footprint • Provides quiet operation with or without dimming • Dimmable using high quality reverse phase electronic low voltage (ELV) dimmers – contact factory for a list of Juno approved dimmers – see [D1.3.35.DIM](#) • Solid state electronic, Class 2 compliant • Integral overcurrent and short circuit protection • Designed for greater than 50,000 hour operating life • FCC Certified to Part 15 Class B EMI standards.

**Optics** Interchangeable computer-designed custom faceted reflectors available in three factory-configured beam spreads • One reflector provided with fixture (as specified in catalog number) • Accessory reflectors available to enable beam changes in the field • Beam patterns can be altered as desired using a variety of available light control accessories.

**Juno Universal Trac Adapter** Universally compatible with both Trac-Master 1-circuit or 2-circuit trac, Trac-Lites trac, monopoints and special mountings • Also UL Recognized for use on ConTech® LT Series track • Copper alloy contacts provide precise spring action - no arcing and will not take a set • True, positive electrical ground • On/off switch included • Patented embossed polarity arrows on bottom of adapter • Spring-loaded positive latch with embossed polarity arrows secures trac light to trac • Two-position power contact provided for two-circuit application.

**Alternate TEK Trac Adapter** Compatible with Juno TEK trac system • System specific and assembled to trac fixture • Integrally polarized construction to prevent reverse installation – only allows insertion in proper orientation • Rotary circuit selector enables simple switching between circuits • Integral on/off switch enables individual fixtures to be switched for servicing.

**Alternate GTYPE Trac Adapter** Compatible with track systems based on GES type track, including Lithonia LT Commercial Track (not LTS type) • System specific and assembled to trac fixture • Consult factory for additional information.

**Alternate HTYPE Trac Adapter** Compatible with track systems which use a H-type track adapter, including Lithonia LTS Decorative Track (not LT type) • System specific and assembled to trac fixture • Two-position power contact provided for two-circuit application • Consult factory for additional information.

**Alternate LTYPE Trac Adapter** Compatible with track systems which use a L-type track adapter • System specific and assembled to trac fixture • Two-position power contact provided for two-circuit application • Consult factory for additional information.

**Accessory Holder** Integral to fixture design • Die cast aluminum construction • Precision bayonet mounting • Accommodates up to two accessories if desired.

**Aiming** 360° horizontal coverage • 105° vertical aiming capability.

**Labels** UL and C-UL Listed • ENERGY STAR® certified and DesignLights Consortium® Qualified (except Enhanced Spectrum versions) • Union made • Assembled in U.S.A.

**Warranty** 5-year limited warranty. Complete warranty terms located at: [www.acuitybrands.com/CustomerResources/Terms\\_and\\_conditions.aspx](http://www.acuitybrands.com/CustomerResources/Terms_and_conditions.aspx). Specifications subject to change without notice.

ConTech is a registered trademark of ConTech Lighting.



1300 S. Wolf Road • Des Plaines, IL 60018 • Phone (847) 827-9880 • Fax (847) 827-2925 • Visit us at [www.acuitybrands.com/juno-trac](http://www.acuitybrands.com/juno-trac)  
Printed in U.S.A. ©2017-2018 Acuity Brands Lighting, Inc. Rev. 05/16/18

**TRAC-MASTER®**

Avant Garde

**CYLINDRA™ 18W/19W LED****T254L****ORDERING INFORMATION**

Ordering Example: T254L 30K ES PDIM NFL WH, T254L TEK 30K ES NFL BL

Series	Mounting Adapter Type	Color Temperature	Color Rendering Index	Dimming Compatibility
<b>T254L</b> 18W/19W Cylindra LED	<b>Blank</b> Universal 120V Trac Adapter	<b>27K</b> 2700K	<b>80CRI</b> 80 CRI <b>90CRI</b> 90 CRI <b>ES</b> Enhanced Spectrum (2700K & 3000K & 3500K only)	<b>PDIM</b> Phase Dimmable
	<b>TEK</b> TEK 120V Trac Adapter	<b>30K</b> 3000K		
	<b>GTYPE</b> G-Type Trac Adapter	<b>35K</b> 3500K		
	<b>HTYPE</b> H-Type Trac Adapter	<b>40K</b> 4000K		
	<b>LTYPE</b> L-Type Trac Adapter			

Distribution	Finish
<b>SP</b> Spot	<b>BL</b> Black
<b>NFL</b> Narrow Flood	<b>SL</b> Silver
<b>FL</b> Flood	<b>WH</b> White

Accessories			
<b>CCLBL 375</b>	Cube Cell Louver - Black	<b>DIFF 200</b>	Diffusion Glass Lens
<b>CGF 375</b>	Color Glass Filters	<b>SOLITE 200</b>	Uniformity Lens (Solite)
<b>DGF 375</b>	Dichroic Glass Filter	<b>PRISM 200</b>	Prismatic Spread Lens
<b>DCCF 375</b>	Dichroic Color Correction Filter	<b>LSPREAD 200</b>	Linear Spread Lens
<b>UVF 375</b>	UV Filter		

See specification sheet [D1.2.2](#) for details.

**TRAC-MASTER®**

Avant Garde

**CYLINDRA™ 18W/19W LED****T254L****PHOTOMETRICS****PERFORMANCE DATA<sup>1</sup>:**

Catalog Number	Voltage	Input Watts (Typical)	Lumens	Efficacy (LPW)	Rated Life (Hours)
T254L 27K 80CRI SP	120V	17.8	1241	70	50,000
T254L 27K 80CRI NFL	120V	17.8	1292	73	50,000
T254L 27K 80CRI FL	120V	17.8	1304	73	50,000
T254L 27K 90CRI SP	120V	17.8	1074	60	50,000
T254L 27K 90CRI NFL	120V	17.8	1119	63	50,000
T254L 27K 90CRI FL	120V	17.8	1129	63	50,000
T254L 27K ES SP	120V	19.0	716	38	50,000
T254L 27K ES NFL	120V	19.0	746	39	50,000
T254L 27K ES FL	120V	19.0	753	40	50,000
T254L 30K 80CRI SP	120V	17.8	1279	72	50,000
T254L 30K 80CRI NFL	120V	17.8	1332	75	50,000
T254L 30K 80CRI FL	120V	17.8	1344	76	50,000
T254L 30K 90CRI SP	120V	17.8	1113	63	50,000
T254L 30K 90CRI NFL	120V	17.8	1159	65	50,000
T254L 30K 90CRI FL	120V	17.8	1169	66	50,000
T254L 30K ES SP	120V	19.0	742	39	50,000
T254L 30K ES NFL	120V	19.0	773	41	50,000
T254L 30K ES FL	120V	19.0	780	41	50,000
T254L 35K 80CRI SP	120V	17.8	1330	75	50,000
T254L 35K 80CRI NFL	120V	17.8	1385	78	50,000
T254L 35K 80CRI FL	120V	17.8	1398	79	50,000
T254L 35K 90CRI SP	120V	17.8	1151	65	50,000
T254L 35K 90CRI NFL	120V	17.8	1199	67	50,000
T254L 35K 90CRI FL	120V	17.8	1210	68	50,000
T254L 35K ES SP	120V	19.0	767	40	50,000
T254L 35K ES NFL	120V	19.0	799	42	50,000
T254L 35K ES FL	120V	19.0	806	42	50,000
T254L 40K 80CRI SP	120V	17.8	1369	77	50,000
T254L 40K 80CRI NFL	120V	17.8	1425	80	50,000
T254L 40K 80CRI FL	120V	17.8	1438	81	50,000
T254L 40K 90CRI SP	120V	17.8	1202	68	50,000
T254L 40K 90CRI NFL	120V	17.8	1252	70	50,000
T254L 40K 90CRI FL	120V	17.8	1263	71	50,000

<sup>1</sup>Performance data, including Rated Life, is based on measurements of an individual fixture operating in a 25°C ambient.

**ELECTRICAL DATA**

Input Voltage	120V
Input Current (max.)	0.19A
Power Factor	>0.92

# TRAC-MASTER®

Avant Garde

## CYLINDRA™ 18W/19W LED

### T254L

#### PHOTOMETRICS

**CBCP** · Centerbeam candlepower  
**FC** · Footcandles at beam center (aim point)

In vertical aiming applications, aim point (X) is determined by dividing distance from the wall (D) by the tangent of the desired aim angle (A) (0.5774 for 30°, 1.0 for 45°, 1.732 for 60°).

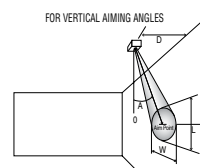
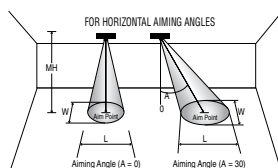

Horizontal Aiming Angles

Vertical Aiming Angles

Lamp	Beam Type	Beam Spread°	Rated Life	CBCP	0°		30°			30°					45°				60°						
					MH	FC	L	W	FC	L	W	D	FC	X	L	W	FC	X	L	W	D	FC	X	L	W
Cylindra 18W LED, 3000K Spot	S	14°	50000	13470	10	135	2.4	2.4	87	3.2	2.8	4	105	6.9	4.0	1.9	298	4.0	2.0	1.4	8	137	4.6	2.6	2.2
					12	94	2.9	2.9	61	3.9	3.3	6	47	10.4	6.0	2.9	132	6.0	2.9	2.0	10	87	5.8	3.2	2.8
					14	69	3.4	3.4	45	4.5	3.9	8	26	13.9	8.0	3.8	74	8.0	3.9	2.7	12	61	6.9	3.9	3.3
					16	53	3.8	3.8	34	5.2	4.4	10	17	17.3	10.0	4.8	48	10.0	4.9	3.4	14	45	8.1	4.5	3.9
					18	42	4.3	4.3	27	5.8	5.0	12	12	20.8	12.1	5.8	33	12.0	5.9	4.1	16	34	9.2	5.2	4.4
Cylindra 18W LED, 3000K Narrow Flood	N	27°	50000	4174	4	261	1.9	1.9	169	2.6	2.2	2	130	3.5	4.7	1.9	369	2.0	2.1	1.4	4	169	2.3	2.6	2.2
					6	116	2.9	2.9	75	3.9	3.4	3	58	5.2	7.0	2.9	164	3.0	3.1	2.1	5	108	2.9	3.3	2.8
					8	65	3.9	3.9	42	5.3	4.5	4	33	6.9	9.4	3.9	92	4.0	4.1	2.7	6	75	3.5	3.9	3.4
					10	42	4.8	4.8	27	6.6	5.6	5	21	8.7	11.7	4.8	59	5.0	5.1	3.4	7	55	4.0	4.6	3.9
					12	29	5.8	5.8	19	7.9	6.7	6	14	10.4	14.1	5.8	41	6.0	6.2	4.1	8	42	4.6	5.3	4.5
Cylindra 18W LED, 3000K Flood	F	48°	50000	2253	3	250	2.7	2.7	163	3.8	3.1	1	282	1.7	8.6	1.8	797	1.0	2.2	1.3	3	163	1.7	3.8	3.1
					4	141	3.5	3.5	91	5.0	4.1	2	70	3.5	17.1	3.5	199	2.0	4.4	2.5	4	91	2.3	5.0	4.1
					5	90	4.4	4.4	59	6.3	5.1	3	31	5.2	**	5.3	89	3.0	6.6	3.8	5	59	2.9	6.3	5.1
					6	63	5.3	5.3	41	7.6	6.1	4	18	6.9	**	7.1	50	4.0	8.8	5.0	6	41	3.5	7.6	6.1
					7	46	6.2	6.2	30	8.8	7.1	5	11	8.7	**	8.8	32	5.0	11.0	6.3	7	30	4.0	8.8	7.1

For 2700K 80CRI fixtures, use 0.94 multiplier; for 2700K 90CRI fixtures, use 0.84 multiplier; for 2700K ES fixtures, use 0.56 multiplier; for 3000K 90CRI fixtures, use 0.87 multiplier; for 3000K ES fixtures, use 0.58 multiplier; for 3500K 80CRI fixtures, use 1.04 multiplier; for 3500K 90CRI fixtures, use 0.90 multiplier; for 3500K ES fixtures, use 0.60 multiplier; for 4000K 80CRI fixtures, use 1.07 multiplier; for 4000K 90CRI fixtures, use 0.94 multiplier.

\*\*Due to steep aiming angle, length of beam extends beyond 25'.