



TRAC 12

Miniature Low Voltage Trac System

FACET[®], MAMBA[®] and CUBIX[®]

TL150, TL155 and TL190

Project: _____

Fixture Type: _____

Location: _____

Contact/Phone: _____

PRODUCT SPECIFICATIONS (for TL150, TL155 and TL190)

Lamp 50W MR16 lamps maximum.

Construction Die cast aluminum housing.

Socket Ceramic bi-pin.

Accessory Holder Integral to fixture design • Die cast aluminum construction • Precision bayonet mounting • Accommodates up to two 2" accessories simultaneously • Clear glass lens included with fixture.

Aiming 90° vertical aiming capability and 360° rotation.

Labels UL and C-UL Listed.

Specifications subject to change without notice.

PRODUCT DESCRIPTION

The sweeping arcs and arresting angles of the Facet deliver a unique asymmetrical aesthetic that is perfectly proportioned for the miniaturized Trac 12 system. With a socket housing that morphs into a stem completely horizontal in nature, its bold simplicity gives Facet an ultra-clean appearance. It shares all the attributes of the larger Trac-Master models including concealed wiring and extends the family "look" when different trac systems are mixed at the same location.

Facet for Trac 12 is designed for use with 50W MR16 low voltage lamps. An integral, bayonet-mount media cartridge is standard and accepts two light control accessories. The Facet features high-quality, die cast aluminum construction in attractive white, black and silver finishes.

Low Voltage MR16 – Facet™

Catalog Number	Description	Finish	Lamp
TL150 WH	Facet™	White	50W MR16, 12V or 24V
TL150 BL	Facet™	Black	50W MR16, 12V or 24V
TL150 SL	Facet™	Silver	50W MR16, 12V or 24V

ACCESSORIES

Cat. No.	Description	Cat. No.	Description
HCLBL 200	Hexagonal Cell Louver - Black	UVF 200	UV Filter
SNOOTBL 200	Snoot - Black	DIFF 200	Diffusion Lens
EYEBROWBL 200	EyeBrow - Black	SOLITE 200	Uniformity Lens (Solite)
CGF 200	Color Glass Filters	PRISM 200	Prismatic Spread Lens
DGF 200	Dichroic Glass Filters	LSPREAD 200	Linear Spread Lens
DCCF 200	Dichroic Color Correction Filters		

See specification sheet [D1.2.2](#) for details. Other accessories can be found on specification sheet [D3.1.0](#).

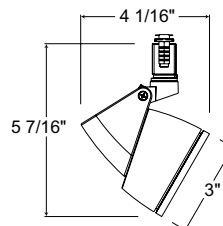

PRODUCT DESCRIPTION

The strikingly original, daring aesthetic of Mamba has been perfectly proportioned for the miniaturized Trac 12 system. The Mamba combines gracefully curved and tapered elements to produce a unique and totally unexpected result. Its front-loading gimbal ring design makes lamp maintenance simple and convenient. It shares all the attributes of the larger Trac-Master models including concealed wiring and extends the family "look" when different trac systems are mixed at the same location.

The Mamba for Trac 12 is designed for use with 50W MR16CG low voltage cover glass lamps. The Mamba features high-quality, die cast aluminum construction in attractive white, black and silver finishes.

Low Voltage MR16 – Mamba™

Catalog Number	Description	Finish	Lamp
TL155 WH	Mamba™	White	50W MR16CG, 12V or 24V
TL155 BL	Mamba™	Black	50W MR16CG, 12V or 24V
TL155 SL	Mamba™	Silver	50W MR16CG, 12V or 24V

Accessories can be found on specification sheet [D3.1.0](#).

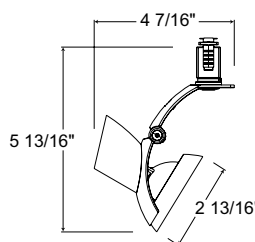

TRAC 12

Miniature Low Voltage Trac System **FACET®**, **MAMBA®** and **CUBIX®** **TL150, TL155 and TL190**

PRODUCT DESCRIPTION

Cubix is a study of the visual relationship between two different geometric forms, the ring and the cube. In this most playful design, the stem becomes the central element, forming a pleasing visual extension of the cube form. The interplay of each of the elements has been perfectly proportioned for the miniaturized Trac 12 system. It shares all the attributes of the larger Trac-Master models including concealed wiring and extends the family "look" when different trac systems are mixed at the same location.

Cubix for Trac 12 is designed for use with 50W MR16 low voltage lamps. An integral, bayonet-mount media cartridge is standard and accepts two light control accessories. The Cubix features high-quality, die cast aluminum construction in attractive white, black and silver finishes.

Low Voltage MR16 – Cubix™

Catalog Number	Description	Finish	Lamp
TL190 WH	Cubix™	White	50W MR16, 12V or 24V
TL190 BL	Cubix™	Black	50W MR16, 12V or 24V
TL190 SL	Cubix™	Silver	50W MR16, 12V or 24V

ACCESSORIES

Cat. No.	Description	Cat. No.	Description
HCLBL 200	Hexagonal Cell Louver - Black	UVF 200	UV Filter
SNOOTBL 200	Snoot - Black	DIFF 200	Diffusion Lens
EYEBROWBL 200	Eye Brow - Black	SOLITE 200	Uniformity Lens (Solite)
CGF 200	Color Glass Filters	PRISM 200	Prismatic Spread Lens
DGF 200	Dichroic Glass Filters	LSPREAD 200	Linear Spread Lens
DCCF 200	Dichroic Color Correction Filters		

See specification sheet [D1.2.2](#) for details. Other accessories can be found on specification sheet [D3.1.0](#).

