



Project: _____

Fixture Type: _____

Location: _____

Contact/Phone: _____

5" IC 900 LUMEN LED DOWNLIGHT REMODEL

IC20RLED (G4 09LM), RECESSED HOUSING
HYPERBOLIC TRIMS



PRODUCT DESCRIPTION

Dedicated LED, Air-Loc® remodel housing with integral light engine

- Shallow housing allows for fit in 2 x 6 construction
- IC remodel housing for remodel application where back side of ceiling is not accessible
- Installs through an opening in the ceiling from below
- Secured in place by factory installed remodel springs
- Can be completely covered with insulation
- When used with supplied ALG kit, stops infiltration and exfiltration of air, reducing heating and air cooling costs
- LED housing is designed to provide 50,000 hours of life and is compatible with many standard Juno trims
- 5 year limited warranty on LED components.

ENVIRONMENTALLY FRIENDLY, ENERGY EFFICIENT

- No harmful ultraviolet or infrared wavelengths
- No lead or mercury
- Comparable light output to 75W PAR30 incandescent

PRODUCT SPECIFICATIONS

LED Light Engine LED array integrated to thermally conductive housing provides uninterrupted heat transfer to ensure long life of the LED

- Replaceable light engine mounts directly to housing and incorporates the latest generation, high lumen output LED array
- LEDs are binned within a 3-step MacAdam Ellipse
- 2700K, 3000K, 3500K, or 4000K color temperatures available
- 90 CRI minimum.

Hyperbolic Optical System Unique hyperbolic reflector shape optimized for small, directional LED source provides unique aperture appearance with reduced brightness

- NMCT™ nano mixing chamber (provided with trim) with high reflectance white finish coupled with a high transmission diffusing lens conceals the LED and integrates with the hyperbolic trim to create a low glare, efficient system.

Aesthetic Trim Selections Hyperbolic reflector available in clear Alzak®, haze, wheat haze, black Alzak® and white

- Shadow free, knife edge design blends seamlessly into ceiling
- Installs with torsion springs.

LED Driver Choice of dedicated 120 (120) volt driver or universal voltage (MVOLT) drivers that accommodate input voltages from 120-277 volts AC at 50/60Hz

- Power factor > 0.9 at 120V input
- 120 volt only driver is dimmable with the use of most incandescent, magnetic low voltage and electronic low voltage wall box dimmers
- Universal voltage drivers are dimmable with the use of most 0-10V wall box dimmers
- For a list of compatible dimmers, see [JUNOICLED-DIM](#)
- Mounted between the j-box and housing for easy access and cool operation.

Life Rated for 50,000 hours at 70% lumen maintenance.

Labels Certified to the high efficacy requirements of California T24 JA8-2019 with select trims

- UL listed for U.S. and Canada through-branch wiring, damp locations
- Union made
- UL and cUL.

Testing All reports are based on published industry procedures; field performance may differ from laboratory performance.

Specifications subject to change without notice.

HOUSING FEATURES

Housing Designed for use in IC (insulated ceiling) or non-IC construction

- Aluminum housing sealed for Air-Loc® compliance when used with ALG kit
- Remodel springs accommodate up to 1 1/8" ceiling thickness.

Junction Box Pre-wired junction box provided with (5) 1/2" knockouts, (4) knockouts for 12/2 or 14/2 NM cable and ground wire

- Knockouts equipped with pryout slots
- Quick connect electrical connectors supplied as standard for fast, secure installation.



DIMENSIONS

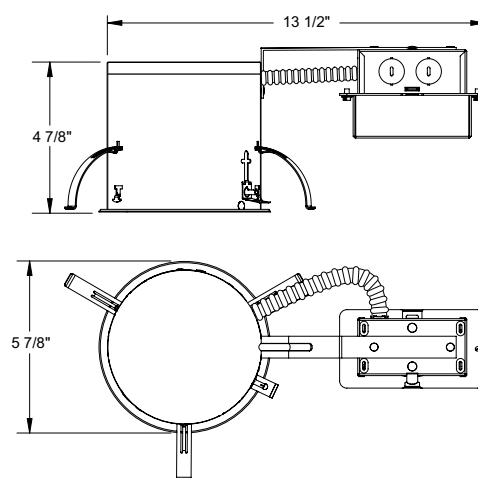

5 1/2" CEILING CUTOUT

5" IC 900 LUMEN LED DOWNLIGHT REMODEL

IC20RLED (G4 09LM), RECESSED HOUSING
HYPERBOLIC TRIMS

ELECTRICAL DATA

Dedicated 120V Only Driver Option (120 FRPC)

| 120V | |
|-----------------------|---|
| Input Power | 11.5W (+/-5%) |
| Input Current | 0.10A |
| Frequency | 50/60Hz |
| EMI/RFI | FCC Title 47 CFR, Part 15, Class B (residential) |
| Minimum starting temp | -25°C |

ELECTRICAL DATA

Universal Voltage

| MVOLT EZ10 and EZ1 | | MVOLT ZT10 and ZT1 | |
|-----------------------|---|---|---|
| 120V | 277V | 120V | 277V |
| Input Power | 10.8W (+/-5%) | 11.8W (+/-5%) | 10.8W (+/-5%) |
| Input Current | 0.09A | 0.05A | 0.09A |
| Frequency | 50/60Hz | 50/60Hz | 50/60Hz |
| EMI/RFI | FCC Title 47 CFR, Part 15, Class B (residential) | FCC Title 47 CFR, Part 15, Class B (residential) | FCC Title 47 CFR, Part 15, Class B (residential) |
| Minimum starting temp | -20°C | -20°C | -20°C |

ORDERING INFORMATION

Housing and trim can be ordered together or separate, but will always ship separately.

Example: IC20RLED G4 09LM 30K 90CRI 120 FRPC

| Series | Generation | Lumens | Color Temperature | CRI | Voltage/Driver |
|--------------------------------------|-----------------|-------------------------|--|---------------|---|
| IC20RLED 5" LED IC Remodel Downlight | G4 Generation 4 | 09LM 900 Nominal Lumens | 27K 2700K 30K 3000K 35K 3500K 40K 4000K | 90CRI 90+ CRI | 120 FRPC 120V Forward/Reverse Phase Cut, 5% dim MVOLT ZT10 Multi-Volt (120-277), 0-10V, 10% dim MVOLT ZT1 Multi-Volt (120-277), 0-10V, 1% dim MVOLT EZ10 Multi-Volt (120-277), eidoLED 0-10V, 10% dim MVOLT EZ1 Multi-Volt (120-277), eidoLED 0-10V, 1% dim |



A+ Capable options indicated
by this color background

Trim/Description



- 204HYP3 BWH ¹ 5" Hyperbolic Cone Trim - Black Alzak® Cone, White Trim Ring
 204HYP3 HZWH ³ 5" Hyperbolic Cone Trim - Haze Cone, White Trim Ring
 204HYP3 WWH ² 5" Hyperbolic Cone Trim - White Cone, White Trim Ring

¹ Not T24 Certified

² MVOLT: Not T24 certified

³ MVOLT: T24 certified @ 40K only

Accessories (ordered separately)

| Catalog Number | Description |
|----------------|-----------------------------|
| TR5 BRZ | 5" Trim Ring - Bronze |
| TR5 BL | 5" Trim Ring - Black |
| TR5 SC | 5" Trim Ring - Satin Chrome |
| TR5 WH | 5" Trim Ring - White |

To order, specify catalog number.

Trim Size: 6 1/4" O.D.

Alzak® is a registered trademark of Alcoa Corp.

Note: In Canada when insulation is present, Type IC fixtures must be used.

5" IC 900 LUMEN LED DOWNLIGHT REMODEL

IC20RLED (G4 09LM), RECESSED HOUSING
HYPERBOLIC TRIMS

PHOTOMETRIC REPORT

Test Report #: PT03140404

Catalog No: IC20RLED G4 09LM 35K
with 204HYP3 CWH Trim
and standard nano mixing
chamber

Luminaire Spacing Criterion: 0.94

Luminaire LPW: 77

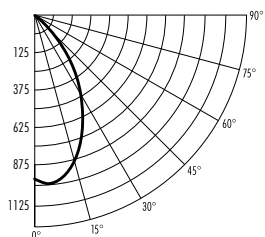

CANDLEPOWER DISTRIBUTION (Candelas)

| Degrees | |
|----------|-----|
| Vertical | 0° |
| 0 | 960 |
| 5 | 990 |
| 15 | 893 |
| 25 | 644 |
| 35 | 303 |
| 45 | 61 |
| 55 | 0 |
| 65 | 0 |
| 75 | 0 |
| 85 | 0 |
| 90 | 0 |

Multiplier: 27K - 0.93
30K - 0.99
40K - 1.01

AVERAGE INITIAL FOOTCANDLES

Multiple Units (Square Array, 60'x60' room)

Ceiling 80% Wall 50% Floor 20%

| Spacing | RCR1 | RCR3 | RCR5 |
|---------|------|------|------|
| 4.0' | 61 | 53 | 47 |
| 5.0' | 39 | 34 | 30 |
| 6.0' | 27 | 24 | 21 |
| 7.0' | 22 | 19 | 17 |
| 8.0' | 17 | 15 | 13 |
| 9.0' | 13 | 12 | 10 |
| 10.0' | 10 | 9 | 7 |

ZONAL LUMEN SUMMARY

| Zone | Lumens | %Lamp | %Fixture |
|---------|--------|-------|----------|
| 0 - 30° | 635 | N/A | 72.1 |
| 0 - 40° | 827 | N/A | 93.9 |
| 0 - 60° | 880 | N/A | 100.0 |
| 0 - 90° | 880 | N/A | 100.0 |

INITIAL FOOTCANDLES

(One Unit, 11.5W, 59.8° Beam)

| Distance to Illuminated Plane (Feet) | Footcandles Beam Center | Beam Diameter |
|--------------------------------------|-------------------------|---------------|
| 4 | 60.0 | 4.6' |
| 6 | 26.7 | 6.9' |
| 8 | 15.0 | 9.2' |
| 10 | 9.6 | 11.5' |

LUMINANCE (Average cd/m²)

| Degrees | Average 0° Luminance |
|---------|----------------------|
| 45 | 8200 |
| 55 | 16 |
| 65 | 0 |
| 75 | 0 |
| 85 | 0 |

PHOTOMETRIC REPORT

Test Report #: PT03140405

Catalog No: IC20RLED G4 09LM 35K
with 204HYP3 HZWH Trim
and standard nano mixing
chamber

Luminaire Spacing Criterion: 0.88

Luminaire LPW: 74

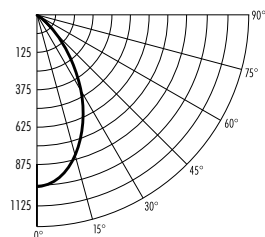

CANDLEPOWER DISTRIBUTION (Candelas)

| Degrees | |
|----------|------|
| Vertical | 0° |
| 0 | 1011 |
| 5 | 993 |
| 15 | 839 |
| 25 | 618 |
| 35 | 296 |
| 45 | 108 |
| 55 | 1 |
| 65 | 0 |
| 75 | 0 |
| 85 | 0 |
| 90 | 0 |

Multiplier: 27K - 0.93
30K - 0.99
40K - 1.01

AVERAGE INITIAL FOOTCANDLES

Multiple Units (Square Array, 60'x60' room)

Ceiling 80% Wall 50% Floor 20%

| Spacing | RCR1 | RCR3 | RCR5 |
|---------|------|------|------|
| 4.0' | 59 | 51 | 45 |
| 5.0' | 38 | 33 | 29 |
| 6.0' | 26 | 23 | 20 |
| 7.0' | 21 | 18 | 16 |
| 8.0' | 17 | 15 | 13 |
| 9.0' | 13 | 11 | 10 |
| 10.0' | 9 | 8 | 7 |

ZONAL LUMEN SUMMARY

| Zone | Lumens | %Lamp | %Fixture |
|---------|--------|-------|----------|
| 0 - 30° | 608 | N/A | 71.4 |
| 0 - 40° | 795 | N/A | 93.3 |
| 0 - 60° | 852 | N/A | 100.0 |
| 0 - 90° | 852 | N/A | 100.0 |

INITIAL FOOTCANDLES

(One Unit, 11.5W, 59.8° Beam)

| Distance to Illuminated Plane (Feet) | Footcandles Beam Center | Beam Diameter |
|--------------------------------------|-------------------------|---------------|
| 4 | 63.2 | 4.6' |
| 6 | 28.1 | 6.9' |
| 8 | 15.8 | 9.2' |
| 10 | 10.1 | 11.5' |

LUMINANCE (Average cd/m²)

| Degrees | Average 0° Luminance |
|---------|----------------------|
| 45 | 8727 |
| 55 | 93 |
| 65 | 0 |
| 75 | 0 |
| 85 | 0 |

Fixtures tested to IES recommended standard for solid state lighting per LM-79-08. Photometric performance on a single unit represents a baseline of performance for the fixture. Results may vary in the field.