

FEATURES & SPECIFICATIONS

INTENDED USE — The ZAL performance aisle lighter provides an excellent choice for both precision-focused and narrow-lighting-distribution applications. The low-profile industrial offers customers unique product features which provide optimal lighting performance, improved installation and energy-saving benefits. Ideal for commercial, manufacturing and warehouse applications where specific targeted performance at higher mounting heights, is required.

CONSTRUCTION — Compact channel design formed from code-gauge cold-rolled steel. Includes T8 and T5 sockets, featuring rotating collar and enclosed contacts.

Innovative T8 two-lamp back plate offers compact design and additional socket protection. Locking lamp holder tracks bolsters strength of the overall strip construction while creating improved lamp stability.

Designed to accommodate standard and high ballast factor (1.15 or 1.20) T8 and high-performance T5 lamp configurations. Enhanced with optional Sensor Switch™ sensors MSI or MSI360, which improve its energy efficiency and lamp longevity to create superior performance in industrial lighting.

Channel offers a gripper back feature which provides additional strength, especially for 8' lengths. Additionally, the channel feature provides the ability to utilize our ZSPRG (spring hanger – see second page) for easy installation.

High-gloss, baked white enamel finish (standard). Five-stage iron-phosphate pretreatment ensures superior paint adhesion and rust resistance.

OPTICS — Two primary reflector versions: MIRO 4° Specular (95% reflectivity) or post-paint white (92% reflectivity). Deep reflector design provides precision light distribution at higher mounting heights.

ELECTRICAL — Thermally protected, resetting, Class P, HPF, non-PCB. AWN, TFN or THHN wire used throughout, rated for required temperatures.

INSTALLATION — Patent-pending “three-point” row connector locks channels together for straighter and faster rows mounting; included as standard.

LISTINGS — UL Listed, CUL Listed or CSA Certified to Canadian Standards. Listed for 25° C ambient temperature. Damp location listed.

WARRANTY — Guaranteed for one year against mechanical defects in manufacture. Note: Specifications subject to change without notice.

Catalog Number
Notes
Type



Performance Aisle Lighter

ZAL



T8 or T5 Linear Lamps
1 or 2 Lamps

Specifications	
Length - T8:	48 (121.9) or 96 (243.8)
Length - T5:	46 (116.8) or 92 (233.7)
Width:	2-1/8 (5.4)
Depth:	1-1/2 (3.8)
Weight:	7.1 lbs (3.2 kg)

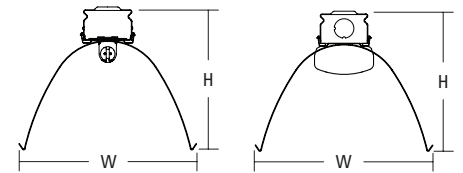

All dimensions are inches (centimeters) unless otherwise noted.

ORDERING INFORMATION

For shortest lead times, configure products using **bolded options**.

Example: Z 1 54T5HO MVOLT GEB10PS

ZAL											
Series	Number of lamps	Lamp type	Finish/Reflector	Voltage	Ballast	Options					
ZAL Aisle lighter For tandem double-length unit, add prefix "T". Ex: TZAL	1	28T5 28W T5 (46")	(blank) White	MVOLT ¹ 120 277 347 Others available.	GEB10IS T8 electronic ballast, <10% THD, instant start	GLR Internal fast-blow fuse ² GMF Internal slow-blow fuse ² PLR_ Plug-in wiring; specify number of branch circuits and hot wires (A=black; B=red; C=blue; AB or AC)					
	2	32 32W T8 (48")	(blank) Solid							GEB10PS T5 electronic ballast, <10% THD, programmed start	TILW Tandem in-line wiring EL55 Emergency battery pack (nominal 390-700 lumens); consult factory for additional battery packs ^{2,3} EL65 Emergency battery pack (nominal 390-700 lumens) ^{2,3}
	Not included.	54T5HO 54W T5HO (46")	SSR Specular finish reflector ¹								

Accessories: Order as separate catalog number.					
HC36	Hanger chain, 36"	ZAC120	Aircraft cable, 120"	SQ_	Swivel-stem hanger (specify length in 2" increments)
ZACVH	Aircraft cable with hook	ZACF120	Aircraft cable with feed, 120"	ZACVH M100	Masterpack 100 aircraft cable; 1 pair, for use only with Z series fixtures
ZAC72	Aircraft cable, 72"	ZAC144	Aircraft cable, 144"	ZSPRG	Tong and T-grid hanger
ZACF72	Aircraft cable with feed, 72"	ZACF144	Aircraft cable with feed, 144"		

Notes

- MVOLT (120-277V), 50-60HZ.
- Specify voltage.
- Available with 4' and 8' lengths only.
- 347V only.

ZAL T8/T5H0/T5 Performance Aisle Lighter

MOUNTING DATA

For unit or row installation; surface or stem mounting.

Unit installation — Minimum of two hangers required.

Row installation — One hanger per channel plus one per row required.

Review local codes when installing any product, as the minimum of 1 hanger per fixture may not satisfy your local building code.

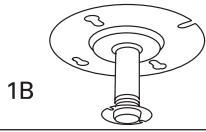

1B

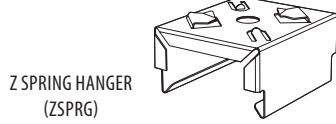

Z SPRING HANGER (ZSPRG)

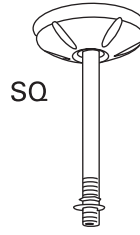

SQ

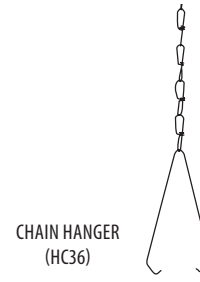

CHAIN HANGER (HC36)

DIMENSIONS

All dimensions are inches (centimeters)

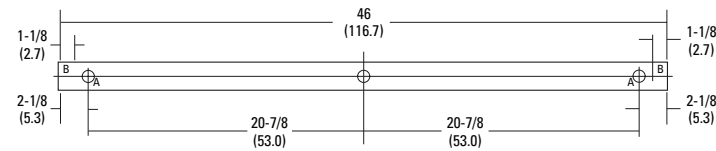
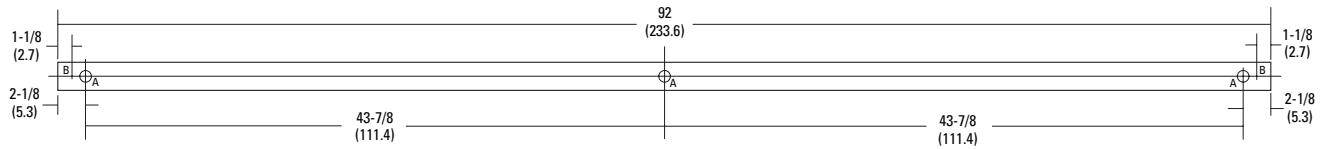

K.O. Dimensions

A = 7/8 (22) Dia. K.O.

F = 7/16 (11) Dia. K.O.

S = 1/4 (6) Dia. K.O.

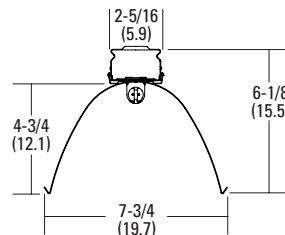
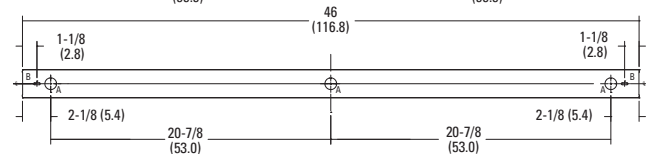
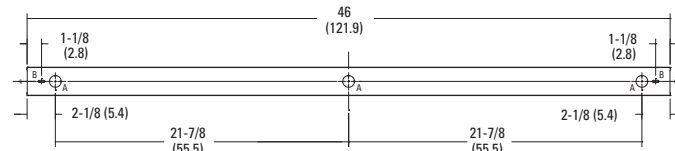
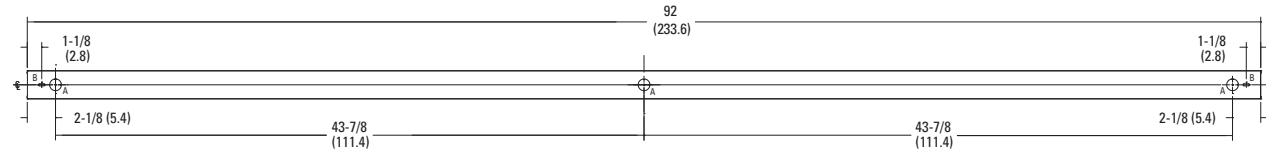
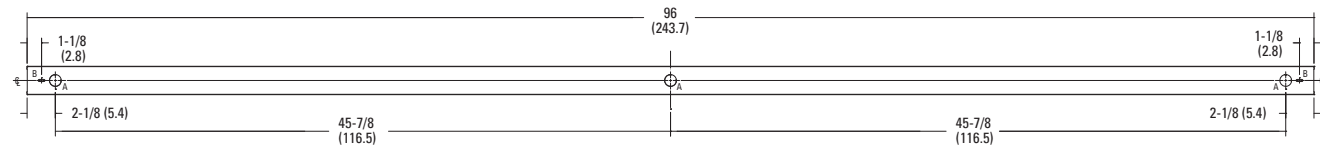

One-lamp T5

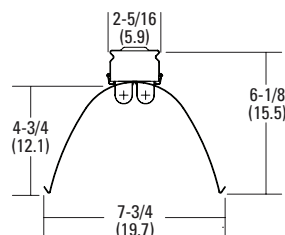

Two-lamp T5

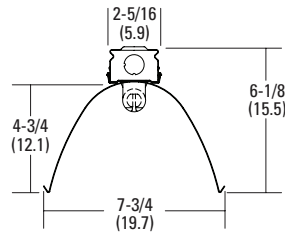

One-lamp T8

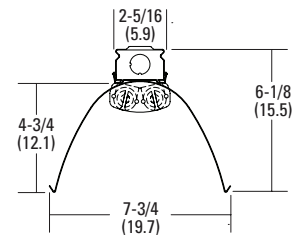

Two-lamp T8

PHOTOMETRICS

Consult factory.