

FEATURES & SPECIFICATIONS

INTENDED USE — Ideal for a wide variety of low- to medium-height ceiling applications including commercial, retail and hospitality spaces where an open or damp location lensed fixture is required.

CONSTRUCTION — Utilizes an extruded socket housing that attaches to the reflector via key hole mount, which provides superior heat dissipation and extended lamp life. Socket housing also adjusts to accommodate varying lamp lengths.

Heavy gauge die formed galvanized steel mounting frame. Attached to frame are vertically adjustable mounting brackets for use with C channels, 1/2" steel conduit or 16 gauge flat bar hangers included, standard. Frames equipped with galvanized junction box UL Listed for through wire applications. Junction boxes equipped with (2) 3/4" and (4) 1/2" conduit knockouts with pryout slots and removable access doors.

Retaining clips packed with reflector for installation on rough-in.

Maximum 1-1/2" ceiling thickness.

OPTICS — Aluminum full reflectors are optically designed to maximize lumen output and to provide superior glare control. Anodized finishes for open reflectors are semi-specular or diffuse in a variety of colors. Polyester powder coat finishes also are available in white.

Lenses are available in clear flat or tempered prismatic glass to provide optimal visual comfort and improved aesthetics. Lens is recessed 7/8 (2.2) from flange.

ELECTRICAL — 120V/277V electronic ballast is standard.

Thermally protected against improper contact with insulation.

Durable, pulse rated medium base porcelain socket with nickel-plated alloy screw shell and contact. Protected lamps ship standard.

Rated for #12 AWG conductor thru-branch wiring. Minimum 90° supply wire.

Ground wire provided.

LISTINGS — Fixtures are UL Listed for thru-branch wiring, Non-IC recessed mounting, damp location, and to U.S. and Canadian Safety Standards.

WARRANTY — 1-year limited warranty. Complete warranty terms located at www.acuitybrands.com/CustomerResources/Terms_and_conditions.aspx

Note: Specifications subject to change without notice.

Catalog Number
Notes
Type

HID Downlighting

8" LP8HN

OPEN REFLECTOR

Vertical Metal Halide ED-17 Lamp

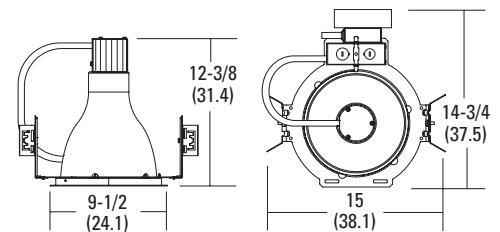

Specifications

Max. height: 12-3/8 (31.4)

Ceiling opening: 8-3/4 (22.2)

Overlap trim: 9-1/2 (24.1)

Length: 14-3/4 (37.5)

Width: 15 (38.1)

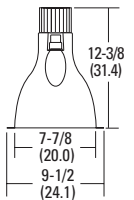

All dimensions are inches (centimeters) unless otherwise indicated.

ORDERING INFORMATION

For shortest lead times, configure product using **bolded options**.

Example: LP8HN 100M 802A 120/277

LP8HN Series	Wattage/Lamp	Reflector/Color	Lens type	Voltage	Options
LP8HN	Metal halide	802 White open	(blank) No lens	120/277	SF Single fuse, must specify voltage
	50M 50W MP50/C/U	802A Clear diffuse open	CGL Clear glass lens		QRS Quartz restrike system(uses maximum 100W DC-base quartz lamp) ²
	70M 70W MP70/C/U	802AZ Clear semi-specular open	T73 Tempered glass prismatic lens		QRSTD Quartz restrike system with time delay. Operates like QRS, except quartz lamp remains on for two minutes after HID lamp restrikes ³
	100M 100W MP100/C/U	802G Gold diffuse open			WLP Lamp (shipped separately)
	Color-corrected metal halide ¹	802GZ Gold semi-specular open			TRW White flange
	50MPC MPC50/C/MED	802PR Pewter diffuse open			LBH Less barhangers
	70MPC MPC70/C/MED	802WTZ Wheat semi-specular open			
	100MPC MPC100/C/MED				

Accessories: Order as separate catalog number.	
SCA8	Sloped ceiling adaptor. Degree of slope must be specified (10D, 15D, 20D, 25D, 30D) Ex: SCA8 10D .
CTE8	Ceiling thickness extender is used when ceiling thickness is greater than 1-1/2 (3.8). Maximum thickness 2 (5.1).

Notes

- 1 Ceramic arc tube consistent-color lamp. Philips MasterColor or GE ConstantColor.
- 2 Not available with QRSTD.
- 3 Not available with QRS.

8" LP8HN Vertical Metal Halide, ED-17 Lamp, Open

PHOTOMETRICS

Distribution Curve	Distribution Data	Output Data	Coefficient of Utilization	Illuminance Data at 30" Above Floor for a Single Luminaire
--------------------	-------------------	-------------	----------------------------	--

LP8HN 70M 802AZ 120/277, (1) 70W MP70/C/U/MED lamp, .90 s/mh, 4800 rated lumens, test no. LTL9585

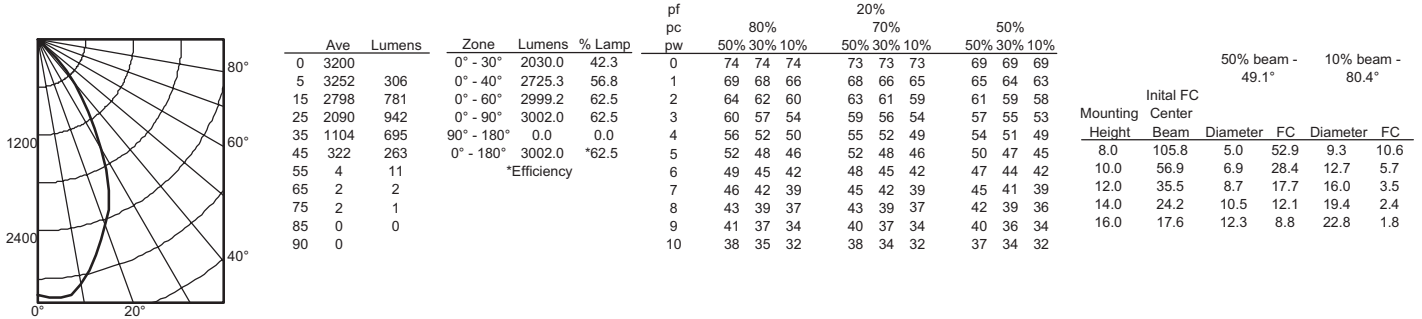

LP8HN 100M 802A CGL 120/277, (1) MHC 100/C/U/M/4K Lamp, 8700 rated lumens per lamp, 0.8 s/mh, Test No. 15071

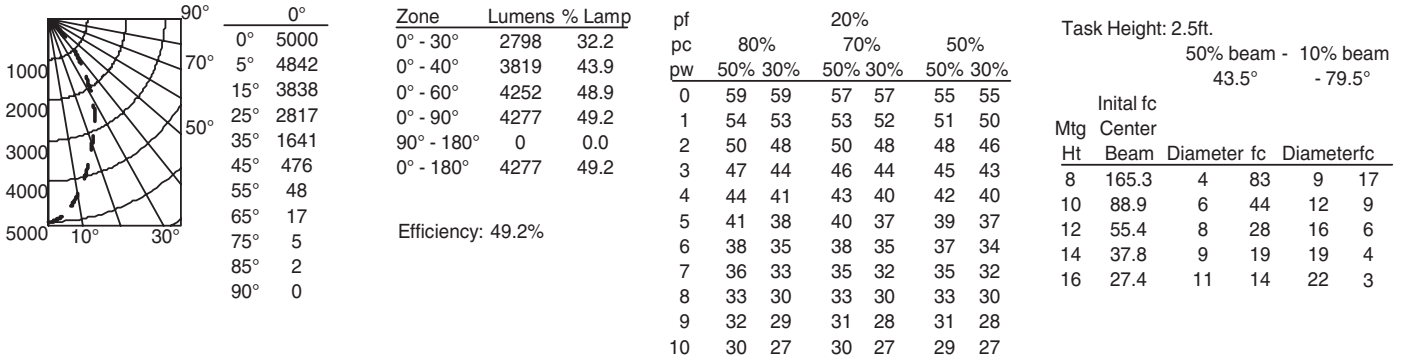

Notes

- Actual performance may differ as a result of end-user environment and application.
- Energy (Calculated in accordance with NEMA Standard LE-5).