

MARK[®] ARCHITECTURAL LIGHTING

2x4 T5 Sample Open Office Calculation 50 Foot Candles

Rendering

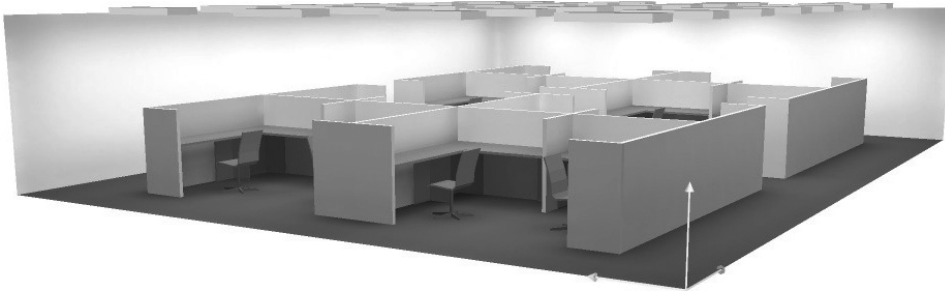

The Meridian Series

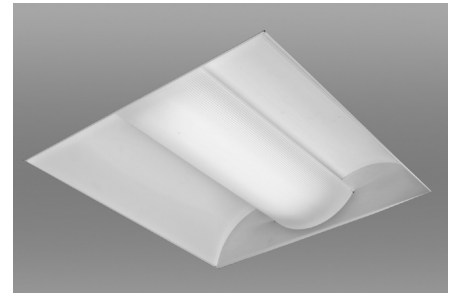

Key Plan

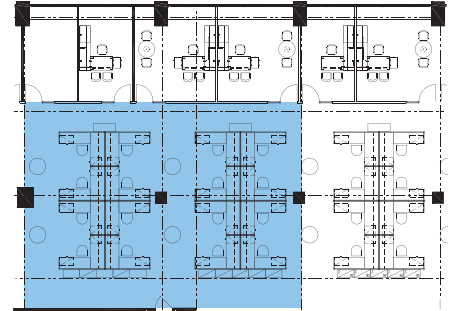

Calculation

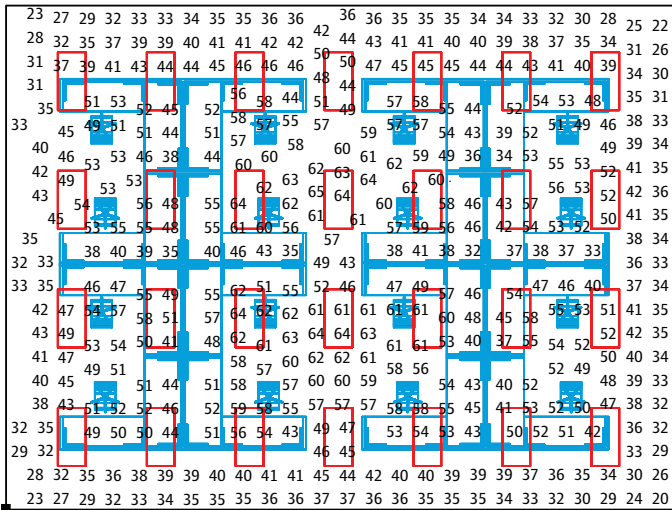

(1.15W/Ft²)

Parameters

FIXTURE SPACING

6'-0" x 8'-0"

FIXTURE

MERIDIAN, #MD-24-2 T5-SWR

FIXTURE SIZE: 2' x 4'

LAMPING: (2) T5

LENS: WHITE RIBBED ACRYLIC

BALLAST: BALLAST FACTOR NA

TESTED INPUT WATTS 62.9

LIGHT LOSS FACTORS

LAMP LUMEN DEPRECIATION: 5%

LUMINAIRE DIRT DEPRECIATION: 11%

ROOM DIRT DEPRECIATION: 4%

LAMP BURNOUT: 5%

SPACE DIMENSIONS

W34' x L45' x H8.5'

REFLECTANCES

CEILING: 80%

WALL: 50%

FLOOR: 20%

PARTITION: 40%

FURNITURE: 25%

TASK PLAN

2'-6" A.F.F.

MARK[®] ARCHITECTURAL LIGHTING

2x4 T5 Sample Private Office Calculation 50 Foot Candles

Rendering



Calculation

16	17	19	20	22	23	24	24	25	25	24	23	23	22	21	19	17	16			
18	19	20	22	23	24	25	26	27	28	28	28	27	26	27	24	23	22	21	19	18
18	20	20	22	23	25	26	27	28	28	31	31	27	29	25	25	22	20	18		
20	22	22	25	26	28	29	31	32	32	32	32	31	29	27	26	24	22	20		
22	23	24	26	28	30	31	33	34	32	34	33	32	32	30	27	25	24	23	22	
22	24	24	27	28	31	32	34	35	34	34	33	33	33	30	27	25	24	23	22	
23	25	25	28	30	33	34	36	37	38	38	39	38	36	35	33	31	28	28	25	23
24	26	27	30	32	35	36	38	39	41	41	41	40	38	37	35	33	30	29	27	24
24	27	27	30	32	36	36	39	40	41	41	41	40	39	38	36	33	30	27	24	
25	27	28	31	33	36	37	40	41	42	42	42	42	40	39	36	34	31	30	27	25
25	27	28	31	33	37	38	40	41	43	43	43	42	41	39	37	34	31	31	27	25
25	28	28	32	34	37	38	41	42	43	44	43	43	41	40	37	35	32	31	28	25
25	27	28	31	33	37	38	40	42	43	43	43	42	40	40	37	35	32	31	28	25
25	27	28	31	33	37	38	40	42	43	43	43	42	40	39	37	35	32	31	28	25
24	27	27	31	33	36	37	40	41	42	42	42	41	39	39	36	34	31	30	27	24
23	26	26	29	31	34	35	37	39	40	40	39	38	37	36	34	32	29	29	26	23
23	25	26	29	31	34	35	37	38	39	39	39	38	37	36	33	32	29	28	26	23
22	24	24	27	29	32	33	35	36	37	37	37	36	35	31	30	29	27	24	22	
22	24	24	27	29	31	32	34	35	36	36	36	35	34	32	30	29	27	26	24	21
20	22	22	24	26	28	28	30	31	32	32	32	31	30	29	28	26	24	24	22	20
18	20	20	22	23	26	26	28	29	29	29	29	28	27	25	24	22	22	20	18	
18	19	20	22	23	25	25	27	28	28	29	28	28	27	26	25	23	22	21	19	18
16	17	17	19	20	22	22	24	24	25	25	25	24	24	23	22	21	19	17	15	
14	15	15	16	17	19	19	20	21	21	21	21	21	20	20	19	18	16	15	13	
14	14	15	16	17	18	19	19	20	20	20	20	19	19	18	17	16	14	14	13	

(1.05W/Ft²)

The Meridian Series

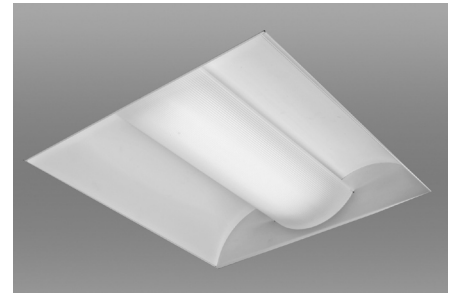

Key Plan

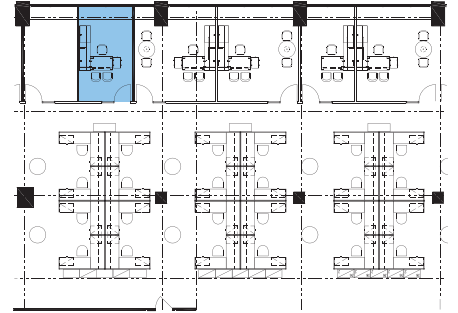

Parameters

FIXTURE SPACING

4'-0"

FIXTURE

MERIDIAN, #MD-24-2 T5-SWR

FIXTURE SIZE: 2' x 4'

LAMPING: (2) T5

LENS: WHITE RIBBED ACRYLIC

BALLAST: BALLAST FACTOR NA

TESTED INPUT WATTS 62.9

LIGHT LOSS FACTORS

LAMP LUMEN DEPRECIATION: 5%

LUMINAIRE DIRT DEPRECIATION: 11%

ROOM DIRT DEPRECIATION: 4%

LAMP BURNOUT: 5%

SPACE DIMENSIONS

W10' x L12' x H8.5'

REFLECTANCES

CEILING: 80%

WALL: 50%

GLASS: 6%

FLOOR: 20%

FURNITURE: 25%

TASK PLAN

2'-6" A.F.F.