

MARK® ARCHITECTURAL LIGHTING

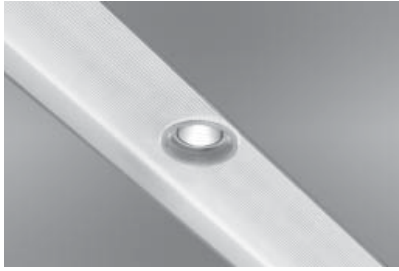

The BiFocal Series

BiFocal provides both general illumination and point-source lighting in one elegantly simple luminaire. MR16 lamps that appear to float within the lens provide accent downlighting, while T5, T5HO or T8 lamps offer general illumination. The MH version uses metal halide MR16 lamps for crisp, energy-efficient accent lighting.

Both versions require a minimum spacing of 2 feet on center for the MR16 lamps. Units can be continuously row mounted or spaced individually and are compatible with Armstrong TechZone™ ceiling systems.

Type:

Project:

Catalog Number:

DO NOT TYPE HERE. Autopopulated field.

Specification Features

Housing

Nominal 6" wide x 2', 3', 4', 5', 6' or 8' long housing fabricated from 20-gauge, cold-rolled steel. Ceiling trim is extruded aluminum. Downlight component is die-cast aluminum.

Finish

Regressed trim is matte white. MR16 trim is matte black (standard) or white.

Reflector

Precision-formed steel; white.

Shielding

Nominal 1/4"-thick frosted clear acrylic.

Lamps

(1) or (2) T8, T5 or T5HO lamps. BiFocal: Maximum 50W MR16 downlight; BiFocal MH: Maximum 20W or 39W MH MR16 lamps. Lamps provided by others.

Ballast

Fluorescent and metal halide: Thermally protected Class P energy-saving electronic ballast. MR16: Electronic 12-volt, 120 or 277 as specified.

Mounting

Recessed. Available for sheetrock, 9/16" slot grid or 15/16" inverted tee ceilings, or 9/16" inverted tee. Unit is compatible with Armstrong TechZone™ ceilings. Consult factory for other ceiling types.

Certification

ETL Listed, IBEW (Local 3) Union-made in the USA.

Technical Drawings

BFLW/GB TRIM

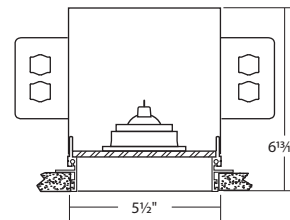

BFD

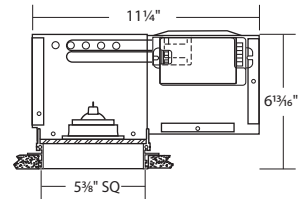

BFLW/T25

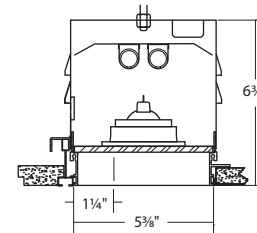

BFL/MH

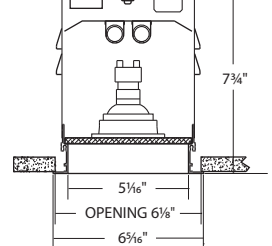

Ordering

Example: BFL/MH20 4 GB 2T5 EBPR 120 FA

Series	Length	Ceiling type ²	No. of lamps/Lamp type ^{3,4}	Ballast	Voltage ⁵	Shielding	Options
BFL BiFocal	2 2' - w/one downlight (max.)	DF 9/16" slot grid or 15/16" inverted tee	Number of lamps Lamp type ^{3,4}	EBPR Program rapid start (standard)	120	FA 1/4" thick clear frosted acrylic	EMPK Emergency battery pack
BFL/MH20 ¹ BiFocal MH 20W	3 3' - w/one downlight (max.)	TG 9/16" inverted tee grid with tegular files	1 T5	EBIS Instant start	277		WHD White downlight trim
BFL/MH39 ¹ BiFocal MH 39W	4 4' - w/two downlights (max.)	GB Trimless (sheetrock)	2 T5HO	EDB Dimming (specify)	347 ⁵		CP Chicago plenum
	5 5' - w/two downlights (max.)	FL 5/8" flange (sheetrock)	T8	EDHL Lutron Hi-Lume® dimming			MLV ¹ Magnetic low-voltage transformer
	6 6' - w/three downlights (max.)			EDE10 Lutron Eco-10® dimming			
	8 8' - w/four downlights (max.)			EDES Lutron Eco System®			
	_ft. Specify continuous run length (in whole feet)						

Notes

- 1 Fixture depth increases to 7 3/4" for these options.
- 2 Consult trim detail sheet for additional information.
- 3 Each 6' and 8' unit contains 2 sets of fluorescent lamps in tandem.
- 4 Each downlight requires one maximum 50W MR16, or 20W or 39W MH MR16 lamp.
- 5 Consult factory for mixed voltage applications.
- 6 Fluorescent only. Consult factory for lamp and ballast compatibility.