

MARK® ARCHITECTURAL LIGHTING

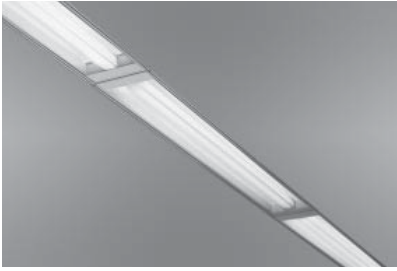

The Datum Series

The low-profile, energy-efficient Datum allows you to put lighting where you need it. With versions as shallow as 2 5/16 inches, Datum is perfect in situations where plenum space is restricted. The 6-inch version is compatible with Armstrong TechZone™ ceiling systems, making it easy to accommodate components such as low-voltage downlighting, sprinklers, speakers and air returns.

Datum seamlessly blends architectural elegance and clean, simple styling with optimum luminance control and efficiencies as high as 84.5 percent.

Type:

Project:

Catalog Number:

DO NOT TYPE HERE. Autopopulated field.

Specification Features

Housing

Die-formed, 20-gauge, cold-rolled steel. End caps and joiners are die-cast aluminum for 6" wide units and formed cold-rolled steel for 1' and 2' wide units.

Finish

Matte white.

Reflector

Precision-contoured, heavy-gauge extruded aluminum for 6" unit. Precision die-formed, 20-gauge, cold-rolled steel for wider units.

Shielding

Co-extruded translucent acrylic.

Lamps

(1) T5 or T5HO (6" and 1' wide versions);
(2) T5 or T5HO (2' wide versions).

Ballast

Thermally protected Class P energy-saving electronic ballast.

Mounting

Recessed grid; 6" wide units are compatible with Armstrong TechZone™ ceiling system.

Certification

cULus Listed, IBEW (Local 3) Union-made in the USA.

Technical Drawings

6IN G9 1T5 RD

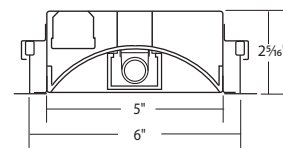

6IN DF 1T5 RT

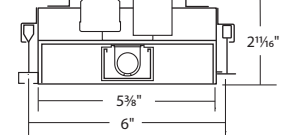

Ordering

Example: DAT RD SS 2x2 G9 2T5 EBPR 120

Series	Reflector	Lens	Size	Ceiling type	No. of lamps/Lamp type ^{1,2}	Ballast	Voltage	Options
DAT Datum	RD Rounded	SS Square smooth	6x4 6" x 4'	G9 15/16" inverted tee	Number of lamps ¹ Lamp type ²	EBPR Program rapid start (standard)	120	EMPK Emergency battery pack
DATS Datum Surface	RT Rectangular	SR Square ribbed	6x5 6" x 5'	DF 9/16" slot grid or superfine	1 T5	EBIS Instant start	277	CP Chicago plenum
		RS Round smooth	1x4 1' x 4'	(For TechZone specify grid type.)	2 T5HO	EDB Dimming (specify)	347³	
		RR Round ribbed	1x5 1' x 5'			EDHL Lutron Hi-Lume® dimming		
			2x2 2' x 2'			EDE10 Lutron Eco-10® dimming		
			2x4 2' x 4'			EDES Lutron Eco System®		
			—ft. Specify continuous run length (in whole feet); 6" width only					

Notes

- 1 Lamps per cross section. See configurations table.
- 2 Consult factory for other lamps.
- 3 Consult factory for lamp and ballast compatibility.

CONFIGURATIONS

SIZE	LAMPS PER CROSS SECTION	LAMPS PER FIXTURE	LAMP TYPE
6" or 1' wide	1	1	T5, T5HO
2' wide	2	2	T5, T5HO