



Catalog Number	
Notes	Type

FEATURES

The RRU provides an interface between a line voltage normal power sense circuit and the low voltage remote override input on Synergy SYPM power modules with the RO option. All connected SYPM modules will be overridden to full ON if normal power falls below 90% of nominal voltage.

- Works in conjunction with Synergy SYPM power modules containing the RO remote override option
- One RRU is needed for each Synergy cabinet to be overridden
- Available to sense either 120 or 277v normal power
- 90% nominal input voltage drop out
- SPDT low voltage dry contact outputs rated for 5 Amps
- UL listed

Lighting Control System RRU SPDT

SPDT Normal Power Sense Relay

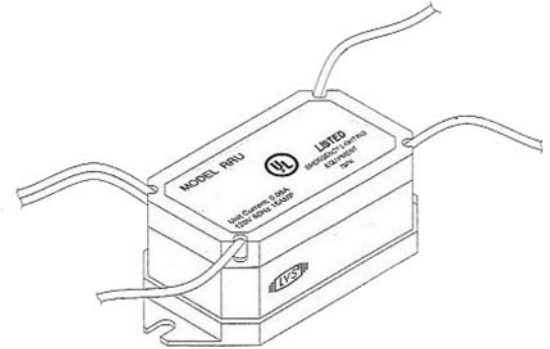

ORDERING INFORMATION

Example: **RRU SPDT 277**

RRU SPDT	
Series	Capacity/voltage
RRU SPDT	120 277

RRU SPDT 120/277 SPDT Normal Power Sense Relay

WIRE DIAGRAM FOR RELAY MODULE

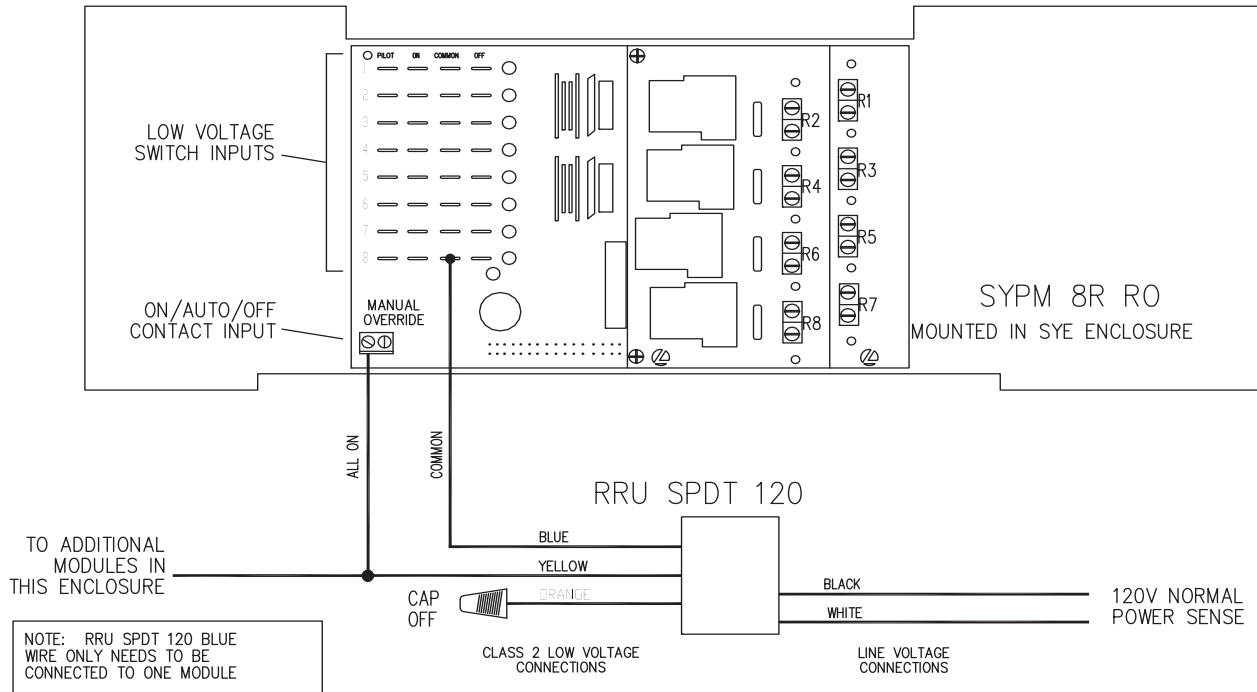

ALL RELAYS ON CONNECTED MODULES WILL BE FORCED TO 'ON' STATE IF NORMAL POWER SENSE CIRCUIT FALLS BELOW 90% OF NOMINAL VOLTAGE

DIMMER MODULE

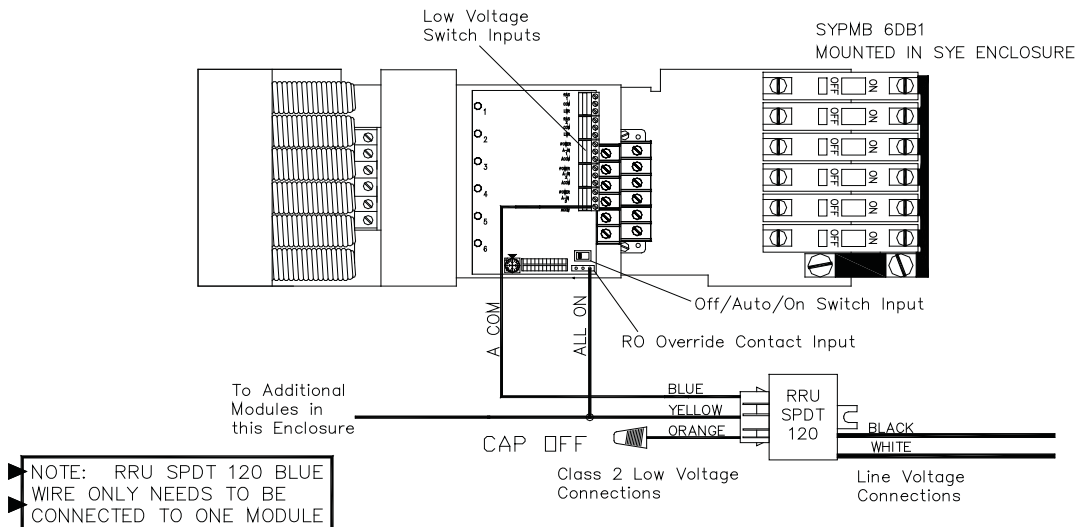

ALL DIMMERS ON CONNECTED MODULES WILL TURN ON TO 100% OUTPUT DESCRIPTION: IF NORMAL POWER SENSE FALLS BELOW 90% OF NOMINAL VOLTAGE



An AcuityBrands Company

Sheet #: RRU SPDT 120

©1991 Acuity Lighting Group, Inc., Rev. 03/08

Synergy Lighting Controls

1335 Industrial Blvd, Conyers, GA 30012

Phone: 800-533-2719

www.synergylightingcontrols.com