



Catalog Number	
Notes	Type

## FEATURES

### INTENDED USE

The SYWR HHP is a hand-held infrared transmitter that provides wireless remote control and the programming of dimming presets in a Synergy system. The SYWR HHP operates in conjunction with the infrared receiver that is ordered as an option on the SYRS digital remote station.

### ATTRIBUTES

Buttons on the SYWR HHP transmitter can be configured to provide a variety of lighting control functions including on/off, preset recall, channel raise/lower and master raise/lower operation. Programming functions include setting individual preset fade times and saving preset scene levels.

### CONSTRUCTION

The contoured thermoplastic housing is ergonomically designed for comfortable hand-held operation. Large soft-touch buttons provide simple operation.

### FINISH

Gray housing with contrasting buttons.

### ELECTRICAL

Power is provided by four AAA batteries which are provided with the unit.

### WARRANTY

One-year total customer satisfaction warranty.

Lighting Control Systems

# SYWR HHP

Hand-Held Programmer

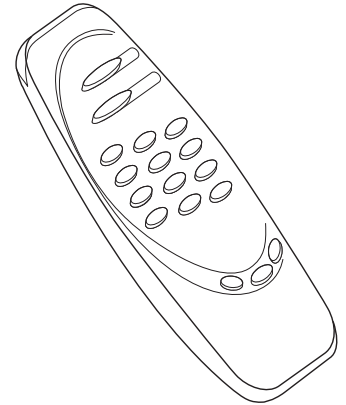

## ORDERING INFORMATION

Choose the boldface catalog nomenclature that best suits your needs and write it on the appropriate line. Order accessories as separate catalog number.

Example: **SYWR HHP**

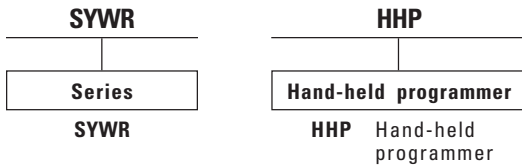

# SYWR HHP Lighting Control System, Hand-Held Programmer

## SPECIFICATIONS

POWER: Four AAA Alkaline batteries supplied.  
 IR CONTROL RANGE: 25 feet (7.5m).  
 LED CONTROL ANGLE: +/- 30 degrees.  
 OPERATING TEMPERATURE: -0 to 50°C.

## DIMENSIONS

All dimensions are centimeters.

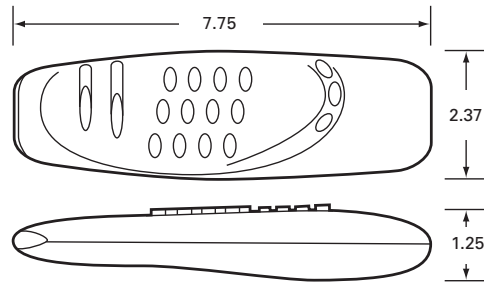

## FUNCTIONAL

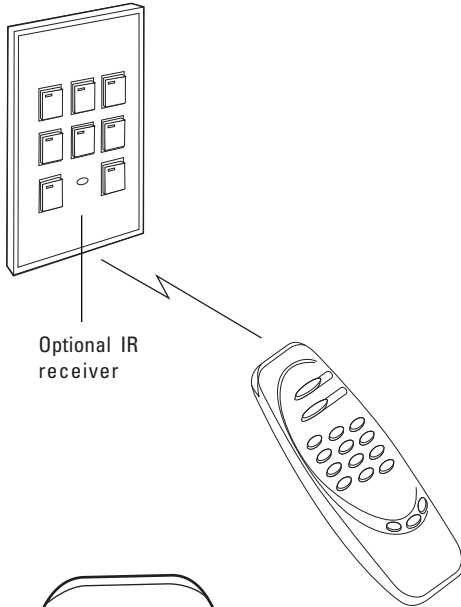

Optional IR receiver

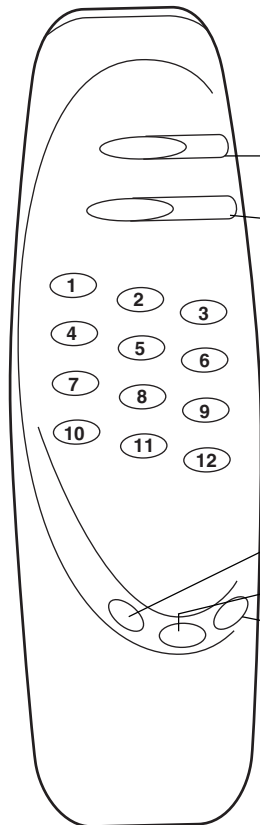

### PLAYBACK FUNCTIONS

- On/Raise** *Press and release to turn ON lighting, press and hold to raise the level of dimmed channels associated with the station.*
- Off/Lower** *Press and release to turn OFF lighting, press and hold to lower the level of dimmed channels associated with the station.*
- Preset** *Press and release to activate the preset scene associated with the button.*
- Channel** *Press and release, then select channels for manual raise/lower operation.*

### SAVING PRESETS

- Channel** *Press and release the channel button, then select channel or channels 1-12 for raise/lower operation using the raise/lower buttons.*
- Fade** *Press and release to set the fade time for a preset. Available fade times are 0, 5, 10, 15, 30, 45, 60 seconds and 5, 10, 30, 60 minutes. Press and hold until the beep to save the fade time.*
- Preset** *Press and release the preset button, then choose the preset number 1-12 to save. Press and hold the preset button until the beep to save the preset.*



An AcuityBrands Company