



# HT 2'x4' Static T8 Troffer

## MOUNTING DATA

Continuous row mounting of flanged units requires CRE and CRM trim options (see Options).

## DIMENSIONS

All dimensions are inches (millimeters). Specifications subject to change without notice.

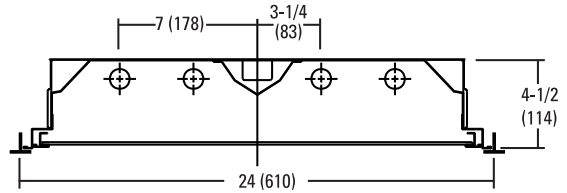
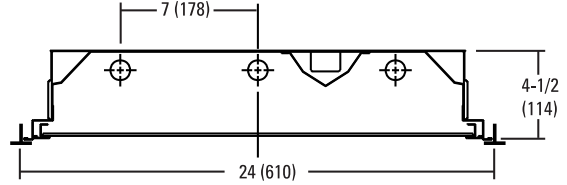
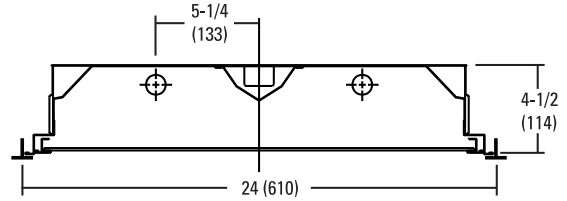
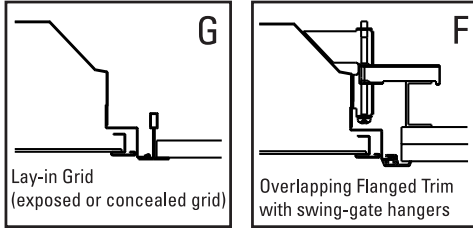

### NOTES:

- 1 Recommended rough-in dimensions for F trim fixtures 24" x 48" (Tolerance is +1/4", -0"). Swing-gate range 1-5/8" to 3-3/4". Swing-gate span 23-3/8" to 26-11/16".

## PHOTOMETRICS

Calculated using the zonal cavity method in accordance with IESNA LM41 procedure. Floor reflectances are 20%. Lamp configurations shown are typical. Full photometric data on these and other configurations available upon request.

### HT 3 32 A 12125

Report: **LTL13408**

LUMENS PER LAMP: **2850**

Luminaire Efficiency: 81.5%

### HT 3 32 A 12

Report: **LTL13410**

LUMENS PER LAMP: **2850**

Luminaire Efficiency: 81.9%

### HT 3 32 A 19

Report: **LTL13472**

LUMENS PER LAMP: **2850**

Luminaire Efficiency: 76.9%

| ROF | Coefficients of Utilization |     |     |     |     |     |     |     |     |     |
|-----|-----------------------------|-----|-----|-----|-----|-----|-----|-----|-----|-----|
|     | pc                          | 80% |     |     | 20% |     |     | 30% |     |     |
|     | pw                          | 70% | 50% | 30% | 50% | 30% | 10% | 50% | 30% | 10% |
| 0   | 97                          | 97  | 97  | 91  | 91  | 91  | 87  | 87  | 87  |     |
| 1   | 89                          | 86  | 83  | 80  | 78  | 76  | 77  | 75  | 74  |     |
| 2   | 82                          | 76  | 71  | 71  | 67  | 64  | 69  | 65  | 63  |     |
| 3   | 75                          | 67  | 61  | 64  | 59  | 55  | 61  | 57  | 54  |     |
| 4   | 69                          | 60  | 53  | 57  | 52  | 47  | 55  | 50  | 47  |     |
| 5   | 64                          | 54  | 47  | 51  | 46  | 41  | 50  | 45  | 41  |     |
| 6   | 59                          | 49  | 42  | 47  | 41  | 37  | 45  | 40  | 36  |     |
| 7   | 55                          | 45  | 38  | 43  | 37  | 33  | 42  | 36  | 32  |     |
| 8   | 51                          | 41  | 34  | 39  | 33  | 29  | 38  | 33  | 29  |     |
| 9   | 48                          | 37  | 31  | 36  | 30  | 26  | 35  | 30  | 26  |     |
| 10  | 45                          | 35  | 28  | 33  | 28  | 24  | 33  | 28  | 24  |     |

| ROF | Coefficients of Utilization |     |     |     |     |     |     |     |     |     |
|-----|-----------------------------|-----|-----|-----|-----|-----|-----|-----|-----|-----|
|     | pc                          | 80% |     |     | 20% |     |     | 30% |     |     |
|     | pw                          | 70% | 50% | 30% | 50% | 30% | 10% | 50% | 30% | 10% |
| 0   | 98                          | 98  | 98  | 91  | 91  | 91  | 87  | 87  | 87  |     |
| 1   | 90                          | 86  | 83  | 81  | 78  | 76  | 78  | 76  | 74  |     |
| 2   | 82                          | 76  | 71  | 72  | 68  | 64  | 69  | 66  | 63  |     |
| 3   | 76                          | 67  | 61  | 64  | 59  | 55  | 62  | 57  | 54  |     |
| 4   | 70                          | 60  | 53  | 57  | 52  | 47  | 55  | 51  | 47  |     |
| 5   | 64                          | 54  | 47  | 52  | 46  | 41  | 50  | 45  | 41  |     |
| 6   | 59                          | 49  | 42  | 47  | 41  | 37  | 45  | 40  | 36  |     |
| 7   | 55                          | 45  | 38  | 43  | 37  | 33  | 42  | 36  | 32  |     |
| 8   | 52                          | 41  | 34  | 39  | 33  | 29  | 38  | 33  | 29  |     |
| 9   | 48                          | 38  | 31  | 36  | 30  | 26  | 35  | 30  | 26  |     |
| 10  | 45                          | 35  | 28  | 33  | 28  | 24  | 33  | 28  | 24  |     |

| ROF | Coefficients of Utilization |     |     |     |     |     |     |     |     |     |
|-----|-----------------------------|-----|-----|-----|-----|-----|-----|-----|-----|-----|
|     | pc                          | 80% |     |     | 20% |     |     | 30% |     |     |
|     | pw                          | 70% | 50% | 30% | 50% | 30% | 10% | 50% | 30% | 10% |
| 0   | 92                          | 92  | 92  | 85  | 85  | 85  | 82  | 82  | 82  |     |
| 1   | 85                          | 82  | 79  | 77  | 75  | 73  | 74  | 73  | 71  |     |
| 2   | 79                          | 73  | 69  | 69  | 66  | 63  | 67  | 64  | 62  |     |
| 3   | 73                          | 66  | 61  | 63  | 58  | 55  | 60  | 57  | 54  |     |
| 4   | 67                          | 59  | 54  | 57  | 52  | 48  | 55  | 51  | 47  |     |
| 5   | 63                          | 54  | 48  | 51  | 46  | 43  | 50  | 46  | 42  |     |
| 6   | 58                          | 49  | 43  | 47  | 42  | 38  | 46  | 41  | 38  |     |
| 7   | 54                          | 45  | 39  | 43  | 38  | 34  | 42  | 37  | 34  |     |
| 8   | 51                          | 41  | 35  | 40  | 34  | 31  | 39  | 34  | 31  |     |
| 9   | 47                          | 38  | 32  | 37  | 32  | 28  | 36  | 31  | 28  |     |
| 10  | 45                          | 35  | 29  | 34  | 29  | 26  | 33  | 29  | 25  |     |

| Zonal Lumen Summary |        |        |           |
|---------------------|--------|--------|-----------|
| Zone                | Lumens | % Lamp | % Fixture |
| 0° - 30°            | 2217   | 25.9   | 31.8      |
| 0° - 40°            | 3626   | 42.4   | 52.0      |
| 0° - 60°            | 5947   | 69.6   | 85.4      |
| 0° - 90°            | 6968   | 81.5   | 100.0     |
| 90° - 180°          | 0      | 0.0    | 0.0       |
| 0° - 180°           | 6968   | 81.5   | 100.0     |

| Zonal Lumen Summary |        |        |           |
|---------------------|--------|--------|-----------|
| Zone                | Lumens | % Lamp | % Fixture |
| 0° - 30°            | 2219   | 25.9   | 31.7      |
| 0° - 40°            | 3621   | 42.3   | 51.7      |
| 0° - 60°            | 5944   | 69.5   | 84.9      |
| 0° - 90°            | 7005   | 81.9   | 100.0     |
| 90° - 180°          | 0      | 0.0    | 0.0       |
| 0° - 180°           | 7005   | 81.9   | 100.0     |

| Zonal Lumen Summary |        |        |           |
|---------------------|--------|--------|-----------|
| Zone                | Lumens | % Lamp | % Fixture |
| 0° - 30°            | 2413   | 28.2   | 36.7      |
| 0° - 40°            | 3949   | 46.2   | 60.0      |
| 0° - 60°            | 5947   | 69.6   | 90.4      |
| 0° - 90°            | 6578   | 76.9   | 100.0     |
| 90° - 180°          | 0      | 0.0    | 0.0       |
| 0° - 180°           | 6578   | 76.9   | 100.0     |