



HOLOPHANE®

FEATURES & SPECIFICATIONS

INTENDED USE — Specification premium air-handling luminaires with small-cell louver options to provide general illumination for every recessed application. Certain airborne contaminants can diminish integrity of acrylic. [Click here for Acrylic Environmental Compatibility table for suitable uses.](#)

CONSTRUCTION — Black reveal provides floating louver appearance, conceals optional air-supply slots. Anodized aluminum louvers available in multiple cell configurations and choice of finish. Spring-loaded latches are standard.

Air-flow control available with optional heat-removal dampers and air-pattern control blades.

Integral T-bar safety clips hold T-bar securely; no fasteners required to install.

Overlapping flange and modular ceiling trims are factory-installed with standard swing-gate hangers.

Housing formed from cold-rolled steel. Louvers formed from anodized aluminum. No asbestos is used in this product.

Finish: Five-stage iron-phosphate pretreatment ensures superior paint adhesion and rust resistance. Painted parts finished with high-gloss, baked white enamel.

ELECTRICAL — Thermally-protected, resetting, Class P, HPF, non-PCB, UL Listed, CSA certified ballast is standard. Energy saving and electronic ballasts are sound rated A.

Luminaire is suitable for damp locations. AWM, TFN or THHN wire used throughout, rated for required temperatures.

LISTING — UL Listed (standard). Optional: Canada CSA or C-UL. Mexico NOM.

WARRANTY — Guaranteed for one year against mechanical defects in manufacture.

NOTE: Specifications subject to change without notice.

Catalog Number
Notes
Type

Specification Premium Louvered Troffer

HT AIR 1'X4'

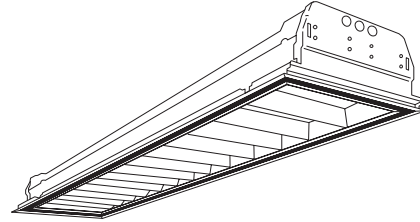

SMALL-CELL LOUVERS
1, 2 or 3 Lamps

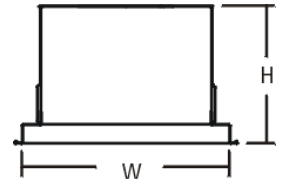

Specifications

Length: 48 (1219)

Width: 12 (305)

Depth: 4-7/8 (124)

Weight: 22 lbs (10 kg)

All dimensions are inches (millimeters).

ORDERING INFORMATION

For shortest lead times, configure product using standard options (shown in bold).

Example: HT14A G 2 32 3915LD MVOLT GEB10IS

HT14A				32							
Series	Trim type	Number of lamps	Lamp type	Louver/Finish		Voltage	Options				
HT14A Recessed troffer, 1'x4', air handling	G Grid	1	32 32W T8 (48")	1315	13-cell louver, 1-1/2" deep	LD	Low-iridescent, diffuse silver	120	1/3	One three-lamp ballast	
	F Overlapping flanged	2		2615	26-cell louver, 1-1/2" deep			LS	Low-iridescent, specular silver	277	GEB10IS
		3		3915	39-cell louver, 1-1/2" deep	347	GEB10RS			Electronic ballast, rapid start, ≤10% THD	
		Not included.		4515	45-cell louver, 1-1/2" deep	MVOLT	Others available.			EL	Emergency battery pack (nominal 300 lumens)
				18675	186-cell louver, 3/4" deep					GLR	Internal fast-blow fuse ¹
						GMF	Internal slow-blow fuse ¹				
						PWS1836	6' prewire, 3/8" dia., 18-gauge, 1 circuit				
						LP735	Lamped, 700-series, 3500K				
						HRD	Heat-removal dampers				
						APB	Air-pattern control blades				
						PAF	Painted after fabrication (white enamel)				
						SSR	Specular silver interior finish (95% reflectance)				
						CSA	CSA Certified				
						NOM	NOM Certified				

Notes

1 Must specify voltage.

HT Air 1'x4' Small-Cell Louvers

MOUNTING DATA

Continuous row mounting of flanged units requires CRE and CRM trim options (see Options).

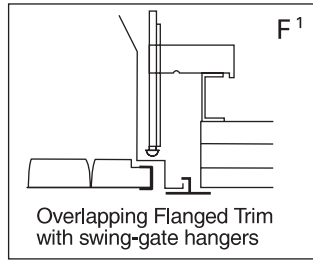
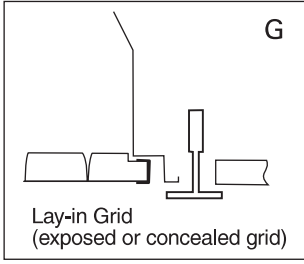

DIMENSIONS

All dimensions are inches (millimeters). Specifications subject to change without notice.

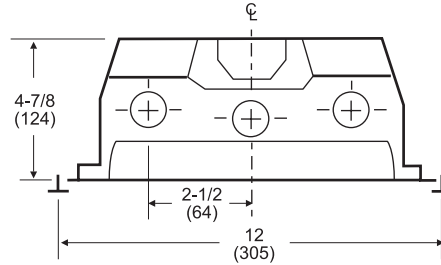
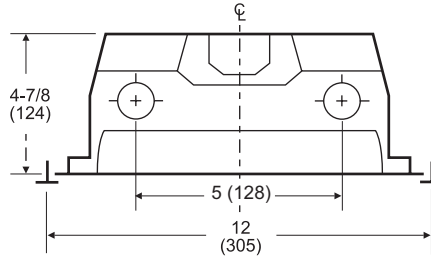

NOTES:

- 1 Recommended rough-in dimensions for F trim fixtures 12"x48" (Tolerance is +1/4", -0"). Swing-gate range 1-1/16" to 3-11/16", span 10-3/4" to 14-3/4".
- 2 ST trim increases fixture depth.

HT G B 2 40 2615LD

Report LTL 4624

S/MH (along) 1.3 (across) 1.3

Coefficient of Utilization

Ceiling	80%			70%			50%		
	70%	50%	30%	70%	50%	30%	50%	30%	10%
1	57	55	54	56	54	53	52	51	50
2	53	50	47	52	49	46	47	45	43
3	49	45	41	48	44	41	43	40	38
4	45	40	36	44	39	36	38	35	33
5	42	36	32	41	35	31	34	31	28
6	38	32	28	37	32	28	31	27	25
7	35	29	25	35	29	25	28	24	22
8	33	26	22	32	26	22	25	21	19
9	30	23	19	29	23	19	23	19	16
10	28	21	17	27	21	17	21	17	15

Zonal Lumens Summary

Zone	Lumens	%Lamp	%Fixture
0-30	1074	17.0	33.1
0-40	1740	27.6	53.7
0-60	2872	45.6	88.6
0-90	3242	51.5	100.0
90-180	0	0.0	0.0
0-180	3242	51.5	100.0

